

SHARP
Be Original.

Simply Better Living

Wi-Fi CONNECT GUIDE

SMART DISHWASHER
MODEL SDW6767HS



Alexa, start the dishwasher.

HOW TO CONNECT AND PAIR YOUR APPLIANCE TO THE SHARP KITCHEN APP

1. GETTING STARTED

- Download the **Amazon Alexa** App on the App Store®.



- Launch the Amazon Alexa App and sign in or create an account.
*If you already have an Amazon account, enter credentials and select **(SIGN IN)**.
- For the best user experience, we recommend an Amazon Echo or other Alexa-Enabled Device to Allow Voice Control be set up on the same smart home network as the SDW6767HS. Amazon Echo and Other Alexa-Enabled Devices Sold Separately.

Please make sure your mobile device is connected to the same network that you will use to connect your dishwasher to the internet and please make sure your Echo device is placed near the dishwasher for the pairing process.

THREE WAYS TO PAIR YOUR DEVICE

In order to begin the process of connecting your **Sharp Smart Dishwasher** to the internet please make sure you've downloaded the Alexa App onto your mobile device, have created an account, and that the Alexa App is connected to your Echo device.



BARCODE SETUP
Page 3

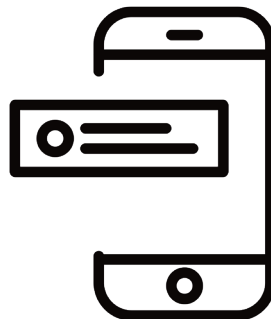

SETUP WITHOUT BARCODE
Page 6



ZERO TOUCH SETUP
Page 8

2. BEFORE YOU BEGIN

In order to pair, all prerequisites listed below must be met for each pairing method:

- The dishwasher will need to be within the Wi-Fi range of the user's Wi-Fi network.
- The dishwasher will need to be within the wireless range of the Amazon Alexa App, or an Echo family device, which was signed into the same Amazon account.

Zero Touch Setup - additional prerequisite

- The dishwasher must have been ordered from the same Amazon account and while ordering you must have opted to link the device upon purchase. If the dishwasher was received as a gift, or the user de-selected this option upon purchase, the dishwasher will not be linked to the end user's Amazon/Alexa account and Zero Touch Setup will not be enabled. Please pair with the first or second pairing methods.

3. PAIRING YOUR APPLIANCE

- After signing up your account, follow the instructions below to connect your Smart Dishwasher to the internet, then pair your app to your appliance.

METHOD 1: BARCODE SETUP

1. First Download the Amazon Alexa App.
2. Plug in your Dishwasher, open the door, and press and hold Power from 3 seconds, to power on the Dishwasher.
3. On your Dishwasher press buttons "Rinse Only" + "Hi Temp Wash" simultaneously for 5 seconds until the display reads "FR".



4. Open the Amazon Alexa App. Select the “Devices” tab on the bottom right corner.
5. At the top right corner, Select the “+” button ➤ “Add a Device”.

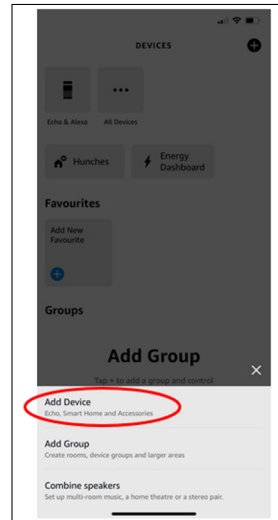
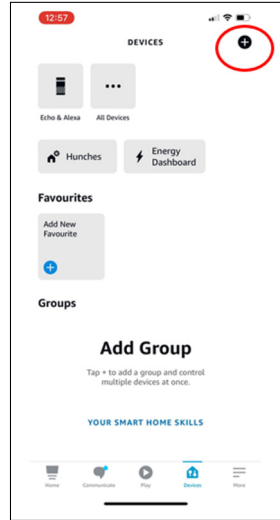
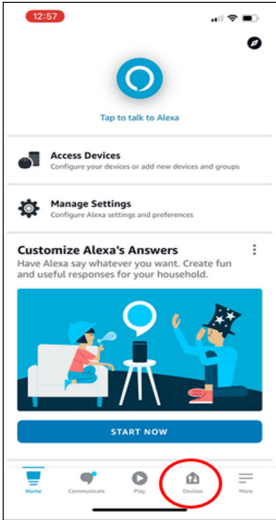

6. You will be brought to the device set up page. Scroll or Search until you find “Dishwasher”.
7. Select “Dishwasher” ➤ “Sharp” ➤ “Next” and allow access to your Camera.

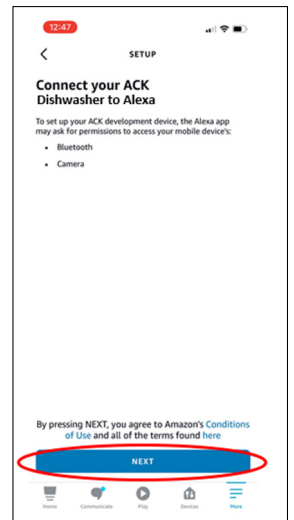
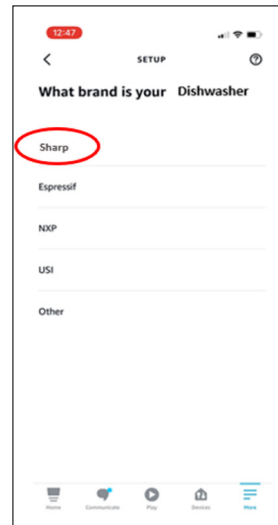
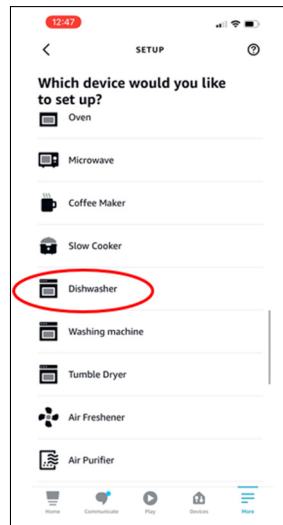
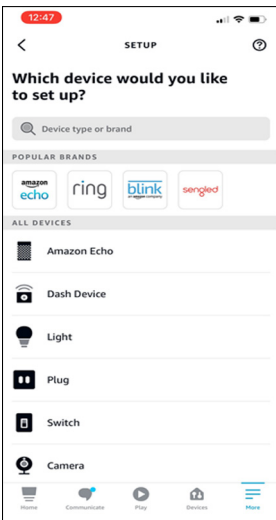

8. Line up the barcode located on the inner part on the right side of the door, with the box on the App screen. Once lined up, the Alexa App can successfully scan the barcode.
9. The Alexa App will search for your device. Select “Scan Barcode”.

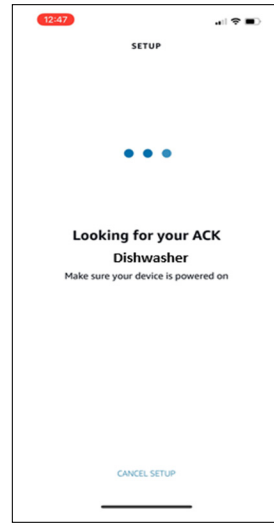
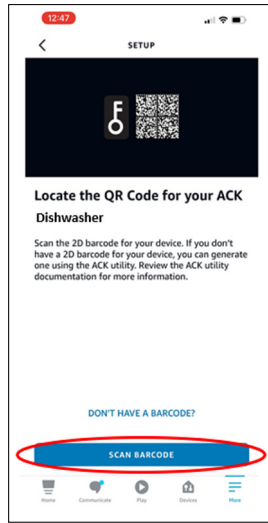

10. The Alexa App will connect to your device.

11. The Alexa App will connect your device to your Wi-Fi. A notification will pop up when your device is found. You will be connected and automatically brought to the ACK dishwasher connected page. Select "Done".

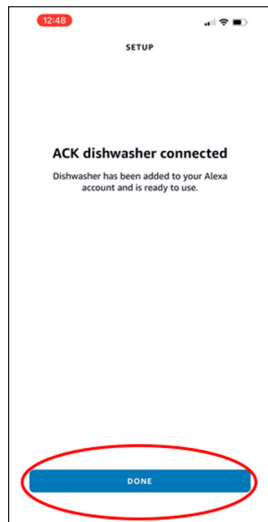
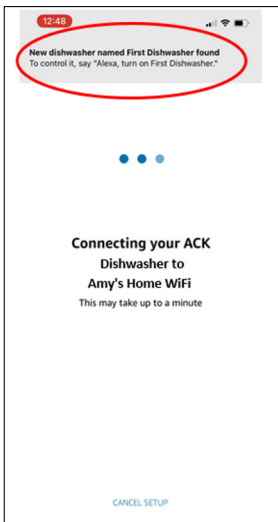

12. Proceed to Page 10 to Start Using Application.

METHOD 2: SETUP WITHOUT BARCODE

Please follow these steps to pair your appliance without a barcode:

1. First Download the Amazon Alexa App. Plug in your Dishwasher, open the door, and press and hold Power for 3 seconds, to power on the Dishwasher.
2. Press buttons "Rinse Only" + "Wash Zone" simultaneously for 5 seconds until the display reads "UG".

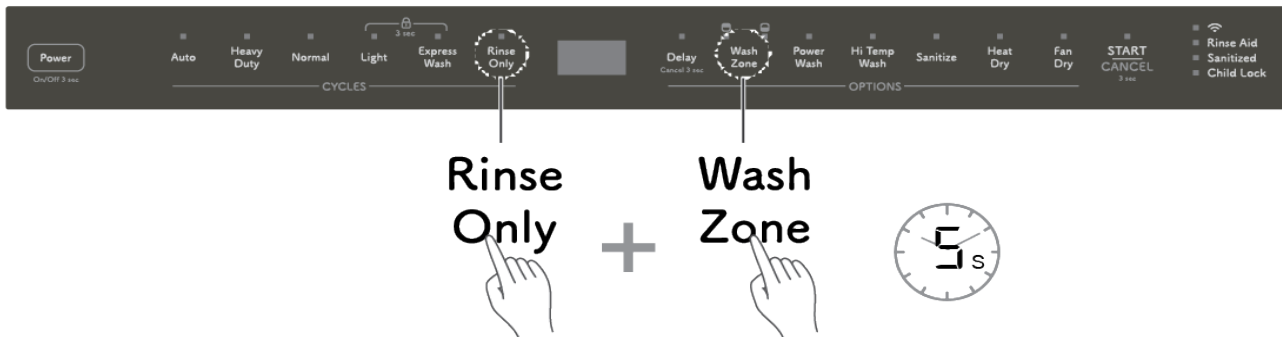

3. Open the Amazon Alexa App. Select the "Devices" tab on the bottom right corner.
4. At the top right corner, Select the "+" button > "Add a Device".

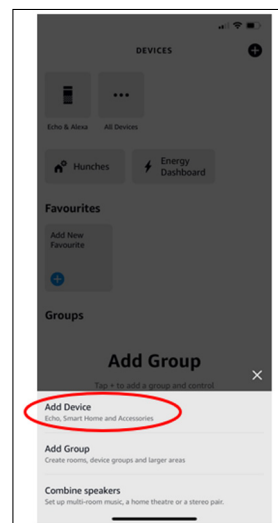
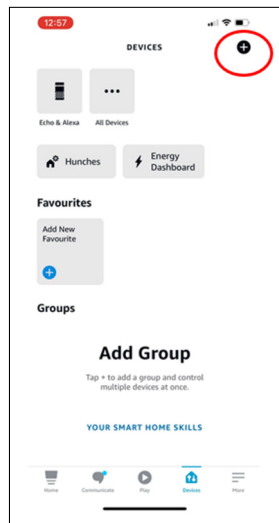
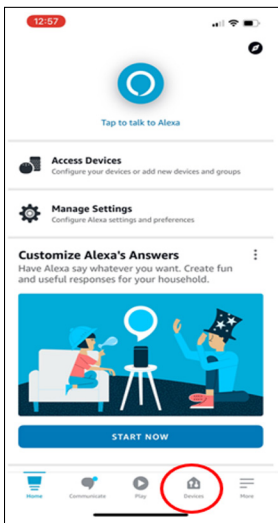

5. You will be brought to the device set up page. Scroll or Search until you find "Dishwasher".
6. Select "Dishwasher" > "Sharp" > "Next" > "Don't Have A Barcode?" > "Next".

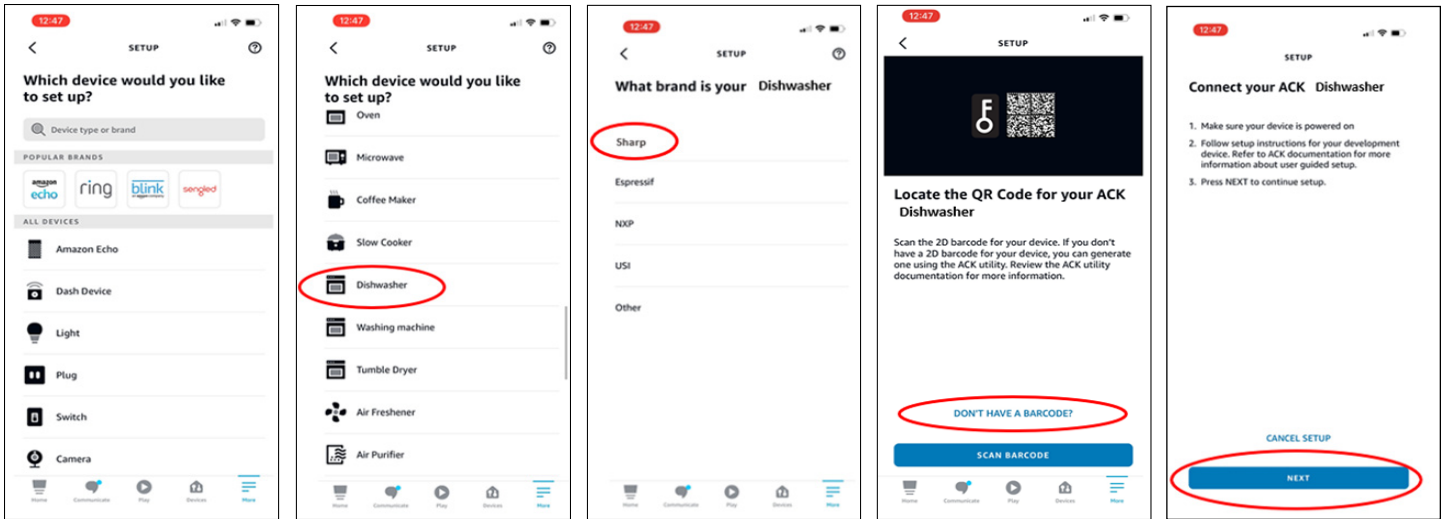

7. The Alexa App will search for your device.
8. A pop up will appear to select a Wi-Fi network. Select the same network your phone is connected to.

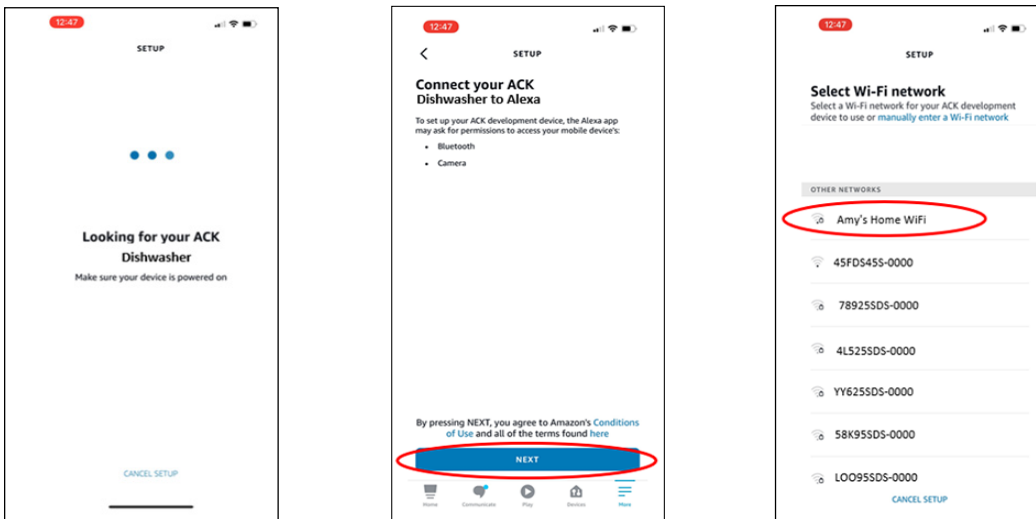

9. The Alexa App will connect your device to your Wi-Fi.
10. A notification will pop up when your device is found.
11. You will be connected and automatically brought to the ACK dishwasher connected page. Select "Done".

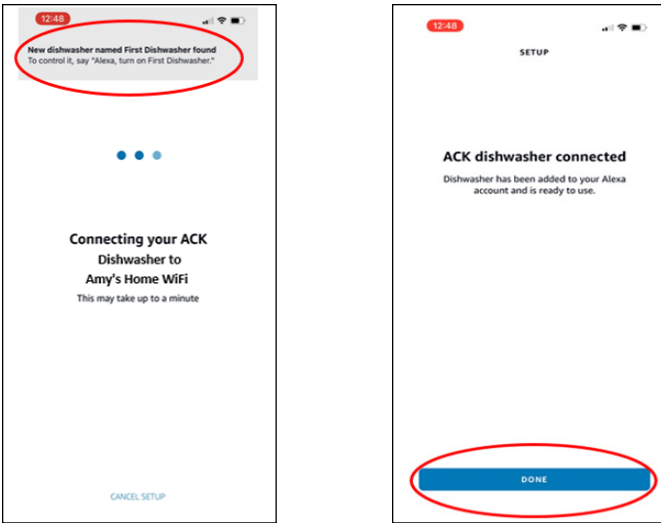

12. Proceed to Page 10 to Start Using Application.

METHOD 3: ZERO TOUCH SETUP

Works ONLY if dishwasher was purchased through Amazon, and Zero Touch Setup was applied during checkout.

Please follow these steps to pair your appliance without a barcode:

1. First Download the Amazon Alexa App or use an active 2nd Gen or higher Echo Dot.
2. Once dishwasher is installed Press "Rinse Only" + "Start/Cancel" simultaneously for 5 seconds to start the network control. The Wi-Fi indicator will stop flashing and remain lit, which means your device is paired successfully.

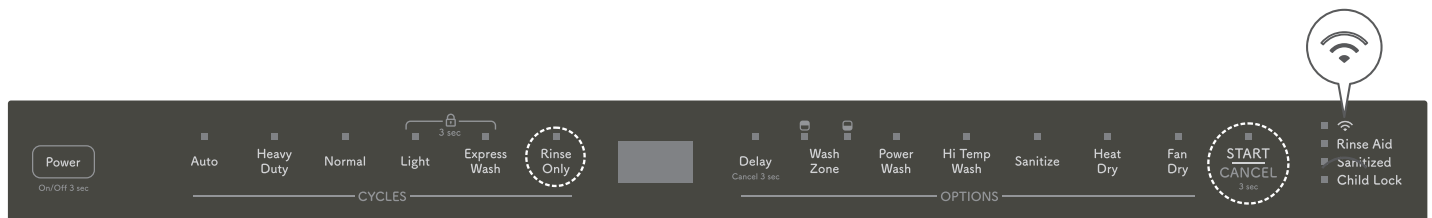

Rinse
Only

+

START
CANCEL



3. If pairing with the Alexa App you will receive this popup on your mobile phone once your device is paired.

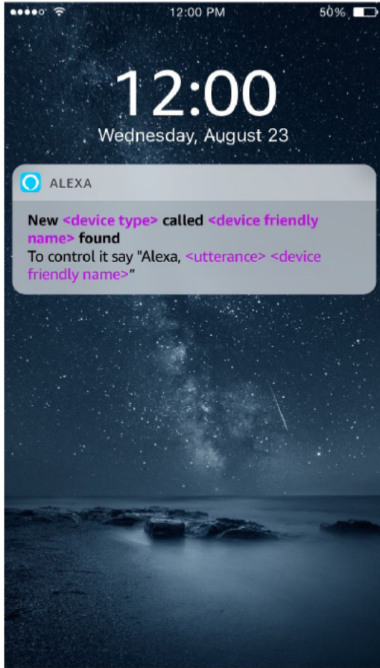

4. If pairing with an Echo Dot:
 - First your new dishwasher signal is read by your nearby Echo Dot.
 - Second, the Echo Dot makes a connection with the cloud.
 - Third, the cloud authorizes and authenticates your device, and connects your device to Amazon.
 - Fourth, the Echo Dot communicates the authorization back to your dishwasher.
 - Fifth, the dishwasher connects to your network and account.
 - Lastly, your device is connected and ready to use.
5. Proceed to Page 10 to Start Using Application.

4. START USING APPLICATION

- To start the network control, touch and hold Rinse Only and START/CANCEL together for 5 seconds until the Wi-Fi indicator stops flashing and remains lit.

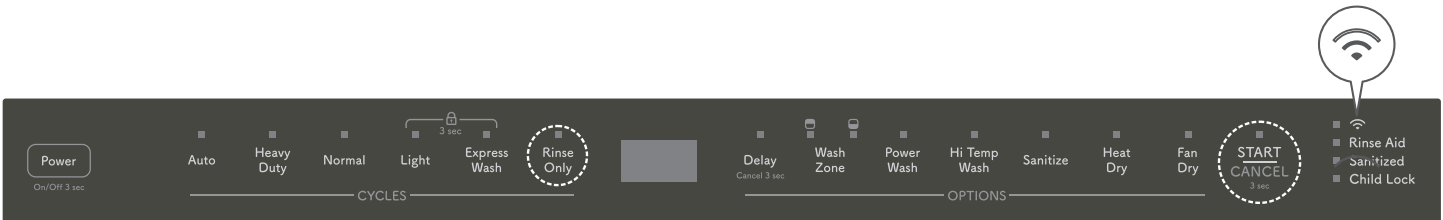

Rinse
Only

+

START
CANCEL



- Select First Dishwasher. You can now access your device through the “Devices” Tab. Select “All Devices” to access your Dishwasher.
- You can change the name from “First Dishwasher” to “Dishwasher” in the Devices tab by selecting the Settings icon in the top right corner, and then selecting Edit Name.
- You can now control your dishwasher via the Alexa App or manually on the dishwasher control panel.

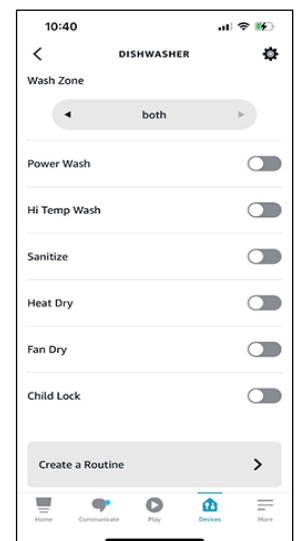
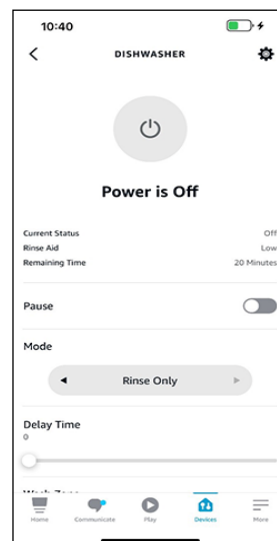
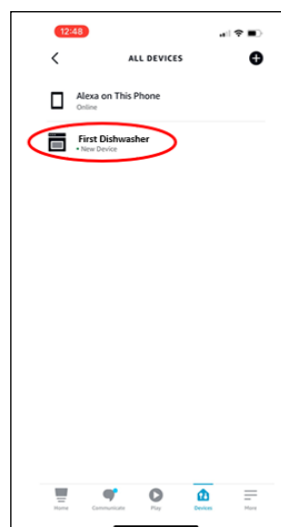
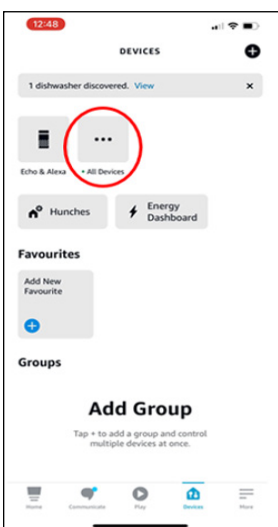

ALEXA COMMAND LIST

With the Amazon Alexa App and an Echo device, you can change operation modes with simple voice commands.

ACTION	COMMANDS	ACTION	COMMANDS
Power On	Alexa, Start The Dishwasher Alexa, Turn On Dishwasher Alexa, Turn Off Dishwasher	Pause	Alexa, Enable Pause On Dishwasher Alexa, Activate Pause On Dishwasher Alexa, Start Pause On Dishwasher Alexa, Turn On Pause On Dishwasher
Pause	Alexa, Disable Pause On My Dishwasher Alexa, Deactivate Pause On My Dishwasher Alexa, Stop Pause On My Dishwasher Alexa, Turn Off Pause On My Dishwasher	Auto	Alexa, Set Dishwasher Cycle To Auto Alexa, Set Dishwasher Mode To Auto Alexa, Set Dishwasher Program To Auto Alexa, Set Dishwasher Operation Mode To Auto
Heavy Duty	Alexa, Set Dishwasher Cycle To Heavy Duty Alexa, Set Dishwasher Mode To Heavy Duty Alexa, Set Dishwasher Program To Heavy Duty Alexa, Set Dishwasher Operation Mode To Heavy Duty	Normal	Alexa, Set Dishwasher Cycle To Normal Alexa, Set Dishwasher Mode To Normal Alexa, Set Dishwasher Program To Normal Alexa, Set Dishwasher Operation Mode To Normal
Light	Alexa, Set Dishwasher Cycle To Light Alexa, Set Dishwasher Mode To Light Alexa, Set Dishwasher Program To Light Alexa, Set Dishwasher Operation Mode To Light	Express Wash	Alexa, Set Dishwasher Cycle To Express Wash Alexa, Set Dishwasher Mode To Express Wash Alexa, Set Dishwasher Program To Express Wash Alexa, Set Dishwasher Operation Mode To Express Wash
Rinse	Alexa, Set Dishwasher Cycle To Rinse Only Alexa, Set Dishwasher Mode To Rinse Only Alexa, Set Dishwasher Program To Rinse Only Alexa, Set Dishwasher Operation Mode To Rinse Only	Cycle/ Mode	Alexa, What Is The Dishwasher Cycle? Alexa, What Is The Dishwasher Mode?
Wash Zone	Alexa, Set Wash Zone To Upper Alexa, Set Wash Zone To Lower Alexa, Set Wash Zone To Both Alexa, Is Wash Zone Off On Dishwasher?	Fan Dry	Alexa, Engage Fan Dry Alexa, Enable Fan Dry Alexa, Turn On Fan Dry Alexa, Turn Off Fan Dry Alexa, Is Fan Dry Off On Dishwasher?
Power Wash	Alexa, Engage Power Wash Alexa, Enable Power Wash Alexa, Turn On Power Wash Alexa, Turn Off Power Wash Alexa, Is Power Wash Off On Dishwasher?	Sanitize	Alexa, Engage Sanitize Alexa, Enable Sanitize Alexa, Turn On Sanitize Alexa, Turn Off Sanitize Alexa, Is Sanitize Off On Dishwasher?
Heat Dry	Alexa, Engage Heat Dry Alexa, Enable Heat Dry Alexa, Turn On Heat Dry Alexa, Turn Off Heat Dry Alexa, Is Heat Dry Off On Dishwasher?	Child Lock	Alexa, Engage Child Lock Alexa, Enable Child Lock Alexa, Turn On Child Lock Alexa, Turn Off Child Lock Alexa, Is Child Lock Off On Dishwasher?
Status	Alexa, What Is The Status On The Dishwasher? Alexa, What Is The Status In The Dishwasher? Alexa, What Is The Dishwasher Remaining Time?	Rinse Aid	Is Rinse Aid Low On Dishwasher? What Is Rinse Aid Status On Dishwasher?
High Temp Wash	Alexa, Engage High Temp Wash Alexa, Enable High Temp Wash Alexa, Turn On High Temp Wash Alexa, Turn Off High Temp Wash Alexa, Is High Temp Wash Off On Dishwasher?	Delay	Alexa, Set Delay To X Hours Alexa, Set Delay Start To X Hours Alexa, What Is Dishwasher Delay Time Set To?

(COMMANDS ARE SUBJECT TO CHANGE)

TROUBLESHOOTING

Will this dishwasher oven connect to a 5ghz wireless network?

No, the dishwasher oven will only connect to a 2.4ghz wireless network.

I cannot connect my device to the dishwasher.

Please confirm the following before you begin to setup:

- Make sure you have downloaded the Alexa App onto your mobile device and have created an account.
- Make sure your mobile device is connected to the same network that you will use to connect your dishwasher to the internet.

My dishwasher oven was working with Alexa and now it does not.

- Make sure the dishwasher's Wi-Fi is on. The Wi-Fi icon will appear continuously lit when it is on and connected.
- If the Wi-Fi icon is blinking, touch and hold Rinse Only and START/CANCEL together for 5 seconds to start the network control.

The Wi-Fi icon on the dishwasher oven display is blinking.

Check your internet status or your home network equipment status. Your router or modem could be resetting itself.

How many Alexa accounts can be paired to the dishwasher?

One Alexa account can be paired to the dishwasher.

STILL NEED ASSISTANCE?



EMAIL
Available 24/7
US: sharpusa.com



CHAT ONLINE
Mon-Fri: 7am-7pm CST
Sat-Sun: 9am-7pm CST



CALL US
US **800-BE-SHARP**
800-237-4277
Mon-Fri: 7am-7pm CST
Sat-Sun: 9am-7pm CST

See the Contact Us section on our website

U.S. | www.sharpusa.com/support

Contact a Sharp Advisor on the phone

Simply Better Living

At Sharp Home Electronics Company of America, we are committed to Simply Better Living.

Our innovative home appliances are simple to use, better than the competition and encourage a healthy lifestyle. Our Simply Better Living Blog is dedicated to simple, creative solutions for living your best life. Every day we share tips, recipes, life-hacks and articles with our readers along with a weekly newsletter of the latest stories you don't want to miss. It's all about the food you eat and the air you breathe. Welcome home.

<http://sbl.sharppusa.com> or <http://simplybetterliving.sharppusa.com>

Scan the QR code below to sign up to receive the weekly Simply Better Living newsletter.



FOLLOW @SHARPHOMEUSA



SHARP
Be Original.

Simply Better Living

SHARP ELECTRONICS CORPORATION
100 Paragon Drive, Montvale NJ, 07645
1.800.237.4277 • www.shop.sharppusa.com

© 2022 Sharp Electronics Corporation. All rights reserved.

Amazon, Alexa and all related logos are trademarks of Amazon.com, Inc. and its affiliates

Apple and iPhone are trademarks of Apple Inc., registered in the U.S. and other countries.

Google Play and the Google Play logo are trademarks of Google LLC. Android is a trademark of Google LLC.