

SHARP®

FP-K50U



HIGH-DENSITY 7000*

"Plasmacluster" and "Device of a cluster of grapes" are registered trademarks of Sharp Corporation in Japan, USA and elsewhere.

* The number in this technology mark indicates an approximate number of ions supplied into air of 1 cm³, which is measured around the center of a room applicable floor area (at 1.2 m height above the floor) when the product is placed close to a wall and operating on MED mode.

* Le nombre de cette marque technologique indique le nombre approximatif d'ions produits dans 1 cm³ d'air, lesquels sont mesurés autour du centre de la surface de plancher applicable (à 1,2 m au-dessus du sol) lorsque le produit est placé à proximité d'un mur et fonctionne en mode MED.

* El número en esta marca de tecnología indica un número de iones aproximado suministrado al aire de 1 cm³, que se mide alrededor del centro del área de suelo aplicable de una habitación (a 1.2 m de altura por encima del suelo) cuando el producto se coloca cerca de una pared y funciona en modo MED.

AIR PURIFIER OPERATION MANUAL

Purificateur d'air à fonction MANUEL D'UTILISATION

PURIFICADOR DE AIRE MANUAL DE OPERACIÓN

ENGLISH

FRANÇAIS

ESPAÑOL



This product earned the ENERGY STAR by meeting strict energy efficiency guidelines set by the US EPA. US EPA does not endorse any manufacturer claims of healthier indoor air from the use of this product.

The energy efficiency of this ENERGY STAR qualified model is measured based on a ratio between the model's CADR for Dust and the electrical energy it consumes, or CADR/Watt.

Ce produit a le droit de porter la marque ENERGY STAR après avoir répondu à des critères stricts en ce qui concerne l'efficacité énergétique, tels qu'établis par l'agence EPA aux É-U. L'agence EPA aux É-U n'appuie aucunement les témoignages publicitaires du fabricant indiquant que ce produit rend l'air intérieur des locaux plus sain.

L'efficacité énergétique de ce modèle, qui bénéficie de la reconnaissance ENERGY STAR, est mesurée par le rapport entre le DAP (débit d'air purifié) du modèle et l'énergie électrique qu'il consomme, soit le rapport DAP/Watt.

Este producto obtuvo la distinción ENERGY STAR cumpliendo directrices estrictas de eficiencia establecidas por US EPA. US EPA no respalda las reclamaciones de ningún fabricante sobre el aire interior más sano del uso de este producto.

La eficiencia energética de este modelo cualificado ENERGY STAR está medido basado en proporción entre el CADR para polvo del modelo y la energía que consume, o CADR/vatio.

ENGLISH

Please read before operating your new Air Purifier

The air purifier draws in room air through the air inlet, circulates it through a pre-filter, an Active carbon deodorizing filter and a True HEPA filter inside the main unit, and then discharges it through the air outlet. The True HEPA filter can remove 99.97% of dust particles as small as 0.3 microns that pass through the filter and also helps absorb odors. The Active carbon deodorizing filter gradually absorbs odors as they pass through the filter.

Some odors absorbed by the filters will break down over time, causing additional odors. Depending on usage conditions, and especially if the product is used in environments significantly more severe than a normal household, these odors may become noticeable sooner than expected. If these odors persist, replace the filters. (Page 11,15)

NOTE

- The air purifier is designed to remove air-suspended dust and odor, but not harmful gases (for example, carbon monoxide contained in cigarette smoke). If the source of the odor still exists, the air purifier may not completely remove the odor.

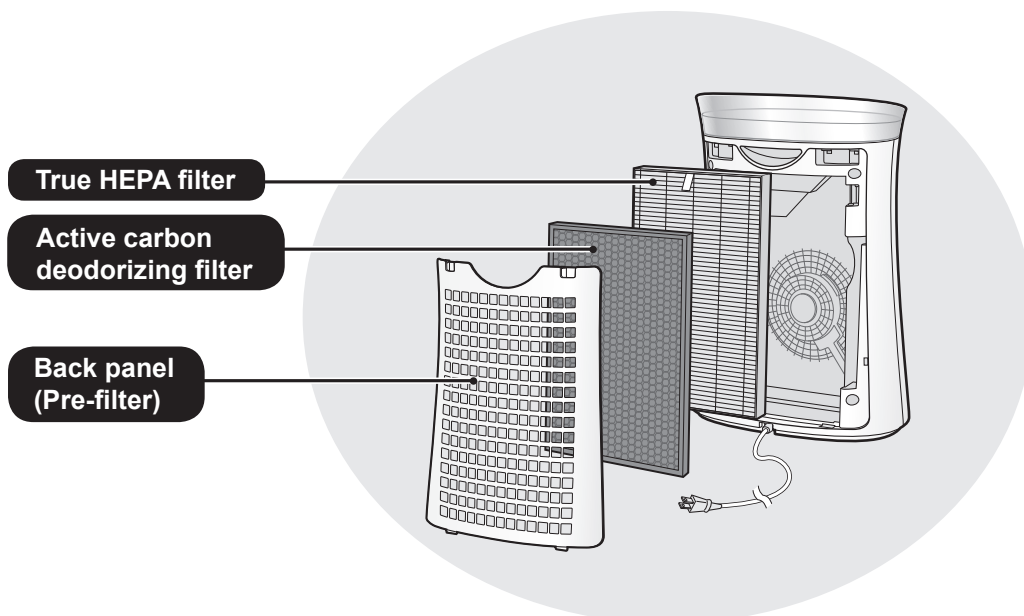

FEATURES

Unique Combination of Air Treatment Technologies Triple Filtration System + Plasmacluster Ion

TRAPS DUST*

Pre-filter traps dust and other large airborne particles.

DECREASES ODORS

Active carbon deodorizing filter absorbs many common household odors.

REDUCES POLLEN & MOLD*

True HEPA filter traps 99.97% of particles as small as 0.3 microns.

FRESHENS

Plasmacluster refreshes the air similar to the way nature cleans the environment by emitting a balance of positive and negative ions.

*When air is drawn through the filter system.

CONTENTS

FOR CUSTOMER ASSISTANCE (U.S).. EN-2

CONSUMER LIMITED WARRANTY (U.S).. EN-3

FOR CUSTOMER ASSISTANCE (CANADA) .. EN-4

CONSUMER LIMITED WARRANTY (CANADA).. EN-5

IMPORTANT SAFETY INSTRUCTIONS EN-6

PART NAMES.....EN-10

FILTER INSTALLATION EN-11

OPERATIONEN-12

CARE AND MAINTENANCE EN-14

TROUBLESHOOTINGEN-16

SPECIFICATIONS.....EN-17

Declaration of Conformity SHARP AIR PURIFIER FP-K50U
This device complies with Part 18 of FCC rules.

Responsible Party:
SHARP ELECTRONICS CORPORATION
100 Paragon Drive, Montvale, NJ 07645, U.S.A

Declaration of Conformity SHARP AIR PURIFIER FP-K50U
CAN ICES-1/NMB-1

Responsible Party:
SHARP ELECTRONICS OF CANADA LTD.
335 Britannia Road East Mississauga, Ontario L4Z 1W9 Canada
TEL: (905) 568-7140

Thank you for purchasing this SHARP Air Purifier. Please read this manual carefully before using the air purifier. After reading, keep the manual in a convenient location for future reference.

FOR CUSTOMER ASSISTANCE (the United States)

REGISTER YOUR PRODUCT

Registering your new product is easy and offers benefits that help you get the most out of your Sharp product including:

- Convenience:** If you ever need warranty support, your product information is already on file.
- Communication:** Stay up to date with important notifications and special offers from SHARP.
- Support:** Quickly access support content including Owners Manuals, FAQ's, How-to Videos, and much more.

3 EASY WAYS TO REGISTER TODAY!

	SCAN Use the camera or QR code scanning application on your smart phone		ONLINE Visit our sites to learn more about your product at sharpusa.com and sbl.sharpusa.com		CALL US US 800-BE-SHARP 800-237-4277 Mon-Fri: 7am-7pm CST Sat-Sun: 9am-7pm CST
Scan this QR Code on your smart phone	Visit http://www.sharpusa.com/register	Contact a Sharp Advisor on the phone			

PRODUCT SUPPORT



If you have questions about the setup or operation of your product, please refer to the corresponding section within this manual.

Additionally, visit www.sharpusa.com/support to access exclusive content about your product including:

- FAQ's and How-To Videos
- Find or Request Service
- Purchase an Extended Warranty
- Downloads including the Installation Guide, Spec Sheet, and Owner's Manual

CONTACT US

If at any time you have questions or comments concerning your SHARP product, please contact the SHARP Customer Assistance Center. We are available to assist you through multiple contact methods for your convenience:

	EMAIL Available 24/7 US: sharpusa.com		CHAT ONLINE Mon-Fri: 7am-7pm CST Sat-Sun: 9am-7pm CST		CALL US US 800-BE-SHARP 800-237-4277 Mon-Fri: 7am-7pm CST Sat-Sun: 9am-7pm CST
See the Contact Us section on our sites	U.S. www.sharpusa.com/support	Contact a Sharp Advisor on the phone			

CONSUMER LIMITED WARRANTY (the United States)

ENGLISH

CONSUMER LIMITED WARRANTY FOR U.S. USERS

SHARP ELECTRONICS CORPORATION warrants to the first consumer purchaser that this Sharp brand product (the "Product"), when shipped in its original container, will be free from defective workmanship and materials, and agrees that it will, at its option, either repair the defect or replace the defective Product or part thereof with a new or remanufactured equivalent at no charge to the purchaser for parts or labor for the period(s) set forth below.

This warranty does not apply to any appearance items of the Product nor to the additional excluded item(s) set forth below nor to any Product the exterior of which has been damaged or defaced, which has been subjected to improper voltage or other misuse, abnormal service or handling, or which has been altered or modified in design or construction.

In order to enforce the rights under this limited warranty, the purchaser should follow the steps set forth below and provide proof of purchase to the servicer.

The limited warranty described herein is in addition to whatever implied warranties may be granted to purchasers by law. ALL IMPLIED WARRANTIES INCLUDING THE WARRANTIES OF MERCHANTABILITY AND FITNESS FOR USE ARE LIMITED TO THE PERIOD(S) FROM THE DATE OF PURCHASE SET FORTH BELOW. Some states do not allow limitations on how long an implied warranty lasts, so the above limitation may not apply to you.

Neither the sales personnel of the seller nor any other person is authorized to make any warranties other than those described herein, or to extend the duration of any warranties beyond the time period described herein on behalf of Sharp.

The warranties described herein shall be the sole and exclusive warranties granted by Sharp and shall be the sole and exclusive remedy available to the purchaser. Correction of defects, in the manner and for the period of time described herein, shall constitute complete fulfillment of all liabilities and responsibilities of Sharp to the purchaser with respect to the Product, and shall constitute full satisfaction of all claims, whether based on contract, negligence, strict liability or otherwise. In no event shall Sharp be liable, or in any way responsible, for any damages or defects in the Product which were caused by repairs or attempted repairs performed by anyone other than an authorized servicer. Nor shall Sharp be liable or in any way responsible for any incidental or consequential economic or property damage. Some states do not allow the exclusion of incidental or consequential damages, so the above exclusion may not apply to you.

THIS LIMITED WARRANTY IS VALID ONLY IN THE FIFTY (50) UNITED STATES, THE DISTRICT OF COLUMBIA AND PUERTO RICO.

Your Product Model Number & Description:

FP-K50U Air Purifier. Be sure to have this information available when you need service for your Product.

Warranty Period for this Product:

One (1) year parts and labor from date of purchase.

Additional Item(s) Excluded From Warranty Coverage:

Appearance items of the Product, filters, accessories, or any printed materials. Product which has been used for rental and/or commercial purposes.

Where to Obtain Service:

From a Sharp Authorized Servicer located in the United States. To find the location of the nearest Sharp Authorized Servicer, call Sharp Toll Free at 1-800-BE-SHARP.

What to Do to Obtain Service:

Ship prepaid or carry in your Product to a Sharp Authorized Servicer. Be sure to have Proof of Purchase available. If you ship the Product, be sure it is insured and packaged securely.

TO OBTAIN SERVICE, SUPPLY, ACCESSORY OR PRODUCT INFORMATION, CALL 1-800-BE-SHARP, OR VISIT OUR WEBSITE AT www.sharppusa.com

SAVE THE PROOF OF PURCHASE AS IT IS NEEDED SHOULD YOUR AIR PURIFIER EVER REQUIRE WARRANTY SERVICE.

SHARP®

SHARP ELECTRONICS CORPORATION

100 Paragon Drive, Montvale, NJ 07645, U.S.A.

EN-3

FOR CUSTOMER ASSISTANCE (Canada)

To aid in answering questions if you call for service or for reporting loss or theft, please use the space below to record the model and serial number located on the side of the unit.

Model Number: _____

Serial Number: _____

Date of Purchase: _____

Dealer Name: _____

Address: _____

City: _____

Province: _____

Postal Code: _____

Telephone: _____

PRODUCT SUPPORT

If you have questions about the setup or operation of your product, please refer to the corresponding section within this manual.

Additionally, visit <http://sharp.ca/support-home.aspx> to access exclusive content about your product including:

Find a Dealer

Find Service Locations

Downloads including the Installation Guide, Spec Sheet, and Owner's Manual

CONTACT US

If at any time you have questions or comments concerning your SHARP product, please contact the SHARP Customer Assistance Center. We are available to assist you through multiple contact methods for your convenience:



EMAIL

Available 24/7

See the Contact Us section on our site.

<http://sharp.ca/contact-emailus.aspx>



SUPPORT SITE

Product Downloads, Service Locator, Where to Buy, Toner Recycling Program and more.

CA | sharp.ca/support-home.aspx



CALL US

CA 877-278-6709
Mon-Fri: 7am-7pm CST

Contact a Sharp Advisor on the phone

CONSUMER LIMITED WARRANTY (Canada)

SHARP

LIMITED WARRANTY Consumer Electronics Products Congratulations on your purchase!

ENGLISH

Sharp Electronics of Canada Ltd. ("Sharp") warrants to the first purchaser for this Sharp brand product ("Product"), when shipped in its original container and sold or distributed in Canada by Sharp or by an authorized Sharp dealer, and Product was not sold "as is" or "sales final" that the Product will during the applicable warranty period, be free from defects in material and workmanship, and will within the applicable warranty period, either repair the defective Product or provide the first purchaser a replacement of the defective Product.

Conditions: This limited warranty shall not apply to:

- (a) Any defects caused or repairs required as a result of abusive operation, negligence, accident, improper installation or inappropriate use as outlined in the owner's manual or other applicable Product documentation.
- (b) Any defects caused or repairs required as a result of any Product that has been tampered with, modified, adjusted or repaired by any person other than Sharp, a Sharp authorized service centre or a Sharp authorized servicing dealer.
- (c) Any defects caused or repairs required as a result of the use of the Product with items not specified or approved by Sharp, including but not limited to chemical cleaning agents.
- (d) Any replacement of accessories required through normal use of the Product, including but not limited to, remote controls, AC adapters, batteries, temperature probe, trays, filters, belts, ribbons, cables and paper.
- (e) Any cosmetic damage to the Product surface or exterior that has been defaced or caused by normal wear and tear.
- (f) Any defects caused or repairs required as a result of damage caused by any external or environmental conditions, including but not limited to, transmission line/power line voltage or liquid spillage or acts of God.
- (g) If the serial number or model number affixed to Product has been removed, defaced, changed, altered or tampered with.
- (h) This limited warranty will not apply if the Product has been used or is being used in a commercial setting or application; this warranty is meant solely for the non-commercial, household use of the Product by consumers in their home or residence.
- (i) Any installation, delivery, setup and/or programming charges
- (j) The removal and reinstallation of Over-The-Range Microwave, Microwave Drawer or Steam Oven if it is installed in an inaccessible location or requiring removal of cupboards, handles or other cosmetic parts, or is not installed in accordance with installation instructions included with Product.

How to get service: Warranty service may be obtained upon delivery of the Product, together with proof of purchase (including date of purchase) and a copy of this limited warranty statement, to an authorized Sharp service centre or an authorized Sharp servicing dealer. In home warranty service will be carried out to locations accessible by on-road service vehicle and within 50 km of an authorized Sharp service centre on any Over-The-Range Microwave Oven, Microwave Drawer Oven or Steam Oven. The servicer may if necessary take the unit for repair at the servicer's facility. No other person (including any Sharp dealer or service centre) is authorized to extend, enlarge or transfer this warranty on behalf of Sharp. The purchaser will be responsible for any and all removal, reinstallation, transportation and insurance costs incurred with exception for Over-The-Range Microwave Oven, Microwave Drawer Oven or Steam Oven whereby Sharp will be responsible for the removal and reinstallation.

The express warranties in this limited warranty are, except for consumer purchasers domiciled in Quebec, in lieu of and, except to the extent prohibited by applicable law, Sharp disclaims all other warranties and conditions, express or implied, whether arising by law, statute, by course of dealing or usage of trade, including, without limitation, implied warranties or conditions of merchantability and/or quality, fitness for a particular use or purpose, and/or noninfringement. **Limitations** (not applicable to consumer purchasers domiciled in Quebec to the extent prohibited under Quebec law): (a) Sharp shall not be liable for any incidental, special, consequential, economic, exemplary or indirect damages of any kind or nature (including lost profits or damages for loss of time or loss of use or loss of data) arising from or in any connection with the use or performance of a Product or a failure of a Product, even if Sharp is aware of or has been advised of the possibility of such damages; (b) the remedies described in this limited warranty constitute complete fulfillment of all obligations and responsibilities of Sharp to the purchaser with respect to the Product and shall constitute full satisfaction of all claims, whether based on contract, negligence, strict liability or otherwise. Some provinces may not allow the exclusion or limitation of certain damages, or limits on the duration or voiding of implied warranties or conditions; in such provinces, the exclusions and limits herein may not apply. This limited warranty is, except for consumer purchasers domiciled in Quebec, governed by the laws of the Province in Canada in which the purchaser has purchased the Product. For consumer purchasers domiciled in Quebec this limited warranty is governed by the laws of Quebec.

WARRANTY PERIODS (calculated from the date of original purchase): Parts & Labour (exceptions noted)

Microwave Oven	1 year (magnetron - 4 additional years)
Steam Oven	1 year
Small Kitchen Appliances	1 year
Air Purifiers	1 year

To obtain the name and address of the nearest Authorized Sharp Service Centre or Dealer, or for more information on this Limited Warranty, Sharp Extended Warranty Offers, Sharp Canada Products or Accessory Sales, please contact Sharp:

- By writing to Sharp Electronics Of Canada Ltd. at 335 Britannia Road East Mississauga, Ontario L4Z 1W9
- Calling: at 905-568-7140
- Visiting our Web site: www.sharp.ca

THIS LIMITED WARRANTY IS VALID ONLY IN CANADA

EN-5

IMPORTANT SAFETY INSTRUCTIONS 1

Read and save these instructions before using this product.

When using electrical appliances, basic safety precautions should always be followed to reduce the risk of fire, electric shock, and injury to persons, including the following:

WARNING

1. Read all instructions before using the product.
2. Use the product only for intended household use as described in this manual. Any other use not recommended by the manufacturer may cause fire, electric shock, or injury to persons.
3. This appliance is not intended for use by persons (including children) with reduced physical, sensory or mental capabilities, or lack of experience and knowledge, unless they have been given supervision or instruction concerning use of the appliance by a person responsible for their safety. Children should be supervised to ensure they do not play with the appliance.
4. Never operate the product if the power cord or plug is damaged or the product is malfunctioning or damaged.
5. If the power cord or plug is damaged, it must be replaced by the manufacturer, its service agent or a Sharp authorized Service Center in order to avoid a hazard.
Contact the nearest Service Center for any problems, adjustments, or repairs.
6. Do not repair or disassemble the product yourself.
7. Follow the instructions a to h below for the power cord or plug. It may cause short circuit, excessive heat, electric shock or fire.
 - a. Use only AC 120 volt outlet.
 - b. Do not use the product if the power cord or plug is damaged or the connection to the wall outlet is loosened.
 - c. Always turn off the product before unplugging the power plug.
 - d. Always unplug the product before moving or maintaining it, opening the back panel, changing the filters and whenever the product is not in use.
 - e. Be sure to pull the power plug and not the power cord.
 - f. Do not touch the power plug with wet hands when inserting or unplugging from the wall outlet.
 - g. Periodically remove dust from the power plug.
 - h. Always observe the following not to damage the power cord.
 - Do not run cord under carpeting. Do not cover the power cord with throw rugs, runners, or similar coverings.
 - Do not put heavy things on the power cord or pinch it.
 - Do not run the power cord under furniture or other appliances.
 - Run the power cord away from traffic area and where it will not be tripped over.

IMPORTANT SAFETY INSTRUCTIONS 2

ENGLISH

8. The product has a polarized plug (one blade is wider than the other). To reduce the risk of electric shock, this plug is intended to fit in a polarized outlet only one way. If the plug does not fit fully in the outlet, reverse the plug. If it still does not fit, contact a qualified electrician or service person. Do not attempt to defeat this safety feature.
9. Do not use this product near gas appliances, fire places, candle fire, incense or sparks from lit cigarettes.
10. Do not operate the product in a room with flammable gas, such as oily residue or chemical fumes.
11. Do not expose the product to rain, or use near water, in a bathroom, laundry area or other damp location.
12. Do not insert fingers or foreign objects into the air inlets or air outlets.
13. Do not look into the air outlets.

NOTE - Radio or TV Interference

If the product should cause interference to radio or television reception, try to correct the interference by one or more of the following measures:

1. Reorient or relocate the receiving antenna.
2. Increase the separation distance between the product and radio/TV receiver.
3. Connect the product into an outlet on a circuit different from that to which the receiver is connected.
4. Consult the dealer or an experienced radio/TV technician for help.

This product complies with the maximum allowable concentration of ozone of 0.050 parts per million by volume (ppmv) in a 24-hour period. The Health Canada Guideline 2010 recommends that the maximum exposure limit, based on an averaging time of 8 hours, is 0.020 ppmv or less when tested in a sealed, controlled room approximately 30 m³.

IMPORTANT SAFETY INSTRUCTIONS 3

CAUTIONS CONCERNING INSTALLATION

1. Place the product on a level and stable surface with sufficient air circulation. When placed on heavy carpet, the product may vibrate slightly.
2. Avoid a location where the sensors are exposed to direct breeze or draft if the product has sensors. The product may not operate properly.
3. Avoid use in locations where furniture, fabrics, or other items may come in contact with and restrict the air inlets and/or outlets.
4. Avoid locations exposed to direct sunlight. It may cause to change shape or color of the product.
5. Avoid locations where the product is exposed to condensation or drastic changes in temperature. Use under appropriate conditions between 32 - 95 °F (0 - 35 °C).
6. Avoid use in locations where greasy or oily smoke is generated. (such as in a kitchen, etc.). The main unit surface may crack and the sensors may malfunction as a result.
7. The dust collecting ability of the product is effective even when the product is as close to 1.2 inches (3 cm) from the wall, but the surrounding walls or floor may get dirty. Please place the product at a distance from the wall. The wall directly behind the air outlets and the floor or rug on which the product placed may become dirty over time. When using the product for an extended period of time at the same location, periodically clean the walls, the floor or the rug.

CAUTIONS CONCERNING FILTER

1. Follow the instructions in this manual for filter installation and maintenance. (Page 11,14,15)
2. Take out the filters from the plastic bag before placing the filter in the main unit.
3. Do not operate the product without the filters properly installed.
4. Do not wash and reuse the True HEPA filter and the Active carbon deodorizing filter.
Washing will not improve filter performance and can also cause electric shock or operating malfunctions.
5. Do not operate the product in rooms where aerosol insecticides are present. It may cause the odor of insecticide to remain in the product and emitted from the air outlets.

CAUTIONS CONCERNING OPERATION

1. Do not block the air inlets or air outlets.
2. Always operate the product in an upright position.
3. Always hold the handle of the product when moving it.
4. Always lift up the product when moving it on easily damaged flooring, an uneven surface, or carpet.

IMPORTANT SAFETY INSTRUCTIONS 4

CAUTIONS CONCERNING MAINTENANCE

1. Follow the instructions in this manual for maintenance. (Page 14,15)
2. Clean the exterior with a soft cloth only.
3. Do not use volatile fluids and/or detergents.
The main unit surface may be damaged or cracked with strong corrosive cleansers, benzine, paint thinner, polishing powder or grease. In addition, the sensors may malfunction as a result if the product has sensors.
4. Do not scrub the back panel (pre-filter) hard during its maintenance.
5. When replacing filters or any accessories, use specified parts in this manual.

ENGLISH

PART NAMES

FRONT

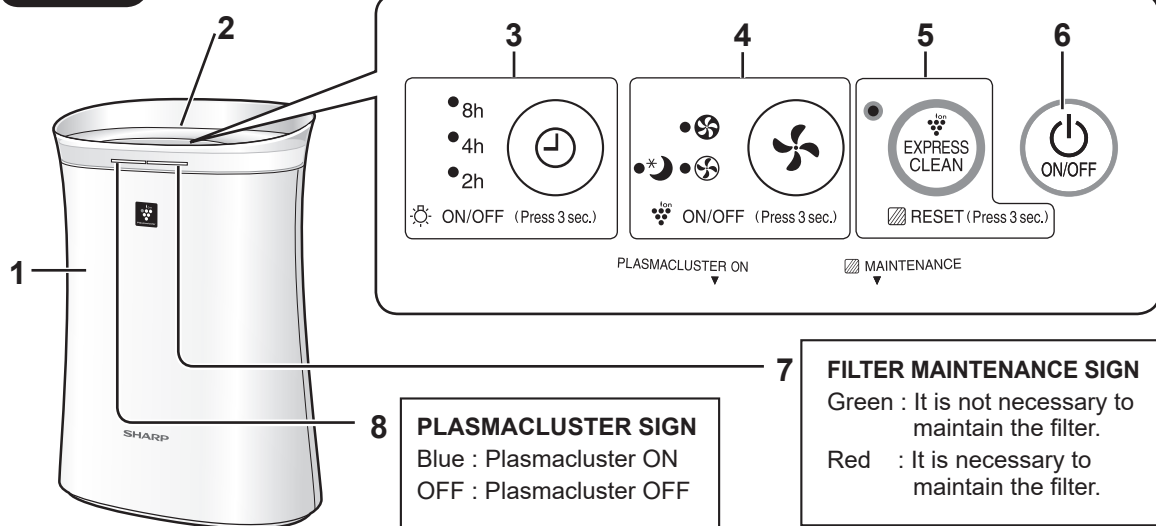

BACK

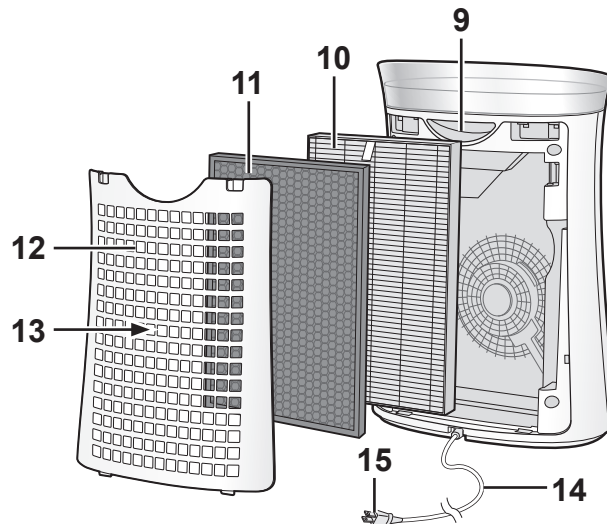

1	Main Unit	6	POWER ON/OFF Button
2	Air Outlet	7	FILTER MAINTENANCE SIGN
3	OFF TIMER Button, Indicator Lights - green (Press 3 sec.) LIGHT ON/OFF Button	8	PLASMACLUSTER SIGN
4	Fan Speed MODE Button, Fan Speed Indicator Lights - green (Press 3 sec.) Plasmacluster Ion ON/OFF Button	9	Handle
5	PLASMACLUSTER EXPRESS CLEAN Button, Indicator Light - green (Press 3 sec.) FILTER RESET Button	10	True HEPA Filter
		11	Active Carbon Deodorizing Filter
		12	Back Panel (Pre-Filter)
		13	Air Inlet
		14	Power Cord
		15	Power Plug

FILTER INSTALLATION

- To maintain the quality of the filter, it is installed in the main unit and packaged in a plastic bag.
- Be sure to stop operation and unplug the product before filter installation or replacement.



ENGLISH

1 Remove the back panel (pre-filter).

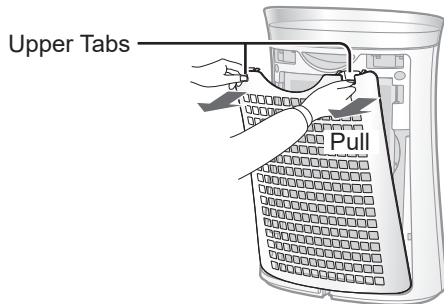

2 Take out the filters from the plastic bag.

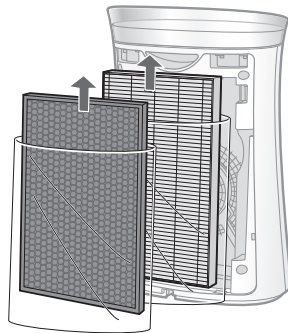

3 Place the filters within the main unit.

Do not install the filters backwards or the product will not operate properly.

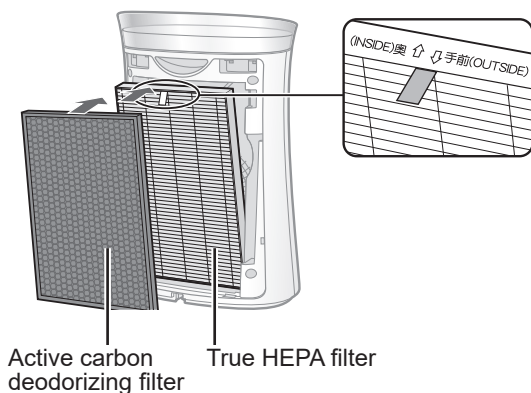

4 Replace the back panel to the main unit

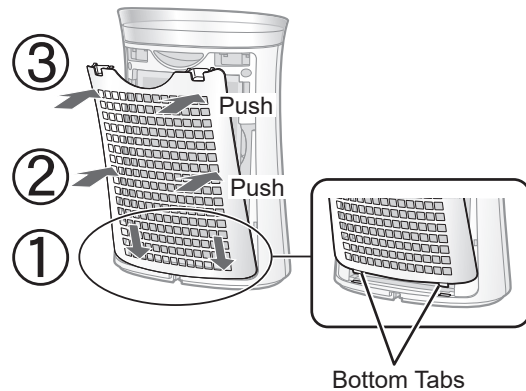

5 Record the date when you start or replace the filters on the back cover of this manual.

True HEPA Filter Filtre HEPA authentique Filtro true HEPA	Model Modèle Modelo	FZ-K50HFU
Starting date of use Date de début d'utilisation Fecha de comienzo de uso		

Active carbon deodorizing filter Filtre déodorant de carbone actif Filtro desodorizante de carbón activo	Model Modèle Modelo	FZ-K50DFU
Starting date of use Date de début d'utilisation Fecha de comienzo de uso		

NOTE

- Do not operate the product without the filter.

OPERATION 1

POWER ON/OFF

START



STOP



NOTE

- Unless the power plug has been unplugged, the operation will Auto Resume in the previous mode it was operating in.

Example: if the power is lost during operation, the operation will resume to previous operation mode and settings if power is restored.

PLASMACLUSTER EXPRESS CLEAN

Releases high-density Plasmacluster ions and discharges strong air flow for 60 minutes.

START



NOTE

- The Plasmacluster Ion can not be turned OFF while operating in PLASMACLUSTER EXPRESS CLEAN.
- When the operation finishes, the product will return to the prior operation mode. It is possible to change to the other fan modes or turn the product OFF while operating in PLASMACLUSTER EXPRESS CLEAN.

FAN SPEED

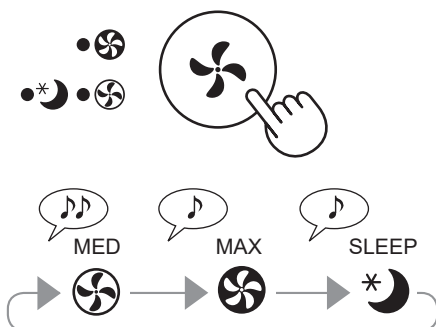

NOTE

SLEEP *

- The product will operate very quietly with low fan speed.
- PLASMACLUSTER SIGN will turn off automatically in SLEEP mode. Although the sign is off, the plasmacluster ion is still being dispersed into the air, unless it is turned off using the fan speed MODE button.
- FILTER MAINTENANCE SIGN will turn off automatically when it is green. FILTER MAINTENANCE SIGN will be dimmed when it is red and the filter needs to be maintained.

OPERATION 2

OFF TIMER

Select the length of time you want, with the product on. The product automatically stops once the selected time is reached.

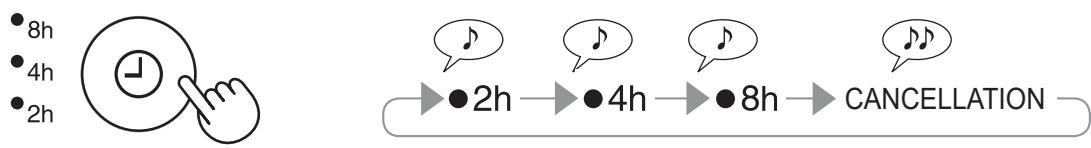

LIGHT CONTROL

You can set FILTER MAINTENANCE SIGN and PLASMACLUSTER SIGN to OFF when their SIGN is bright.

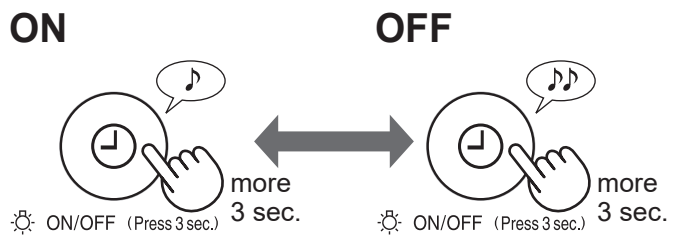

NOTE

- Light control is ON even though it is set as OFF if the product is turned OFF by POWER ON/OFF button.
- In SLEEP mode, LIGHT ON/OFF button is disabled.
- Even though the light control is OFF, FILTER MAINTENANCE SIGN will be dimmed when it is red and the filter needs to be maintained.

Plasmacluster Ion ON/OFF

When plasmacluster ion is ON, the PLASMACLUSTER SIGN will turn blue.

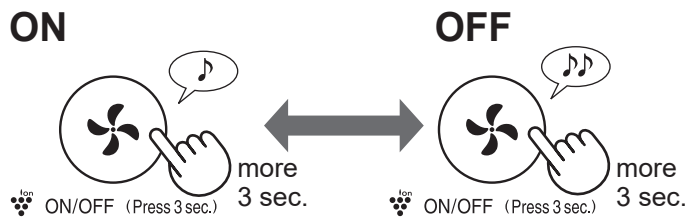

CARE AND MAINTENANCE 1

- To maintain optimum performance of this air purifier, please clean the product including the filter periodically.
- Be sure to stop operation and unplug the product before any maintenance or replacing accessories.



BACK PANEL (Pre-filter)

When the **FILTER MAINTENANCE SIGN** turns red.

FILTER MAINTENANCE SIGN

The FILTER MAINTENANCE SIGN will turn red* when it is time to maintain the back panel (pre-filter) .

*This sign will turn red after approximately 720 hours operating. (30 days × 24 hours = 720 hours)

After maintenance, connect the power plug to the wall outlet and press POWER ON/OFF button, then PLASMACLUSTER EXPRESS CLEAN button for 3 seconds.



RESET (Press 3 sec.)

The FILTER MAINTENANCE SIGN changes from red to green.



FILTER MAINTENANCE SIGN

MAINTENANCE

Gently remove dust from the back panel, using a vacuum cleaner attachment or similar tool.

NOTE

Be careful not to apply too much force to the pre-filter.

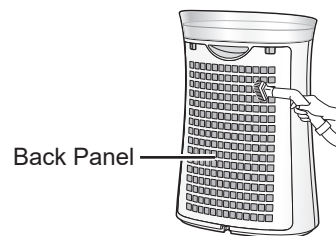

Back Panel

NOTE How to clean hard to remove dirt

1. Add a small amount of dish detergent to water and soak for about 10 minutes.
2. Rinse off the dish detergent with clean water.
3. Completely dry the filter in a well-ventilated area.

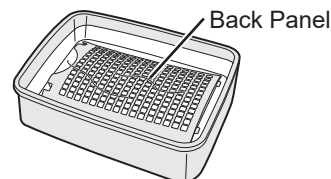

Back Panel

MAIN UNIT

Wipe with a dry, soft cloth.

For stubborn stains or dirt, use a soft cloth dampened with warm water.

NOTE

- **Do not use volatile fluids.**
Benzene, paint thinner, polishing powder, etc. , may damage the surface.
- **Do not use detergents.**
Detergent ingredients may damage the main unit.



CARE AND MAINTENANCE 2

ENGLISH

FILTERS

REPLACEMENT AND MAINTENANCE CYCLE

Filter Name	Maintenance Cycle	Max Service Life	Replacement Filter Model
True HEPA filter	Whenever dust accumulates, when odor emanates from the air outlet, or once a month.	2 years*	FZ-K50HFU
Active carbon deodorizing filter			FZ-K50DFU

*According to Japan Electric Manufacture's Association JEM 1467, the Max service life is based on the equivalent condition of the smoke from 5 cigarettes per day whereby the dust collection/deodorization power is reduced by half compared with that of new filter. It is recommended to replace the filter more frequently under more severe conditions.

MAINTENANCE

Gently remove dust from the filter with a vacuum cleaner attachment or similar tool.

NOTE

- Do not WASH in water and DRY in the sunlight.
- The filter is fragile, be careful not to apply too much force.

True HEPA filter

Perform maintenance only on the side with the tag. Do not clean the opposite side; otherwise, the filter will be damaged.

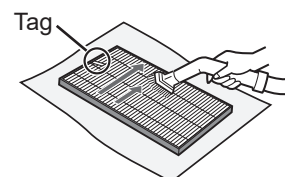

Active carbon deodorizing filter

The maintenance can be applied to both sides.

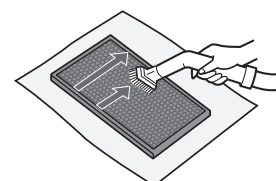

REPLACEMENT

See page 11 for directions on how to install the filter when replacing.

- Please consult your dealer for purchase of replacement filter.
- Use only filter designed for this product.

Record the date when you replace the filters on the back cover of this manual.

Scan the QR code for product information and accessories.



U.S.
only



Canada
only

FZ-K50HFU
: 1 unit

FZ-K50DFU
: 1 unit



Disposal of Filters

Please dispose replaced filter according to the local disposal laws and regulations.

True HEPA filter materials : • Filter : Polypropylene • Frame : Polyester

Active carbon deodorizing filter materials : • Polypropylene, Polyester, Activated charcoal

NOTE

Do not wash and reuse replaced filter.

TROUBLESHOOTING

Before calling for service, please review the list below, since the problem may not be the product malfunction.

SYMPTOM	REMEDY (not a malfunction)
Odors and smoke are not removed.	<ul style="list-style-type: none"> • Clean or replace the filter if they appear to be heavily soiled. (Page 11,14,15)
The discharged air has an odor.	<ul style="list-style-type: none"> • Check to see if the filters are heavily soiled. Clean or replace the filters.
Smell from a new filter.	<ul style="list-style-type: none"> • Immediately after removing the plastic bag, a slight odor may occur. This odor is not harmful for filter performance or human exposure.
A clicking or ticking sound is heard from the product.	<ul style="list-style-type: none"> • Clicking or ticking sounds may be audible when the product is generating ions.
The FILTER MAINTENANCE SIGN is turned off.	<ul style="list-style-type: none"> • Check to see if the lights OFF mode is selected. Press OFF TIMER button for 3 seconds to turn light ON. (Page 13) • Check to see if the SLEEP mode is selected. The FILTER MAINTENANCE SIGN and PLASMACLUSTER SIGN are turned off automatically after the SLEEP mode is selected.
Operation started automatically after my power was restored.	<ul style="list-style-type: none"> • This model has Auto Resume function, where the operation resumes at the previous operation mode and settings if the power is restored.

ON (default)

(with the product OFF)

(simultaneously for more than 3 sec.).

Lighting

OFF

(with the product OFF)

(simultaneously for more than 3 sec.).

NOTE

- If the Fan Speed indicator lights illuminate for 10 seconds, the setting is completed.

SPECIFICATIONS

ENGLISH

Model		FP-K50U		
Power supply		120V / 60Hz		
Fan Speed Operation	Fan Speed Adjustment	MAX	MED	SLEEP
	Rated Power (W)	41	8.0	2.5
	Fan Speed (CFM)	180	88	32
	Noise Level (dBA)*1	51	36	22
	Standby Power (W)	0.3		
Recommended Room Size*2		259 sq. ft. (24m ²)		
High Density Plasmacluster Ion Recommended Room Size*3		248 sq. ft. (23m ²)		
CADR (Dust/Smoke/Pollen)		171 / 167 / 188		
Filter type	Dust collection	True HEPA filter		
	Deodorization	Active carbon deodorizing filter		
Cord Length		6.6 ft. (2.0m)		
Dimensions		15.1 in. (W) × 8.2 in. (D) × 21.3 in. (H) (383mm (W) × 209mm (D) × 540mm (H))		
Weight		11.0 lbs. (5.0kg)		

*1 Noise level is measured based on the JEM 1467 standard of the Japan Electrical Manufacturers' Association.

*2 Size of a room which is appropriate for operating the product at maximum fan speed.

*3 Room size in which approximately 7000 ions per cubic centimeter can be measured in the center of the room when the product is placed close to a wall, is operating on MED mode, and is at a height of approximately 1.2 meters from the floor.

Standby Power

In order to operate the electrical circuits while the power plug is inserted in the wall outlet, this product consumes of standby power.
For energy saving, unplug the power cord when the product is not in use.

Record the date when you start or replace the filters
Notez la date à laquelle vous commencez ou remplacez les filtres
Registre la fecha cuando inicie o sustituya los filtros

True HEPA filter Filtre HEPA authentique Filtro true HEPA	Model Modèle Modelo	FZ-K50HFU	
Starting date of use	.	.	.
Date de début d'utilisation	.	.	.
Fecha de comienzo de uso	.	.	.

Active carbon deodorizing filter Filtre déodorant de carbone actif Filtro desodorizante de carbón activo	Model Modèle Modelo	FZ-K50DFU	
Starting date of use	.	.	.
Date de début d'utilisation	.	.	.
Fecha de comienzo de uso	.	.	.

Replace the filters when they are no longer removing odor or dust.
 Remplacez les filtres lorsqu'ils n'éliminent plus l'odeur ou la poussière.
 Reemplace el filtro cuando éste remueva olor o polvo.

SHARP®

**SHARP ELECTRONICS
CORPORATION**

**100 Paragon Drive, Montvale,
NJ 07645, U.S.A.**

SHARP®

**SHARP ELECTRONICS OF
CANADA LTD.**

**335 Britannia Road East
Mississauga, Ontario L4Z 1W9
Canada**

Printed in Thailand
 Imprimé en Thaïlande
 Impreso en Tailandia
 TINS-B240KKRZ 19H- ①