

IBA3
IBA3-W

Recessed Cable Management and Power Storage Accessory Box

With the IBA3 Recessed Cable and Storage Management Box from Peerless, cables and cords become virtually invisible. When combined with a Peerless mount, the In-wall accessory box provides the perfect behind-the-screen solution to conceal unsightly power and low-voltage cables like HDMI or RCA behind flat panel displays, audio components or other devices. Complete with a receptacle knock-out for adding a duplex power module (not included), the IBA3 creates a professional look in any setting.



FEATURES

- Low-profile design fits behind the thinnest mounts and flat panel displays
- Component cables routed inside the wall
- Sleek design makes outside cable covers unnecessary
- Heavy gage cold rolled steel construction
- Cable ties and grommet included for an organized finish
- Installs between 16" (406mm) wood stud centers when positioned vertically
- Can be mounted horizontally or vertically for better positioning

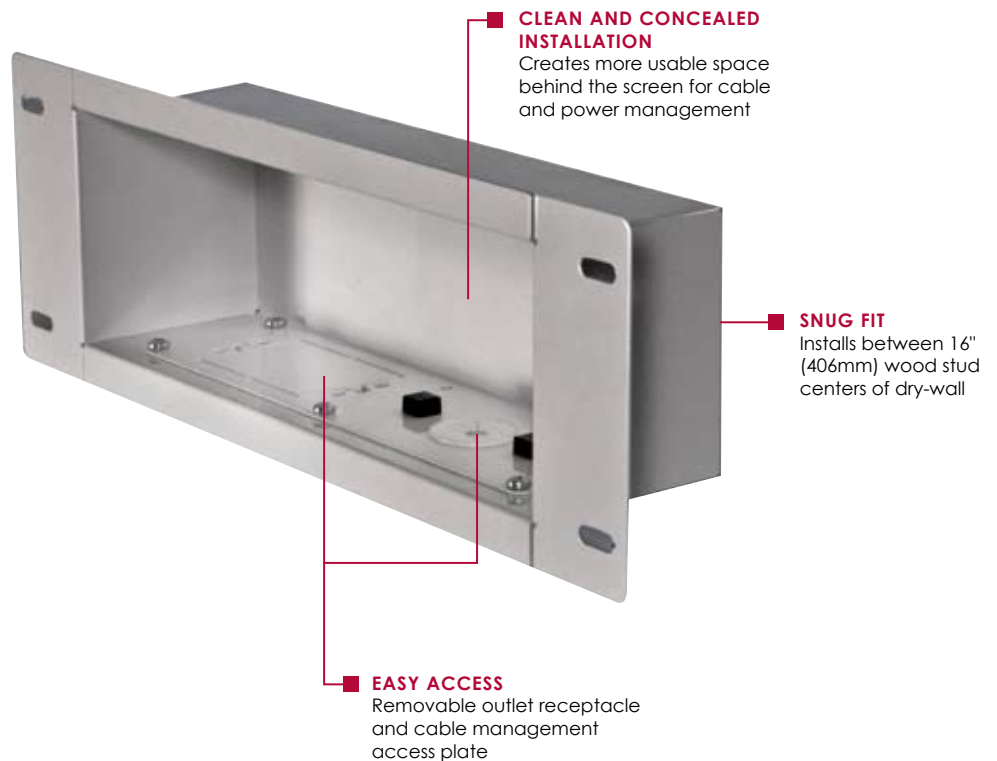

Clean and Easy Cable Management



IBA3(-W)	Recessed Cable Management and Power Storage Accessory Box
-----------------	---

Product Specifications

	DIMENSIONS (W x H x D)	PRODUCT WEIGHT	LOAD CAPACITY	FINISH	AVAILABLE COLORS
IBA3(-W)	Usable Space: 13.10" x 4.35" x 3.76" (333 x 110 x 96mm) Overall Dimensions: 17.42" x 5.75" x 3.76" (442 x 146 x 96mm)	4.5lb (2.04kg)	25lb (11.33kg)	Scratch resistant fused epoxy	IBA3: Gloss Black IBA3-W: White

Package Specifications

	PACKAGE SIZE (W x H x D)	PACKAGE SHIP WEIGHT	PACKAGE UPC CODE	PACKAGE CONTENTS	UNITS IN PACKAGE
IBA3(-W)	21" x 11.5" x 5.25" (533 x 292 x 133mm)	5lb (2.26kg)	IBA3: 735029275848 IBA3-W: 735029275862	Recessed Storage Accessory Box, mounting hardware, cable management ties & grommet	1

NOTES:
DO NOT run or pull the TV cord or other electrical cords inside the drywall. National Electrical Code (NEC) DOES NOT ALLOW the installation of the TV power cord or an extension cord behind the wall. When adding a duplex receptacle power outlet ONLY LICENSED PROFESSIONALS SHOULD INSTALL THIS PRODUCT . Be sure to install the Recessed Cable Management and Power Storage Accessory Box in accordance with the National Electrical Code (NEC) and local codes.

Accessories

ACC415:	Metal Stud Fasteners
----------------	----------------------

All dimensions = inch (mm)

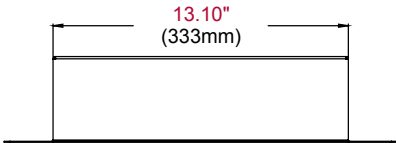

TOP VIEW

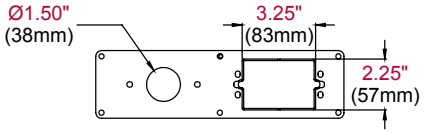

REMOVABLE PLATE

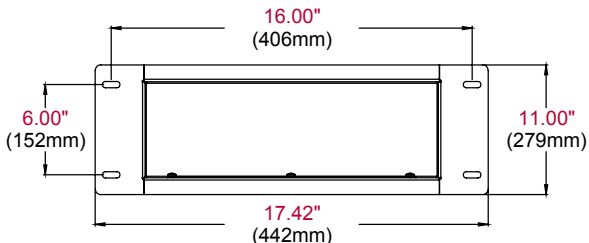

FRONT VIEW

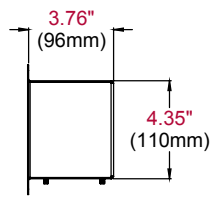

SIDE VIEW

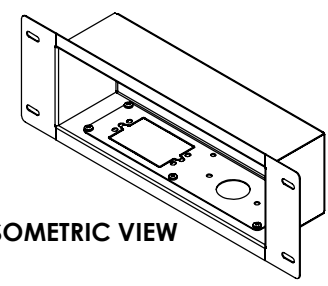

ISOMETRIC VIEW

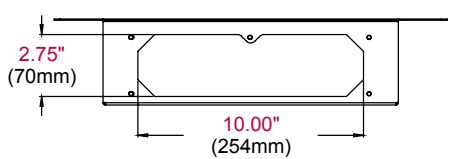

BOTTOM VIEW

ARCHITECTS SPECIFICATIONS

The Recessed Cable Management and Power Storage Accessory Box shall be a Peerless model IBA3 / IBA3-W and shall be located where indicated on the plans. It shall be constructed of heavy gauge cold rolled steel and feature scratch resistant gloss black or white fused epoxy finish. Assembly and installation shall be done according to instructions provided by the manufacturer.