



24-Inch Gas Charbroiler ♦ MCCCCB24A



Standard Features

- ♦ 80,000 BTU output
- ♦ Easy to clean grease trap
- ♦ Heavy duty cast iron 24.3" x 5.6" x 0.83" (616 x 149 x 21 mm) grill grates
- ♦ Cast iron burners with built-in deflectors
- ♦ Bullnose edge
- ♦ Adjustable Incline Grate, reversible for increased versatility
- ♦ Heavy Duty Chrome Plated comfort grip knobs

Exterior Features

- ♦ Stainless steel body and legs
- ♦ 6" Adjustable legs

Certified Safety Standard

- ♦ ETL Certified
- ♦ ETL Sanitation Listed



Warranty Information

- ♦ One year on-site Parts and Labor





24-Inch Gas Charbroiler ♦ MCCC24A

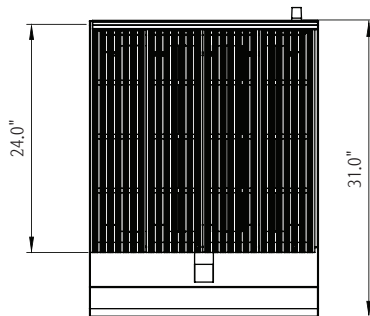

Top View

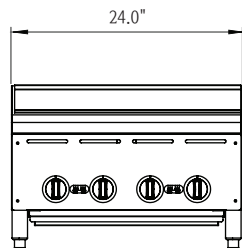

Front View

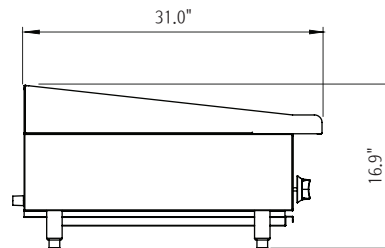

Side View

Model		MCCC24A	MCCC24A-P (Propane)
Gas Output	BTU	80,000	80,000
	(KW)	23.4	23.4
Number of Burners		4	4
Shipping Weight (Lbs)		220.5	220.5
Manifold Pressure	Natural Gas	4" W.C.	-
	Propane Gas	-	10" W.C.
Manifold Size		3/4"	3/4"
Burner Orifice Size		44/2.18mm	54/1.38mm
Cooking Area (Sq. In.)		544.3	544.3
Dimensions (W x D x H)		24.0" x 31.0" x 17.0"	24.0" x 31.0" x 17.0"
Crated Dimensions (W x D x H)		29.1" x 35.8" x 20.5"	29.1" x 35.8" x 20.5"

Clearance requirements:

- For use only on non-combustible floors.
- Legs or casters are required for non-combustible floors.

Clearance requirements	Combustible Surfaces	Non-combustible Surfaces
Rear	6" ~ 8"	0"
Left	6" ~ 8"	0"
Right	6" ~ 8"	0"

Options and accessories



36-Inch Gas Charbroiler ♦ MCCCCB36A



Standard Features

- ♦ 120,000 BTU output
- ♦ Easy to clean grease trap
- ♦ Heavy duty cast iron 24.3" x 5.6" x 0.83" (616 x 149 x 21 mm) grill grates
- ♦ Cast iron burners with built-in deflectors
- ♦ Bullnose edge
- ♦ Adjustable Incline Grate, reversible for increased versatility
- ♦ Heavy Duty Chrome Plated comfort grip knobs

Exterior Features

- ♦ Stainless steel body and legs
- ♦ 6" Adjustable legs

Certified Safety Standard

- ♦ ETL Certified
- ♦ ETL Sanitation Listed



Warranty Information

- ♦ One year on-site Parts and Labor





36-Inch Gas Charbroiler ♦ MCCC36A

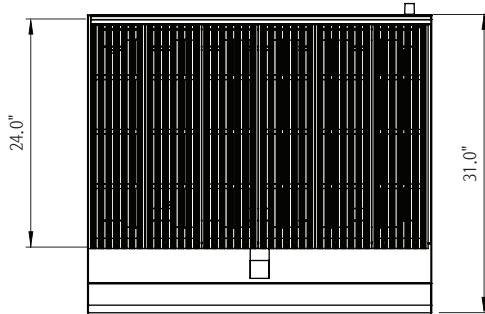

Top View

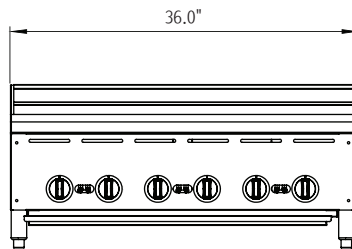

Front View

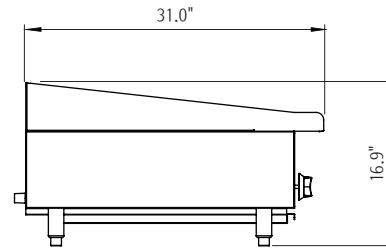

Side View

Model		MCCC36A	MCCC36A-P (Propane)
Gas Output	BTU	120,000	120,000
	(KW)	35.1	35.1
Number of Burners		6	6
Shipping Weight (Lbs)		308.7	308.7
Manifold Pressure	Natural Gas	4" W.C.	-
	Propane Gas	-	10" W.C.
Manifold Size		3/4"	3/4"
Burner Orifice Size		44/2.18mm	54/1.38mm
Cooking Area (Sq. In.)		816.5	816.5
Dimensions (W x D x H)		36.0" x 31.0" x 17.0"	36.0" x 31.0" x 17.0"
Crated Dimensions (W x D x H)		40.9" x 35.8" x 20.5"	40.9" x 35.8" x 20.5"

Clearance requirements:

- For use only on non-combustible floors.
- Legs or casters are required for non-combustible floors.

Clearance requirements	Combustible Surfaces	Non-combustible Surfaces
Rear	6" ~ 8"	0"
Left	6" ~ 8"	0"
Right	6" ~ 8"	0"

Options and accessories



48-Inch Gas Charbroiler ♦ MCCCCB48A



Standard Features

- ♦ 160,000 BTU output
- ♦ Easy to clean grease trap
- ♦ Heavy duty cast iron 24.3" x 5.6" x 0.83" (616 x 149 x 21 mm) grill grates
- ♦ Cast iron burners with built-in deflectors
- ♦ Bullnose edge
- ♦ Adjustable Incline Grate, reversible for increased versatility
- ♦ Heavy Duty Chrome Plated comfort grip knobs

Exterior Features

- ♦ Stainless steel body and legs
- ♦ 6" Adjustable legs

Certified Safety Standard

- ♦ ETL Certified
- ♦ ETL Sanitation Listed



Warranty Information

- ♦ One year on-site Parts and Labor





48-Inch Gas Charbroiler ♦ MCCC48A

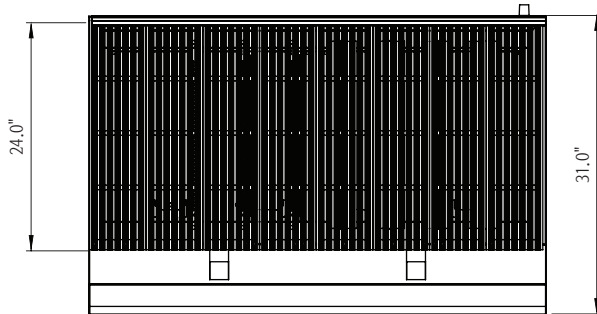

Top View

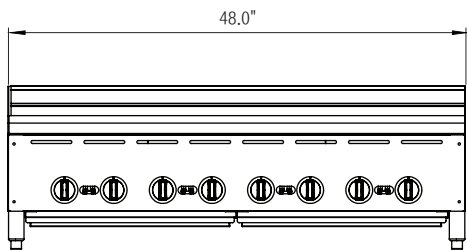

Front View

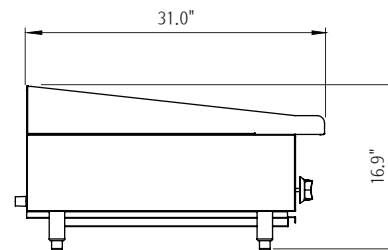

Side View

Model		MCCC48A	MCCC48A-P (Propane)
Gas Output	BTU	160,000	160,000
	(KW)	46.9	46.9
Number of Burners		8	8
Shipping Weight (Lbs)		407.9	407.9
Manifold Pressure	Natural Gas	4" W.C.	-
	Propane Gas	-	10" W.C.
Manifold Size		3/4"	3/4"
Burner Orifice Size		44/2.18mm	54/1.38mm
Cooking Area (Sq. In.)		1088.6	1088.6
Dimensions (W x D x H)		48.0" x 31.0" x 17.0"	48.0" x 31.0" x 17.0"
Crated Dimensions (W x D x H)		52.8" x 35.8" x 20.5"	52.8" x 35.8" x 20.5"

Clearance requirements:

- For use only on non-combustible floors.
- Legs or casters are required for non-combustible floors.

Clearance requirements	Combustible Surfaces	Non-combustible Surfaces
Rear	6" ~ 8"	0"
Left	6" ~ 8"	0"
Right	6" ~ 8"	0"

Options and accessories