



* All images in this datasheet are for illustrative purposes only.

Transparent LED Film LTAK140-GW

Your Imaginative Space Discovered by Transparent Displays



Splendid Atmosphere



Superb Transparency



Self Adhesive



Easy Expandability



Enhanced Brightness



Product Reliability

LTAK140-GW

Pixel Pitch	13.7 ± 0.2 mm (14)
LED Type	R, G, B 3 in 1 Color Package (SMD2020)
Brightness	4,000 nit (Typ.)
Transmittance	53% (Typ.)
Curvature (Concave and Convex)	2,000 R



Transformation to a Splendid Atmosphere

Transparent displays with high brightness enable the implementation of media art in space, transforming an ordinary space into a more artistic space, thereby allowing customers to increase the space's value and arouse interest in it.



Superb Transparency

The LG Transparent LED film reflects the object behind the product even after the product is attached and turned off. This offers a wide-open view while blending into existing interior design smoothly and delivers various information effectively by attracting the attention of passersby.

* Transparency : Typ. 53%

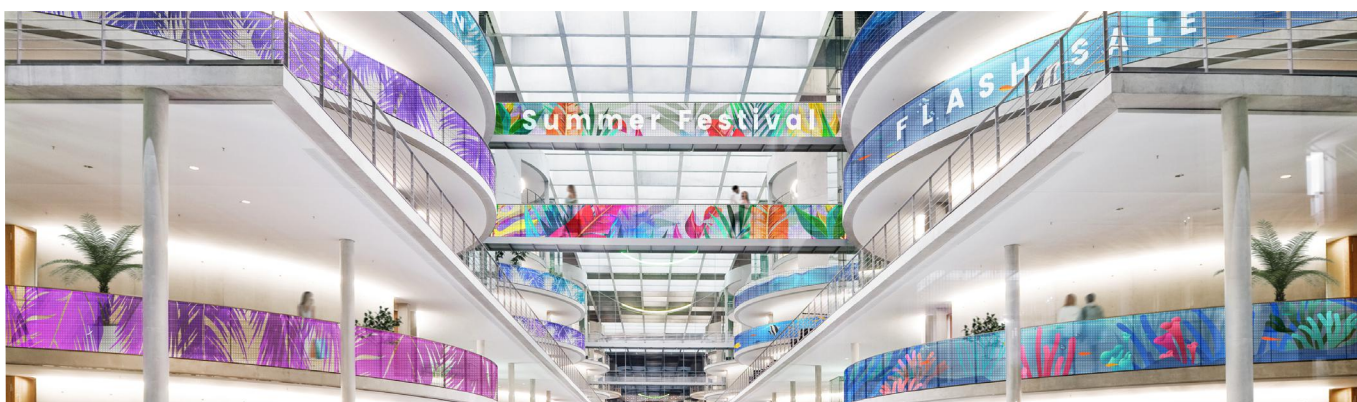

Fitting in with Flats and Curves

The LG Transparent LED film supports curvatures up to 2,000R convex and concave for curved glass or window applications, and offers even surface by durable, transparent layers. This allows a wide range of venues to be redesigned with the LTAK140-GW as a landmark.

What is R?



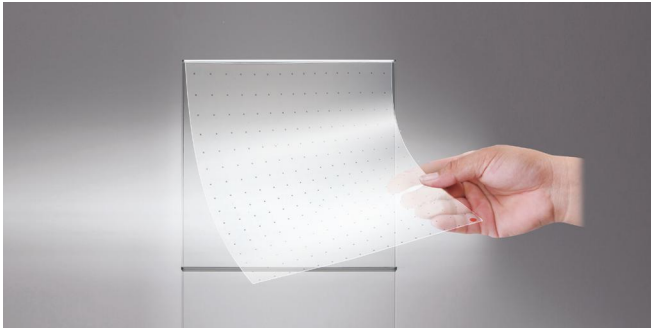

Self-adhesive Film

The LG Transparent LED film is self-adhesive, so it can be easily attached to the surfaces of existing window glass without the need for any complicated construction.

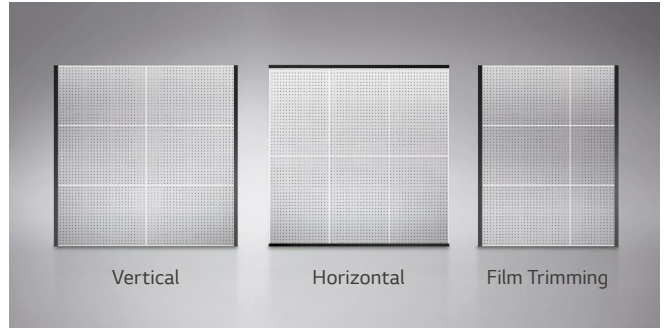

Outstanding Expandability and Flexibility

The size and layout of the film can be customized to fit into the installation area. It can be expanded by adding more films in a vertical or horizontal way, or cut in parallel with the bezel to meet size requirements.

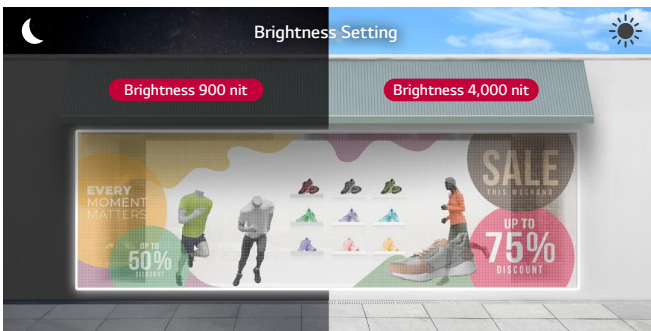

Enhanced Brightness and Control

The LED film with smaller pixel pitch, 14mm, and advanced brightness of up to 4,000nit(cd/m²)* attracts the attention of passersby while displaying a wide range of colors. Also, by using Control Manager solution, you can adjust and set brightness by timeline to deliver messages with optimal brightness.

* The examined brightness may differ from testing environments including a photometer.



webOS Smart Platform

LG webOS is a web-centric platform, making it easier for SIs and developers to build web-based solutions according to various environments. By supporting SCAP and compatibility with HTML, CSS, and JavaScript, you can save time and labor costs.

* webOS API will be provided to authorized SIs and developers.

* SCAP : Signage Common Application Platform. API interface service for SIs.

* CSS : Cascading Style Sheets

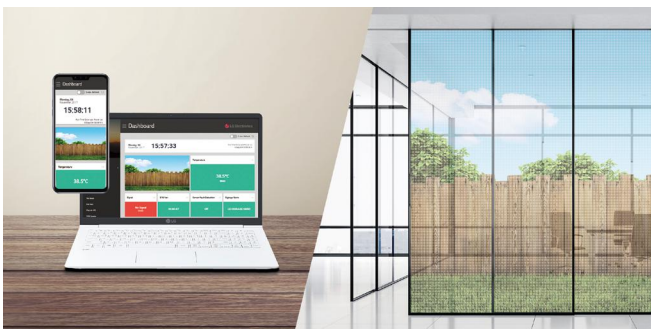

Control Manager

Through the Control Manager, available on internet-connected devices, you can set, control contents and monitor the status of multiple displays in different locations in real time. Especially for LG Transparent LED film installed on large area, the Control Manager helps you to play and check contents in easier way.

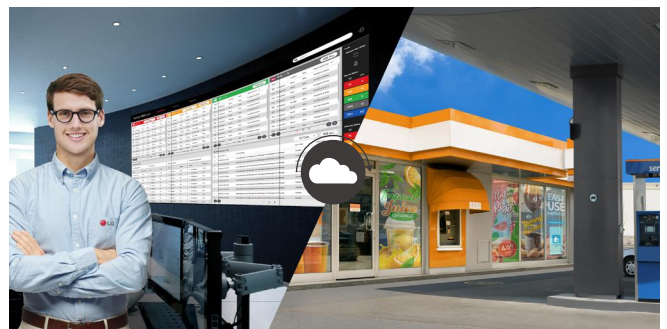

Real-time LG ConnectedCare Service

Maintenance is easy and fast with the optional LG ConnectedCare* service, a cloud service solution provided by LG. It remotely manages the status of displays in client workplaces for fault diagnosis and remote-control services, supporting the stable operation of clients' businesses.

* The availability of the 'LG ConnectedCare' service differs by region, and it needs to be purchased separately. So please contact the LG sales representative in your region for more details.

COMPONENTS & SYSTEM CONNECTION

Components

1. LED Film 2. Bezel Kit 3. Power Adapter 4-1. Unit Controller 4-2. System Controller 5. One Box Controller

* The required amount of components vary depending on the screen size.
 * One Box Controller can replace Unit Controller and System Controller when install within 75 sheets of film.

System Connection

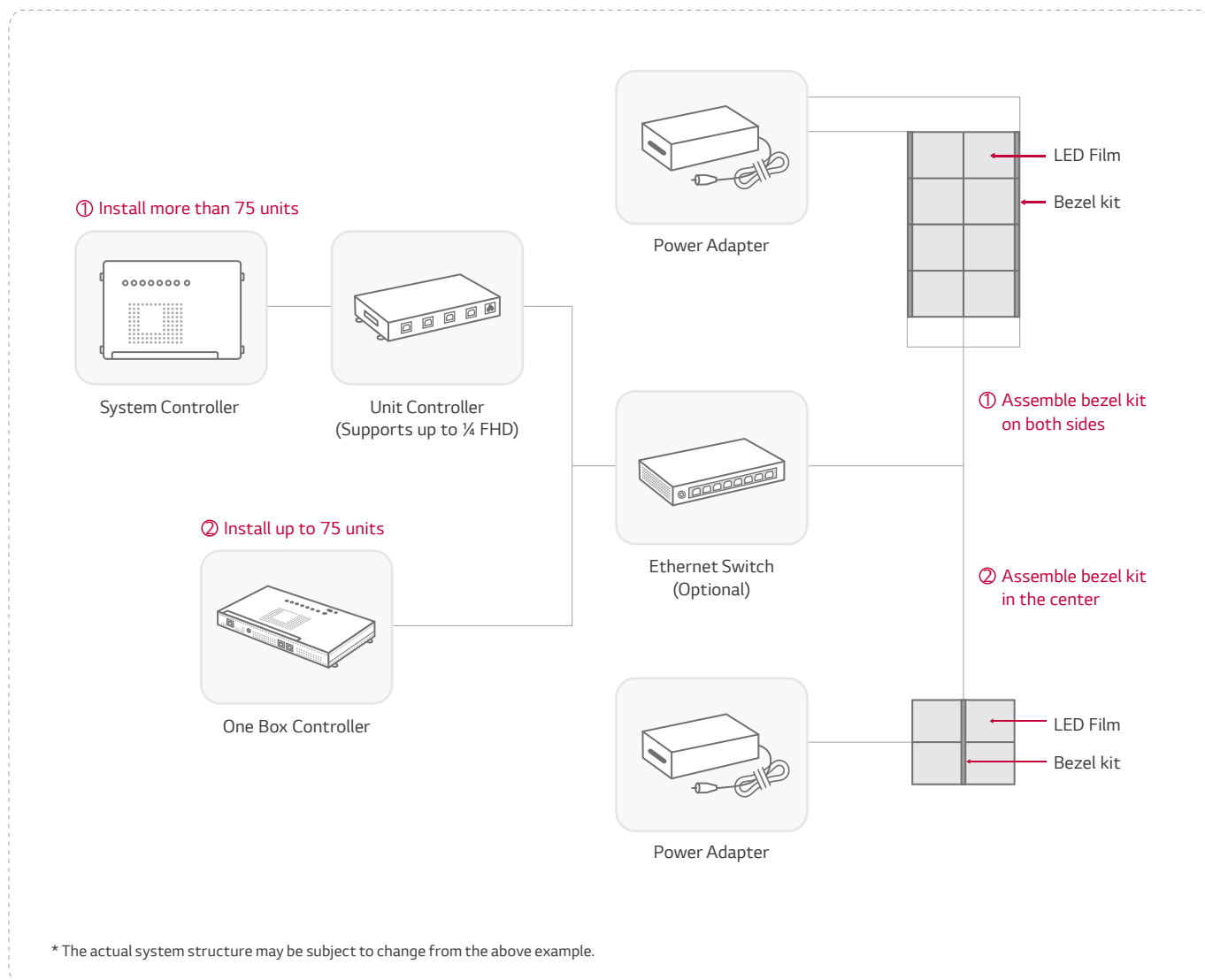

SPECIFICATIONS

LED Film	LTAK140-GW
Pixel Pitch	13.7 ± 0.2 mm (14)
LED Type	R, G, B 3 in 1 Color Package (SMD2020)
Resolution	48 × 36
Pixels per Panel	1,728
Pixel Density	5,102 pixels/m ²
Brightness	4,000 nit (Typ.)
Contrast Ratio	≥ 100,000 : 1
Luminance Uniformity	≥ 70%
Viewing Angle (H × V)	120 × 120
Daily Usage	24 Hours / 7 Days
Transparency	53% (Typ.)
Operating Temperature	0°C ~ 45°C (Installing at Indoor Glass)
Curved Installation	2,000 R (Concave and Convex available on Glass)
Film Trimming	Yes (Horizontal Direction according to Bezel Only)
Color Processing	(9 bit) 500 / 500 / 500 Level (R, G, B)
Colors	125,000,000 Colors
Color Chromaticity	Cx : 0.25 ± 0.03, Cy : 0.33 ± 0.03
Dimension (W × H × D)	655 × 492 × 2.9 mm (with Front & Back Protection Film)
Weight	1 kg
Power Consumption	75 W per Film

1st Bezel Kit	ACC-LTAK14W1	Common Bezel Kit	ACC-LTAK14W2
Dimension (W × H × D)	69.4 × 492 × 25 mm	Dimension (W × H × D)	51.4 × 492 × 25 mm
Weight	0.4 kg	Weight	0.3 kg

Power (Bezel Kit & LED Film)	ACC-LATP1	Unit Controller	LCLG141U
Dimension (W × H × D)	183 × 86 × 28 mm	Resolution	960 × 540 (1/4 FHD)
Weight	769 g	Interface	Input : LVDS Output : RJ45 × 4 ea
Input	100-240 V, 50-60 Hz	Maximum Transmission Length	100 m (Cable Type : CAT5E, CAT6)
Output	19.5 V / 10.8 A (210 W)	Dimension (W × H × D)	293 × 188.7 × 37 mm
Color	White	Weight	1.5 kg
DC Output Cable	14 AWG, 1.5 m	Power Consumption	20 W
Type	L Type		

System Controller	LCLG002-T	One Box Controller	CTAA-140G
Video	DP : 1,920 × 1,080 @ 60 Hz HDMI : 1,920 × 1,080 @ 60 Hz DVI-D : 1,920 × 1,080 @ 60 Hz	Video	HDMI : 1,920 × 1,080 @ 60 Hz
Input	HDMI, DP, DVI-D, RS-232C (Phone Jack Type), RJ45, IR Receiver, USB 3.0	Input	HDMI, RS-232C (Phone Jack Type), RJ45, IR Receiver, USB 3.0
Output	DP, RS-232C (Phone Jack Type), RJ45, LVDS	Output	RS-232C (Phone Jack Type), RJ45 (2)
Dimension (W × H × D)	293 × 193.3 × 40.1 mm	Dimension (W × H × D)	333 × 186.8 × 40.1 mm
Weight (Head)	1.6 kg	Weight (Head)	1.82 kg
Temperature Sensor / Light Sensor	Yes / Yes	Temperature Sensor / Light Sensor	Yes / Yes
Source Selection	HDMI, DVI-D, DP	TPC (Temporal Peak Luminance Control)	Yes
TPC (Temporal Peak Luminance Control)	Yes	Power Consumption	30 W
Power Consumption	17 W	CMS S/W	Yes (3.0)
CMS S/W	Yes (2.9)	Accessory	Power Cord, IR+Bright Sensor (1.5 m), 4P Phone to RS-232C Gender, ESG, Regulation Book, Warranty Card

* Specifications are subject to change without notice. Please make sure to check the product manual for details about product usage.



Download
LG C-Display+
Mobile App
Google Play Store

www.lg.com/global/business/information-display
www.youtube.com/c/LGECCommercialDisplay
www.facebook.com/LGInformationDisplay
www.linkedin.com/company/LGInformationDisplay
twitter.com/LG_ID_HQ

LG may make changes to specifications and product descriptions without notice. Copyright © 2023 LG Electronics Inc. All rights reserved. "LG Life's Good" is a registered trademark of LG Corp. The names of products and brands mentioned here may be the trademarks of their respective owners.