

Galanz

Full Size Vignette Assembly Instructions

PARTS LIST

Qty.	Description
(1)	Left Side Panel #1
(1)	Right Side Panel #2
(1)	Lower Brace #3
(1)	Upper Brace #4
(1)	Divider Panel #5
(1)	Left Range Trim #6
(1)	Right Range Trim #7
(1)	Left Range Counter Top #8
(1)	Right Range Counter Top #9
(1)	Left Dishwasher Trim #10
(1)	Right Dishwasher Trim #11
(1)	Dishwasher Counter Top #12
(1)	Left Upper Side #13
(1)	Right Upper Side #14
(1)	Lower Back #15
(1)	Upper Back #16
(1)	Left Header Bottom #17
(1)	Left Header Side #18
(1)	Right Header Bottom #19
(1)	Right Header Side #20
(1)	Header Support #21
(1)	Header #22
(3)	Metal Supports
(2)	Backsplash Graphics

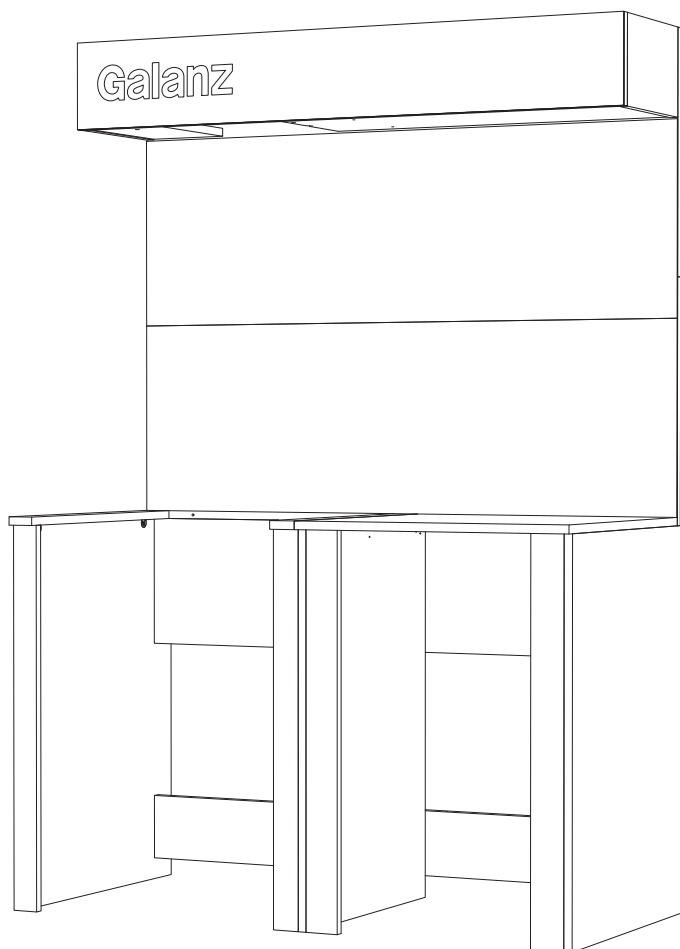

TOOLS REQUIRED

Qty.	Description
(1)	Phillips Screwdriver
(1)	Rubber Mallet
(1)	1/8" Drill Bit

TOOLS REQUIRED

Item	Qty.	Description
A	(12)	Mini-Fix Cams
B	(12)	Mini-Fix Posts
C	(9)	2-1/4" Wood Screws
D	(28)	5/8" Pan Head Screws <i>25 used in display / 3 for product</i>
E	(3)	Flat Washers <i>used with pan head on microwave mount plate</i>

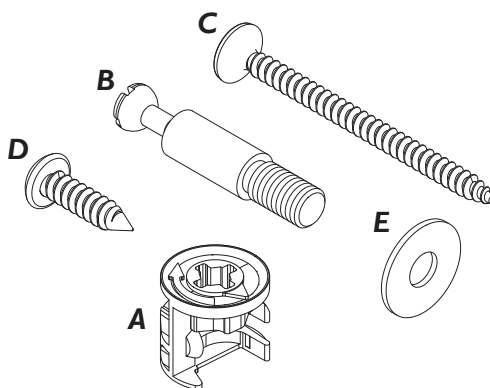

MOVING THE ASSEMBLED DISPLAY IS NOT RECOMMENDED. ASSEMBLE THE DISPLAY A FEW FEET IN FRONT OF ITS FINAL LOCATION AND PUSH IT BACK INTO PLACE.

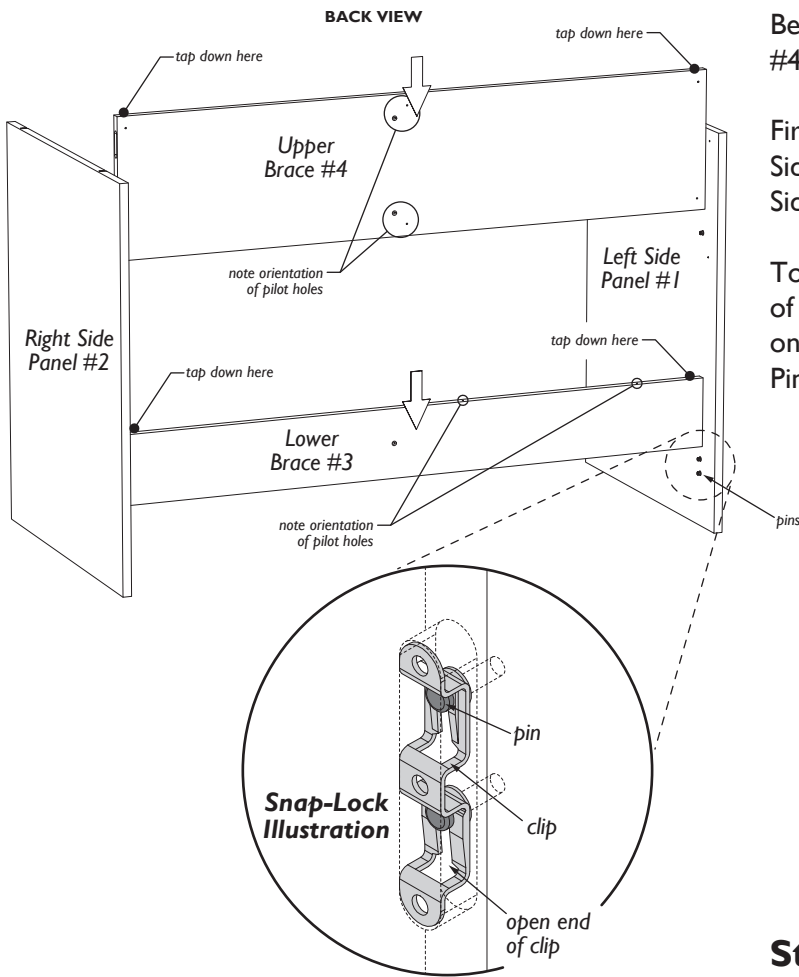

Step 1

Before beginning, orient Lower Brace #3 and Upper Brace #4 as shown (see details about pilot holes).

First, attach Lower Brace #3 to Left Side Panel #1 and Right Side Panel #2 by "snap-locking" the Braces down onto the Side Panels. Repeat the process for Upper Brace #4.

To do this, insert the Side Panel's (2) Pins into the open ends of the (2) Clips in the edge of the Braces. Firmly tap down on the Brace's top corners with a rubber mallet until the Pins slide into the Clips and are firmly engaged.

Step 2

Attach Divider Panel #5 to Lower Brace and Upper Brace using (3) 2-1/4" Wood Screws.

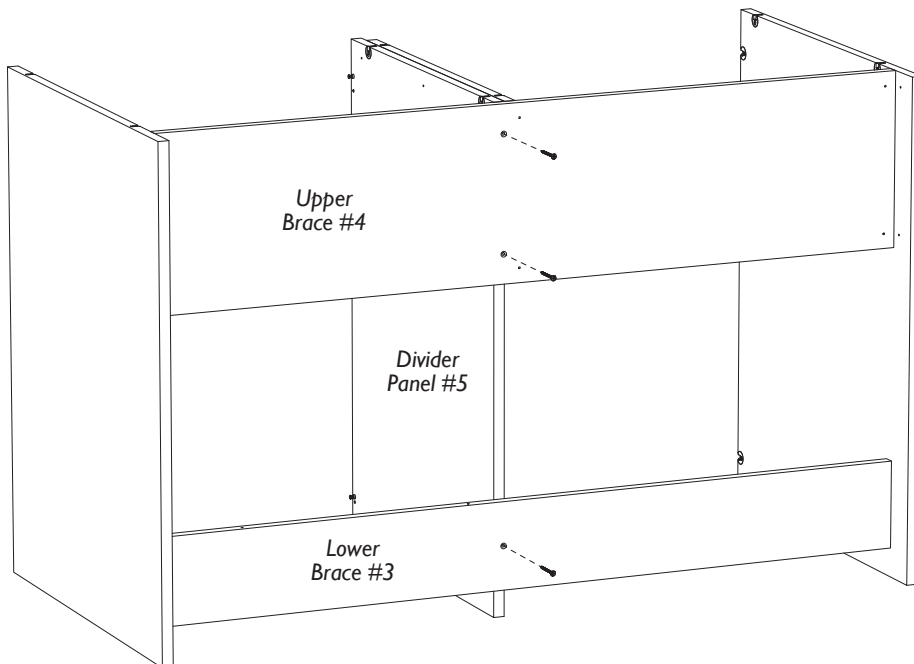

Step 3

Attach Left Range Trim #6 and Right Range Trim #7 to the left side of the assembly by sliding the Trim's Screw Post into the Side Panel's Rafx Cam's. Secure the Trims in place by tightening each Cam-Lock's inner barrel one quarter turn.

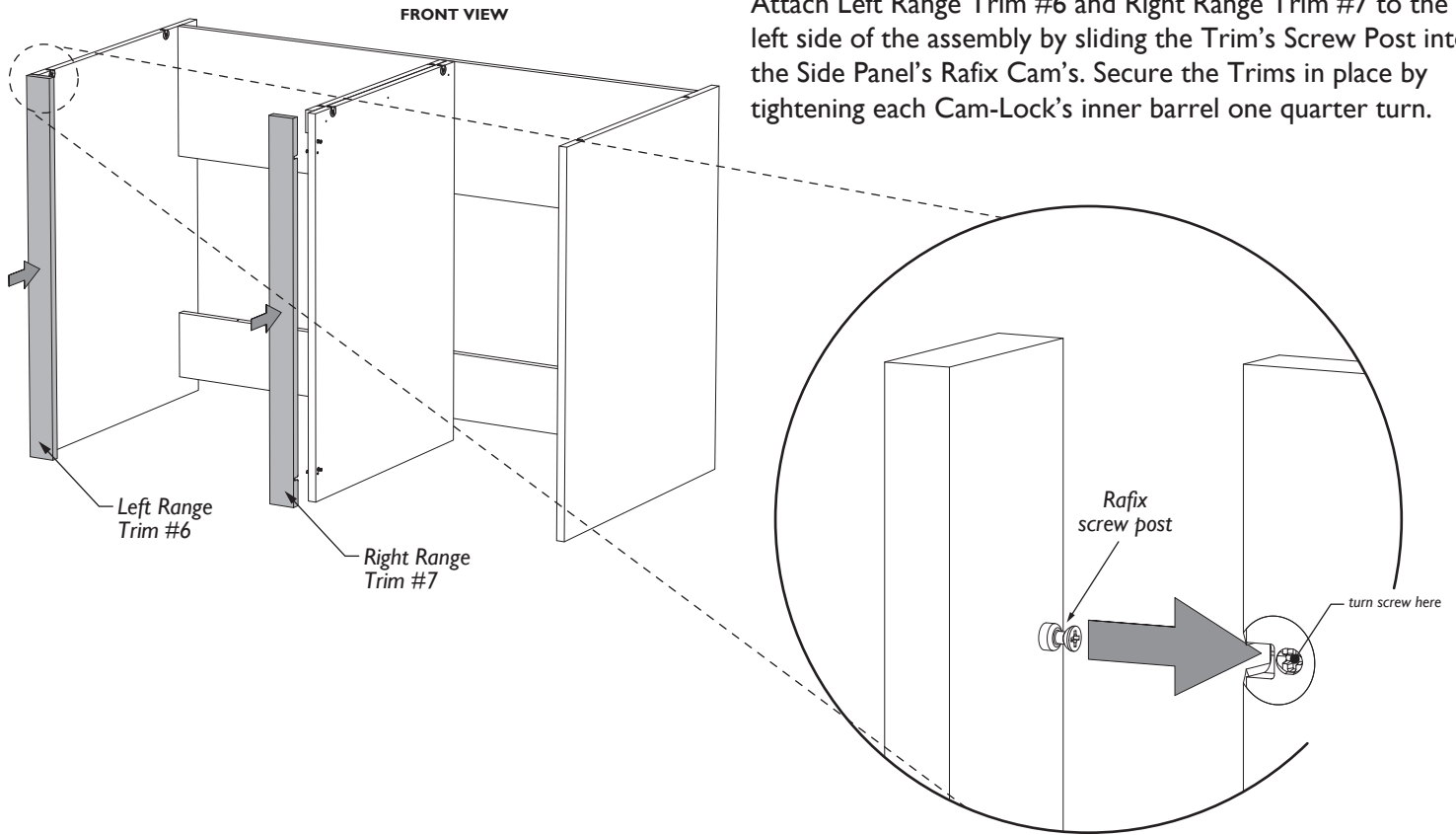

IF AN 18" DISHWASHER WILL BE DISPLAYED, PROCEED WITH STEP 4. IF A 24" DISHWASHER WILL BE DISPLAYED, REMOVE THE (4) SCREW POSTS IN THE RIGHT SIDE PANEL AND DIVIDER PANEL AND SKIP TO STEP 5.

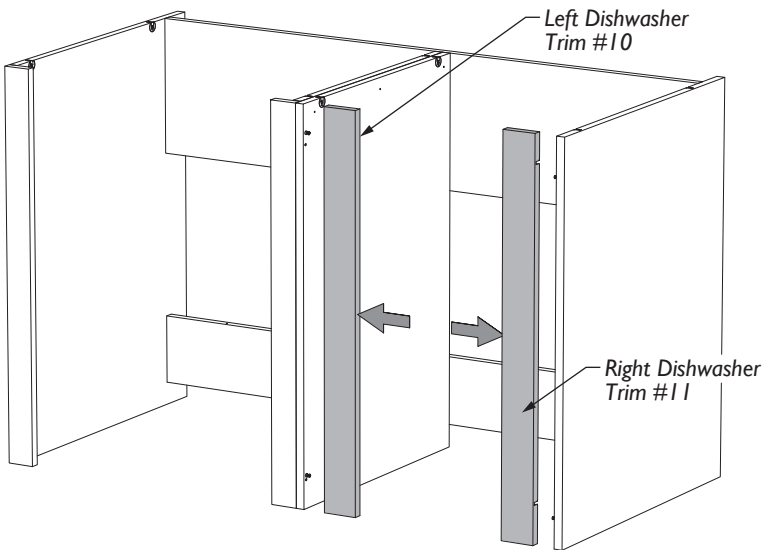

Step 4

Attach Left Dishwasher Trim #10 and Right Dishwasher Trim #11 to the right side of the assembly. Secure the Trims in place by tightening each Cam-Lock's inner barrel one quarter turn.

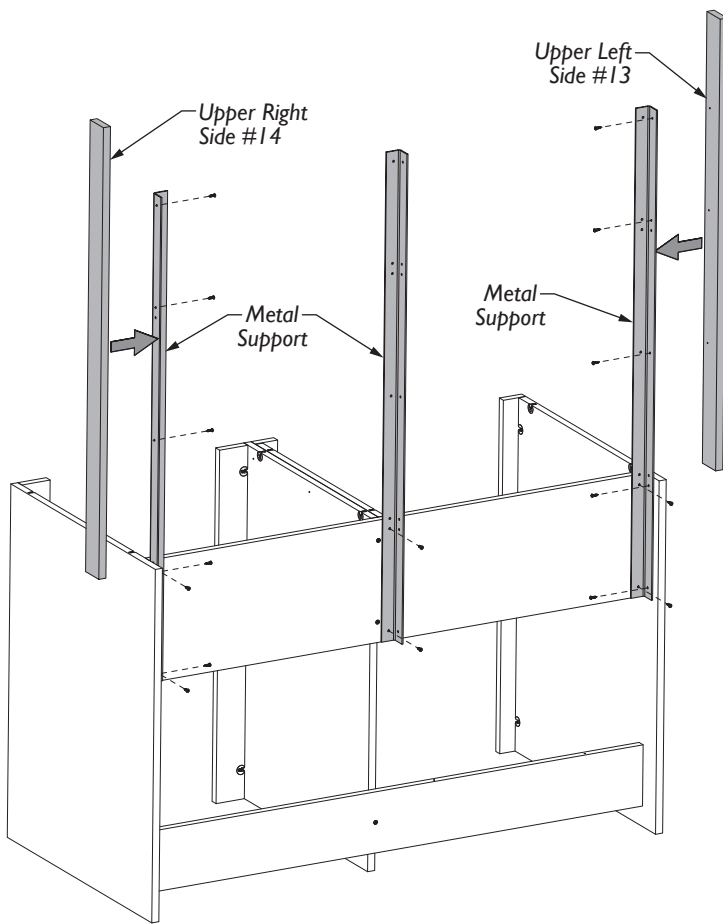

Step 5

Attach (3) Metal Supports to the back of the Upper Brace and the Left and Right Side Panels using (10) 5/8" Pan Head Screws.

Then, attach Upper Left Side #13 and Upper Right Side #14 to the outer two Metal Supports using (6) 5/8" Pan Head Screws.

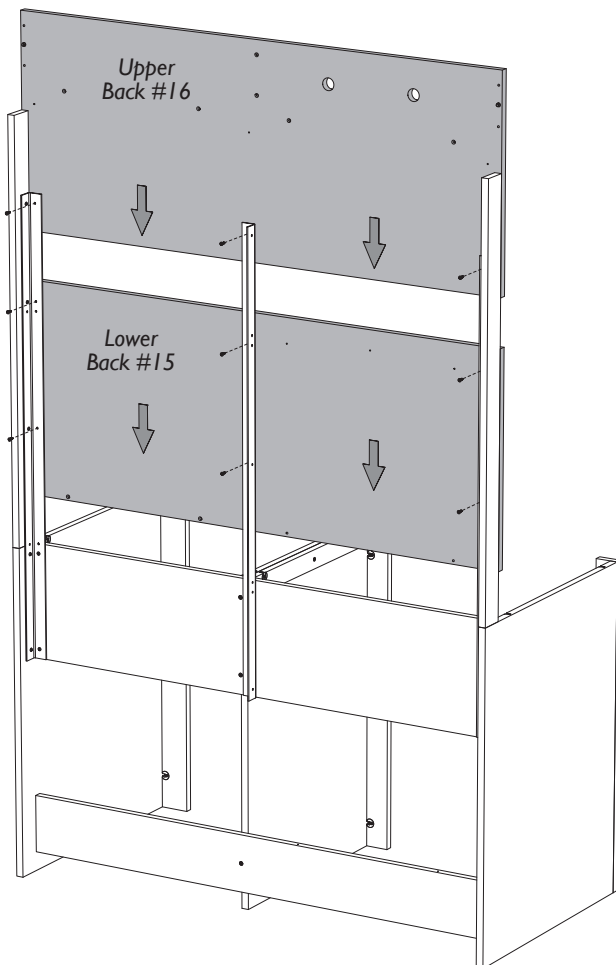

Step 6

Position the posts in Lower Back #15 (the number is on the bottom edge) into the Upper Side Panel's clips and snap-lock down into place.

Position the posts in Upper Back #16 (the number is on the bottom edge) into the Upper Side Panel's clips and snap-lock down into place.

Attach Lower Back #15 and Upper Back #16 to the Metal Supports using (9) 5/8" Pan Head Screws.

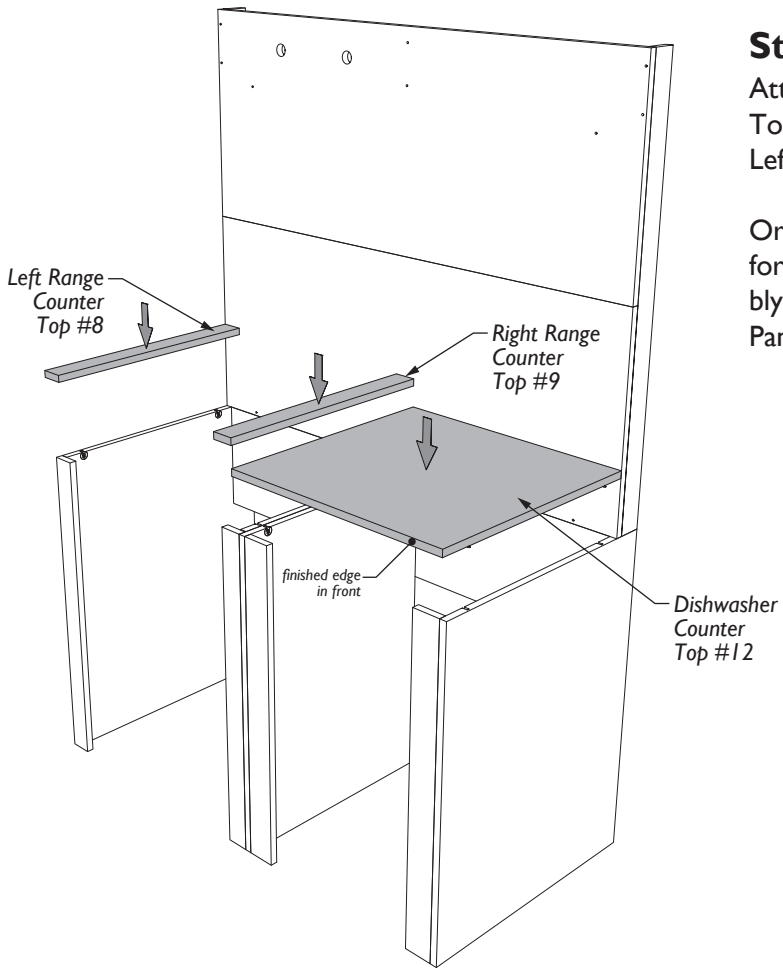

Step 7

Attach Left Range Counter Top #8 and Right Range Counter Top #9 to the assembly and tighten the Rafx Cams in the Left Side Panel and Divider Panel Cleat.

Orient Dishwasher Countertop #12 so the finished edge is forward. Attach the Dishwasher Counter Top to the assembly and tighten the Rafx Cams in the Side and Divider Panels.

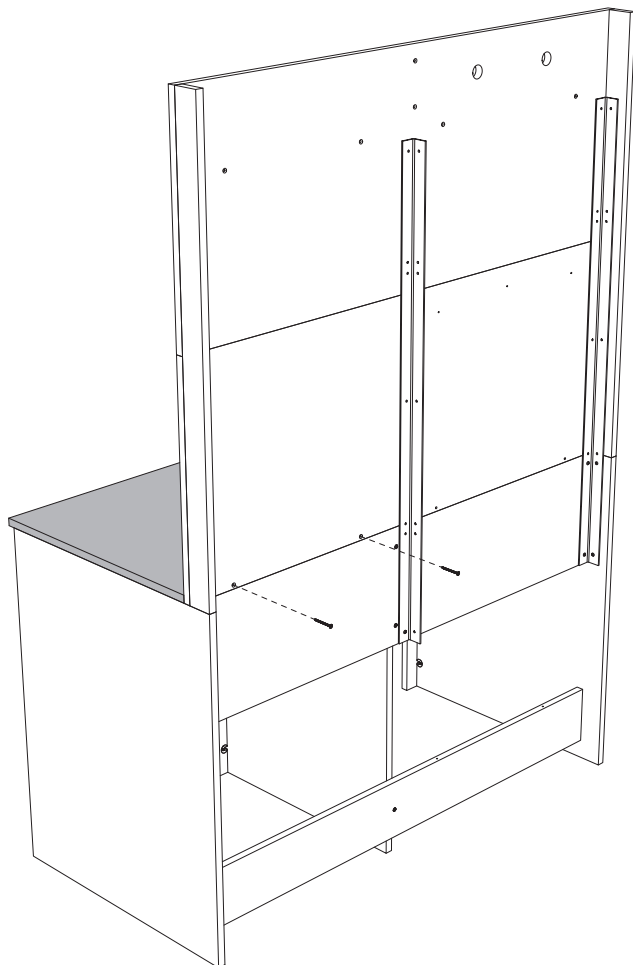

Step 8

Secure the Dishwasher Counter Top to the Lower Back from the back side using (2) 2-1/4" Wood Screws.

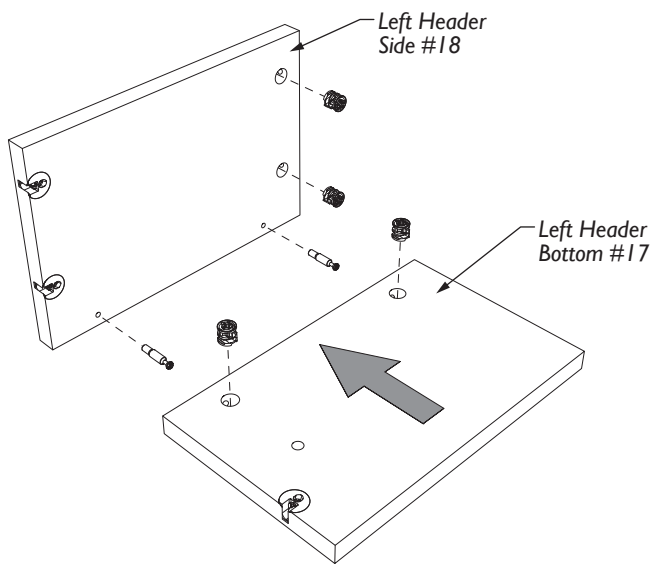

Step 9

Insert (2) Mini-Fix Cams into the slots in Left Header Bottom #17. Insert (2) Mini-Fix Cams into the slots in Left Header Side #18. Screw (2) Mini-Fix Posts into Left Header Side #18.

Attach Left Header Bottom to Left Header Side. Use a screwdriver to turn the Left Header Bottom's Mini-fix Cam's one quarter turn to secure it in place.

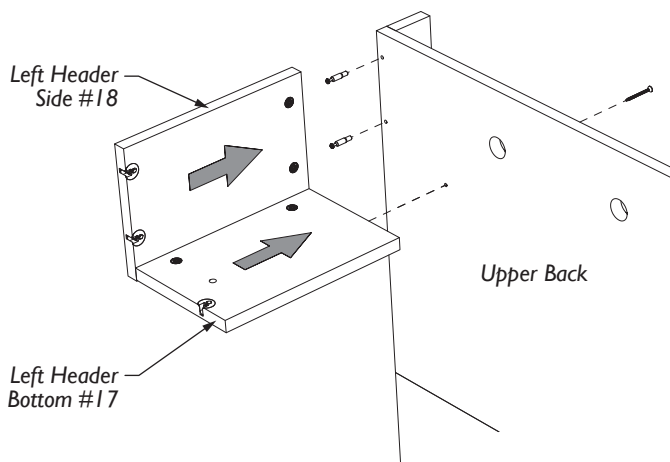
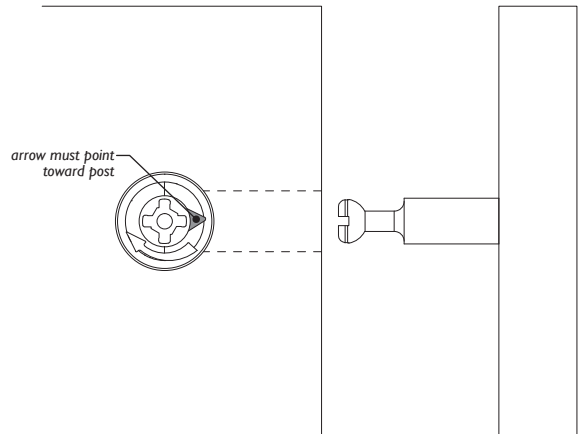

Step 10

Screw (2) Mini-Fix Posts into the Upper Back.

Attach the Left Header Side/Bottom assembly onto the Upper Back Panel. Use a screwdriver to turn all Mini-fix Cam's one quarter turn.

Secure Left Header Bottom #17 to the Upper Back using a 2-1/4" Wood Screw.

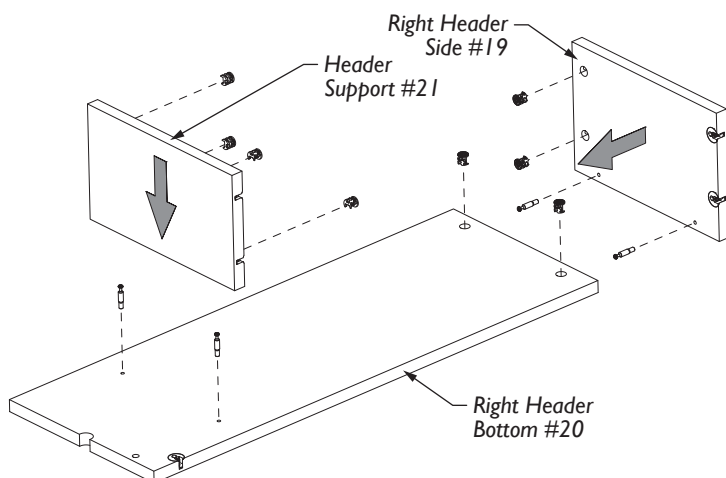

Step 11

Insert (2) Mini-Fix Cams into Right Header Side #19, (2) Mini-Fix Cams into Right Header Bottom #20, and (4) Mini-Fix Cams into Header Support #21. Screw (2) Mini-Fix Posts into Right Header Side #19 and (2) Mini-Fix Posts into Right Header Bottom #20.

Attach the Header Support and Right Header Side to Right Header Bottom. Use a screwdriver to turn all Mini-fix Cam's one quarter turn.

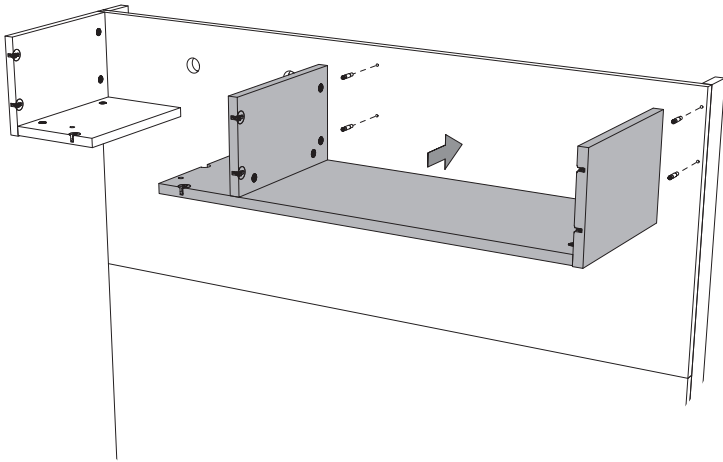

Step 12

Screw (4) Mini-Fix Screw Posts into the Upper Back. Attach the Right Header assembly to the Back Panel. Use a screwdriver to turn the Mini-fix Cam's one quarter turn to secure it in place.

Secure the Right Header assembly to the back of the Back Panel using (3) 2-1/4" Wood Screws.

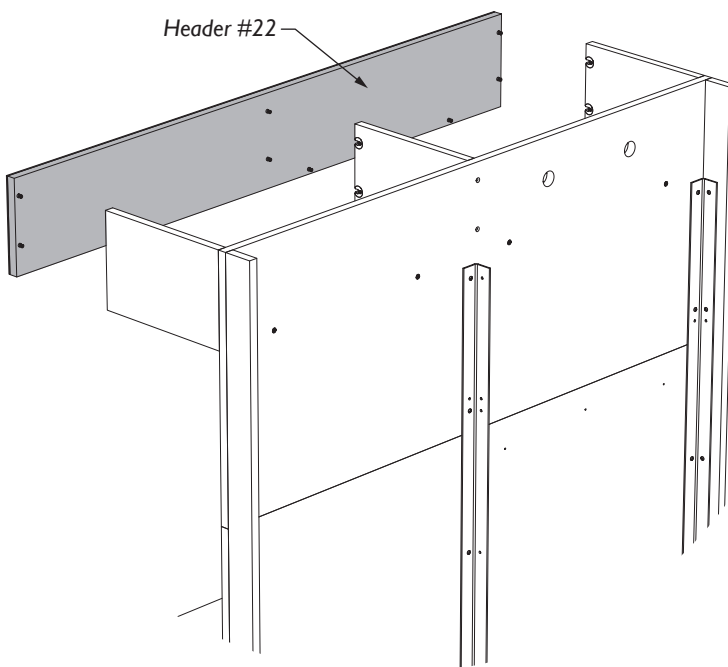
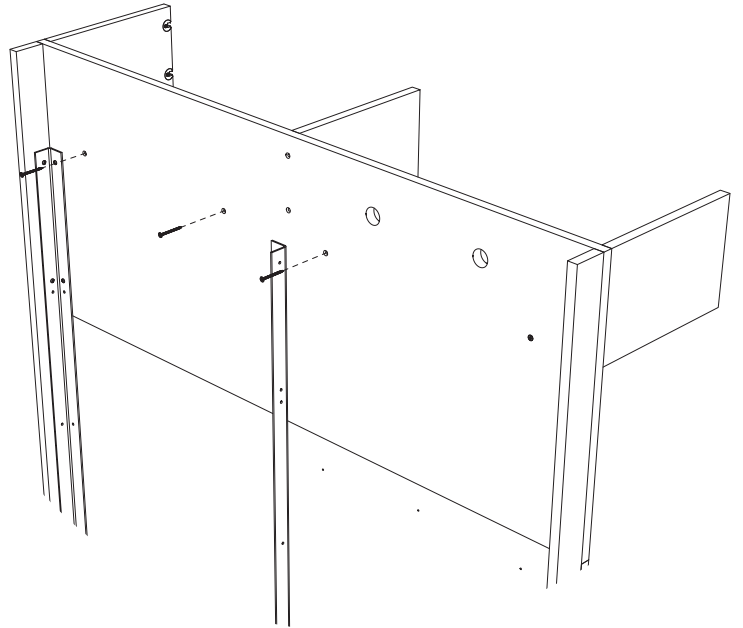

Step 13

Attach Header #22 onto the Cabinet Panels. Use a screwdriver to turn the (8) Rafx Cams one quarter turn to secure it in place.

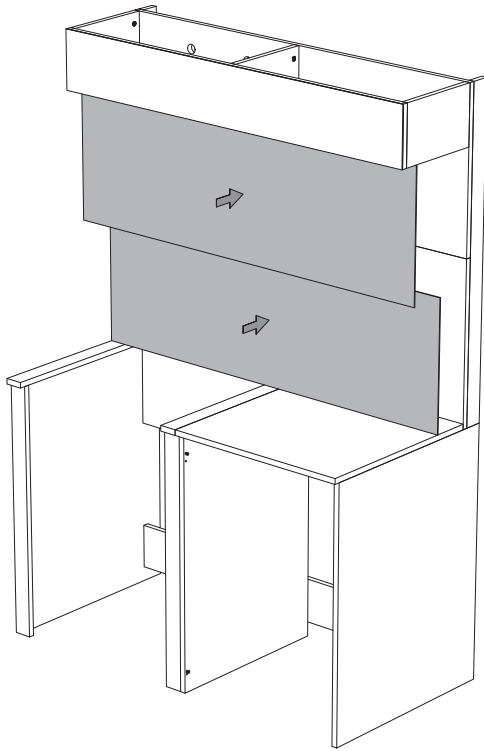

Step 14

Tape the (2) Backsplash Graphics to the Back Panels. Each one is labeled on the back side to identify the top edge.

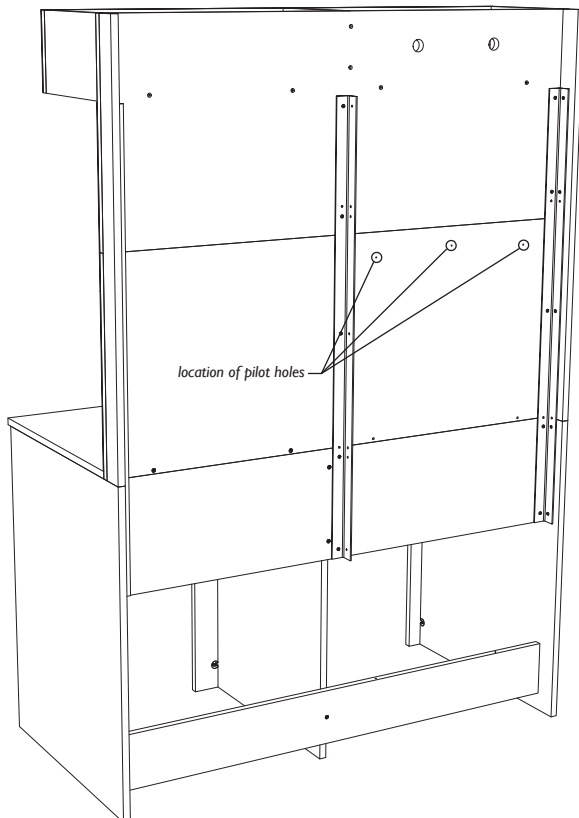

Step 15

If an OTR will be displayed, use an 1/8" drill bit drill and drill through the (3) pilot holes in Back Panel and Graphic Panel.

The display is now complete. Using two people, gently slide the display back into its final location and install the desired product. (3) Pan Head Screws and (3) Small Flat Washers are provided to secure the OTR Mounting Bracket. Use (2) Pan Head Screws if displaying a Hood.

Carefully follow the manufacturer's installation instructions to install product.