

# PET STROLLER

## Installation instructions

For Pets Only

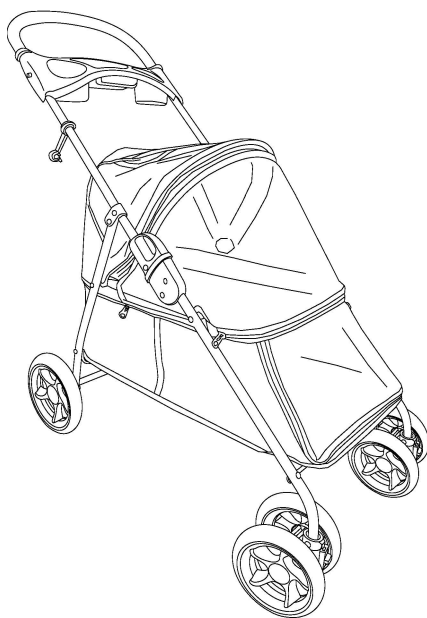

This is not a toy. Under no circumstances should this pet stroller be used by or for children.  
Esto no es un juguete. Bajo ninguna circunstancia este artículo debe ser utilizado por o para niños.

## Components:

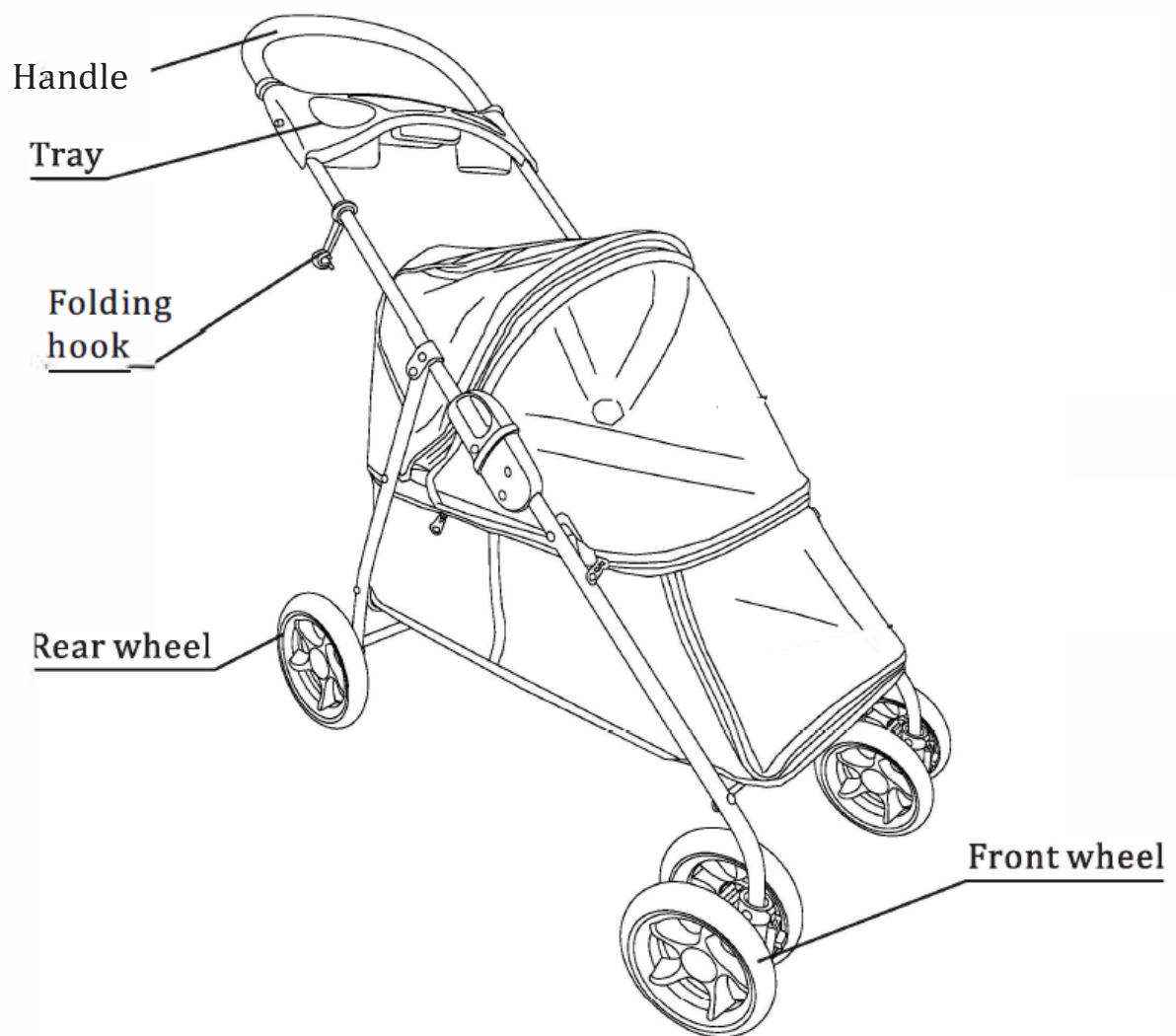

## Assembly:

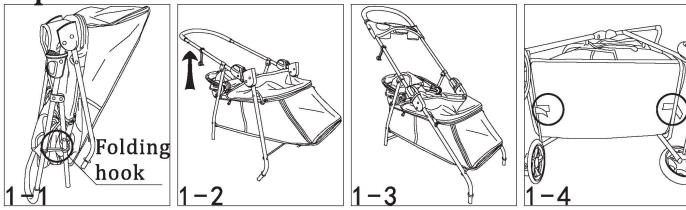

1. Take out the stroller and all components from the carton.
2. Release the folding hook, unfold the stroller in two opposite directions, as shown in picture 1-1, until you hear a "click".
3. Push the handle bar up as picture 1-2.
4. Fasten the safety lock as picture 1-3.
5. Connect the hook and loop fasteners on the bottom as picture 1-4.
6. Unfold the canopy.

## Assemble rear wheels

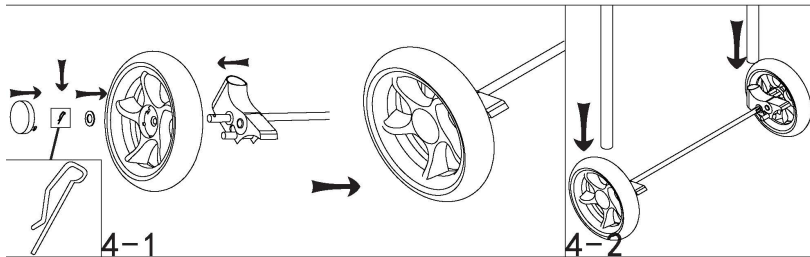

7. To assemble rear wheels: Attach the gear, wheel, washer and insert the clip pin through the axle, then cover with the wheel cap as picture 4-1.
8. Insert the legs of the stroller as picture 4-2.

## Unfold and fold canopy

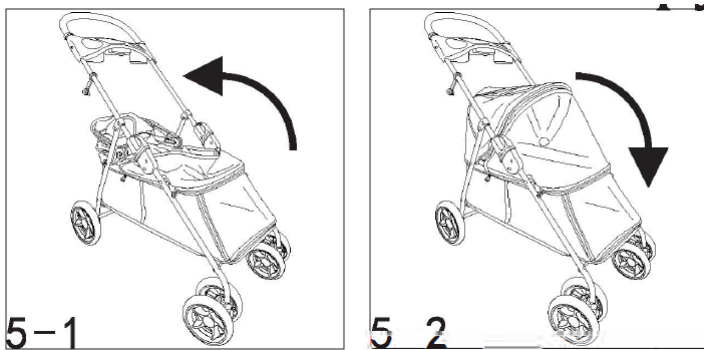

9. Unzip the window and fold the canopy as picture 5-1.
10. Close the canopy as in picture 5-2.

## Assemble front wheels

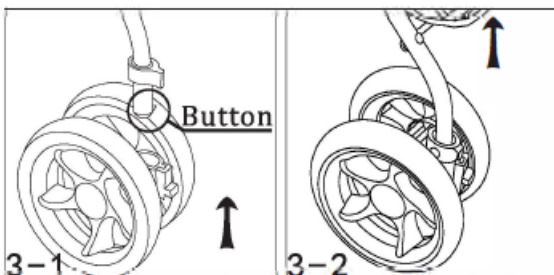

5. Assemble front wheels: Insert each wheel onto the respective leg and push upward until you hear a "click".
6. Disassemble front wheels: Press the plastic button on the leg as picture shown by one hand and pull off the wheels by the other hand.

## Brakes

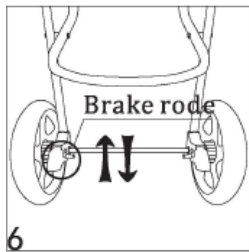

11. To Use the Rear Brakes: Step on the red brake to stop the stroller and push it up to unlock the brake as picture 6.

## Fold the stroller

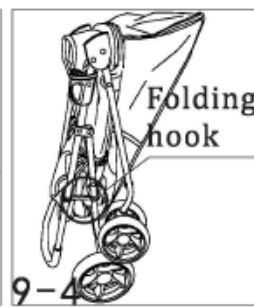
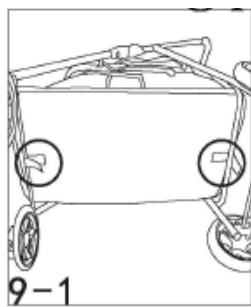

12. First unhook the hook and loop fasteners on the bottom as picture 9-1.
13. Folding the canopy first, pull the bottom basket up as shown in 9-2 image.
14. Press down on the handle as shown in 9-3.
15. Fold the stroller and fasten the folding hook as picture 6-4.

## WARNING

- This is not a toy. Under no circumstances should this pet stroller be used by or for children.
- Not intended to be used as a restraining device for aggressive animals.
- Do not leave your pet unattended while in the stroller.
- Do not use near an open or exposed flame.
- Do not leave pet unsupervised in stroller.
- This stroller is designed for one pet only. Do not place more than one pet in the stroller.
- Do not hang bags from handles, this could cause the stroller to become unstable.
- Do not use on escalator or stairs; always fold the stroller and carry it.
- Put on the brake whenever you park the stroller.
- Ensure stroller is completely vertical and check that all locks are engaged before placing pet in stroller.
- Do not exceed the maximum weight of 44 lbs.
- Failure to follow these warnings and the instructions could result in serious injury or death.

**THIS PAGE  
INTENTIONALLY  
LEFT BLANK**