

**CSLB0102-WHT**

Please read the following instruction carefully and use the product accordingly.

This summary may not include every detail of all variations and considered steps. Please contact us when further information and help are needed.

### **Warnings**

It's best to use a manual screw driver to tighten screws to avoid over tightening and potential cracking.

**This product must be fixed to the wall tightly to avoid personal injury caused by falling or tilting. Check and make sure it is securely anchored before use.**

It is not intended for use by children under 5 years of age. Children must be under adult supervision to use the product. It is forbidden for children to climb or play on the product to avoid serious body injury by the toppling. During the assembly process, keep any small parts out of the reach of children. It may be fatal if swallowed or inhaled. To avoid the potential dangers of suffocation, please keep all parts and packaging away from babies and children.

### **Notes**

It is recommended to be assembled by 2 adults. Please read the assembly instructions before assembly and adhere to each step outlined.

This item is only intended to be used indoors. Personal injury and/or damage to product may occur if products are used outside of their intended purposes and/or if products have been changed or modified from their original design. The product must be assembled and used in accordance with provisions of the manual.

Please assemble the item in spacious room and do not place the unwrapped product directly on the ground to avoid damage. It is recommended to wear gloves in the assembly to avoid scratch by the sharp edges.

It is not allowed to stand, sit or put heavy stuff on the wooden boards or other parts before the assembly to avoid the crack or distortion of the wooden boards. The crack or distortion will affect the assembly and normal use.

Periodically inspect screw tightness while the product is in use. If necessary, retighten to ensure structural integrity.

Do not expose this product to direct sunlight or rain. Never touch with sharp objects or corrosive chemicals, which may spoil the surface of the item.

For daily care, please clean with a damp cloth then immediately wipe dry.

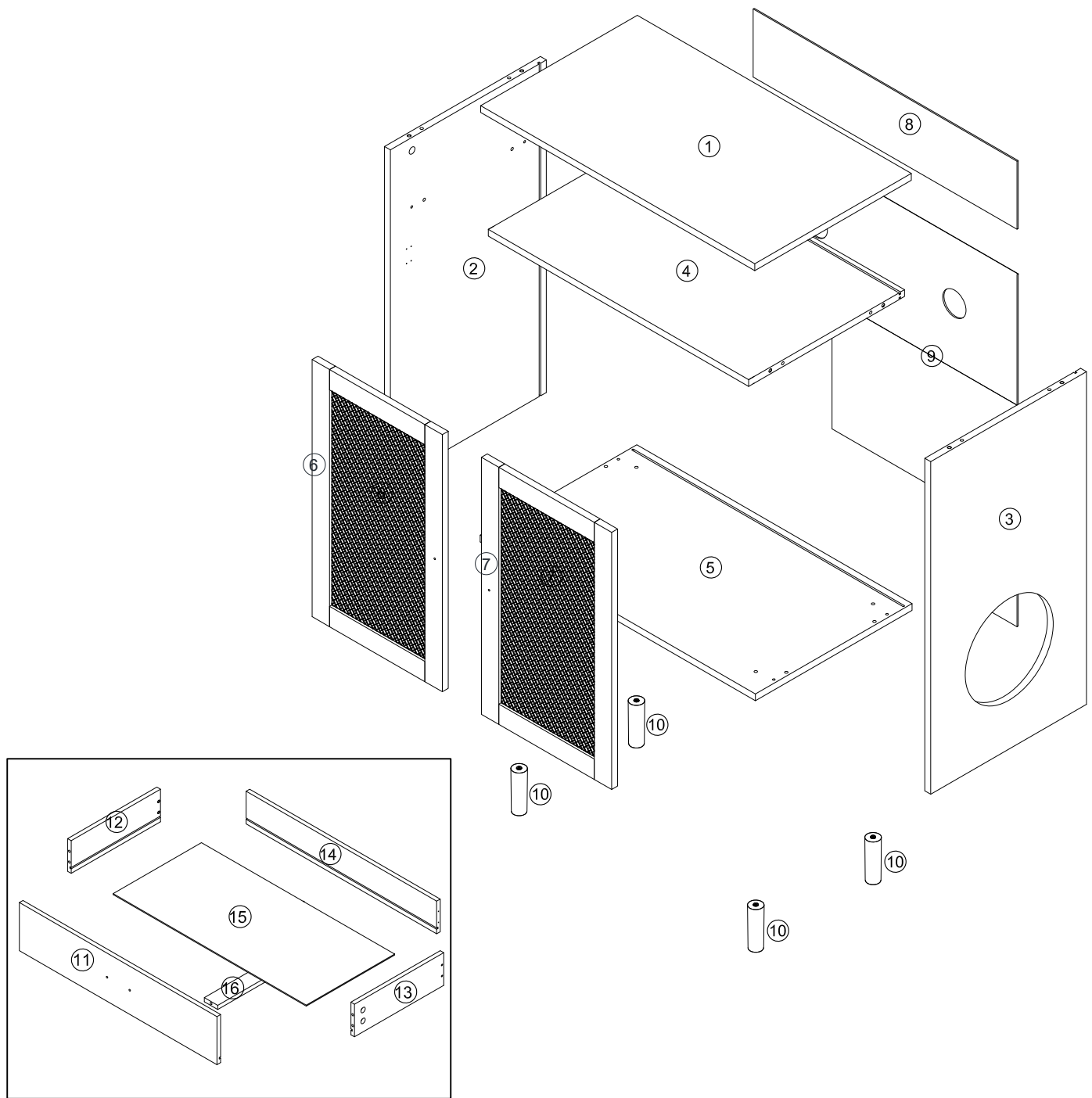

|    |  |       |       |
|----|--|-------|-------|
| A  |  | M6x35 | 13PCS |
| E  |  | M3x12 | 8PCS  |
| I  |  | M3x12 | 2PCS  |
| M  |  | M3x12 | 4PCS  |
| Q  |  | M4x14 | 1PC   |
| U  |  | M4x14 | 24PCS |
| DR |  | M4x14 | 1PC   |

|    |  |        |       |
|----|--|--------|-------|
| B  |  | M15x10 | 13PCS |
| F  |  | M4x12  | 2PCS  |
| J  |  | M3x14  | 8PCS  |
| N  |  | M4x25  | 2PCS  |
| R  |  | M4x20  | 2PCS  |
| V  |  | M3x12  | 2PCS  |
| DL |  | M4x20  | 1PC   |

|    |  |       |       |
|----|--|-------|-------|
| C  |  | M6x30 | 12PCS |
| G  |  | M4x30 | 2PCS  |
| K  |  | M4x30 | 5PCS  |
| O  |  | M4x30 | 2PCS  |
| S  |  | M4x30 | 1PC   |
| CL |  | M4x30 | 1PC   |

|    |  |       |      |
|----|--|-------|------|
| D  |  | M4x40 | 4PCS |
| H  |  | M4x35 | 2PCS |
| L  |  | M6x40 | 4PCS |
| P  |  | M4x30 | 1PC  |
| T  |  | M4x30 | 4PCS |
| CR |  | M4x30 | 1PC  |

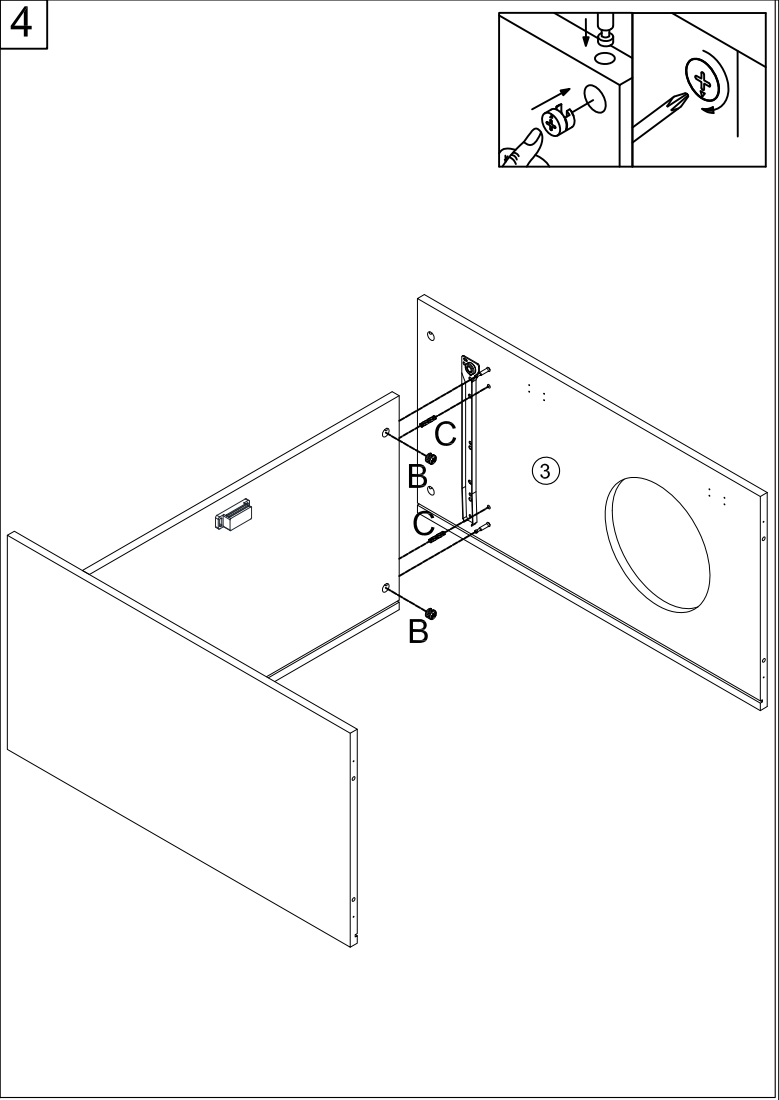
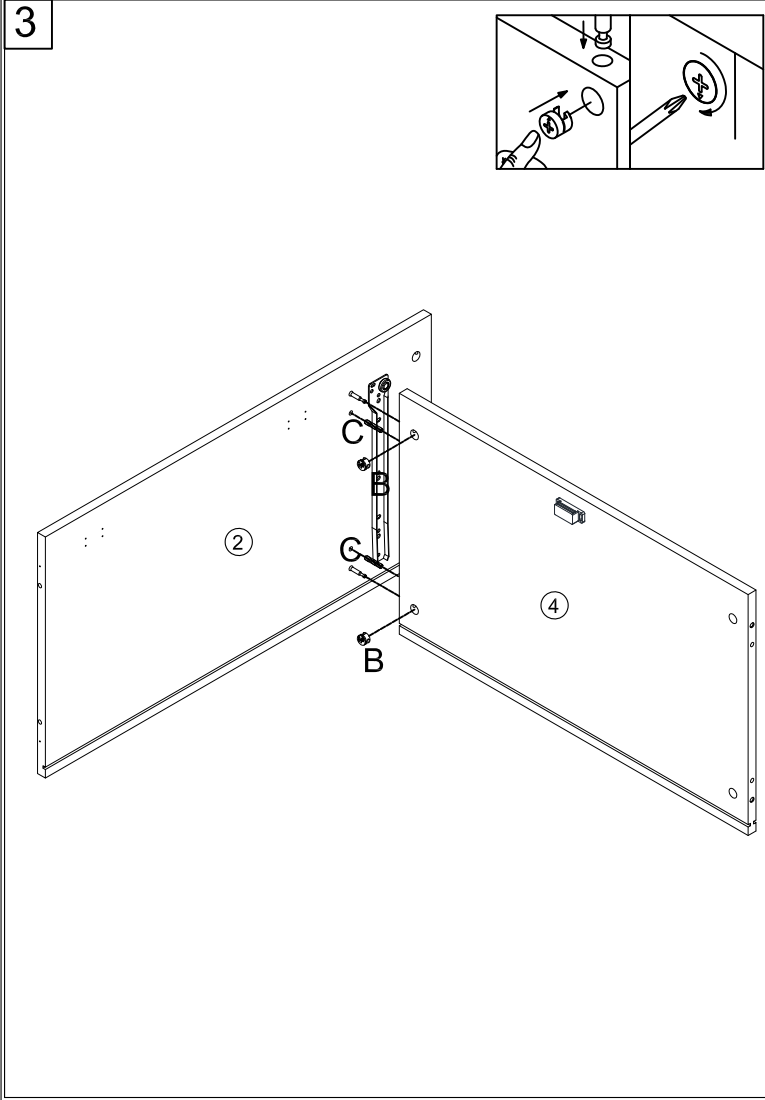
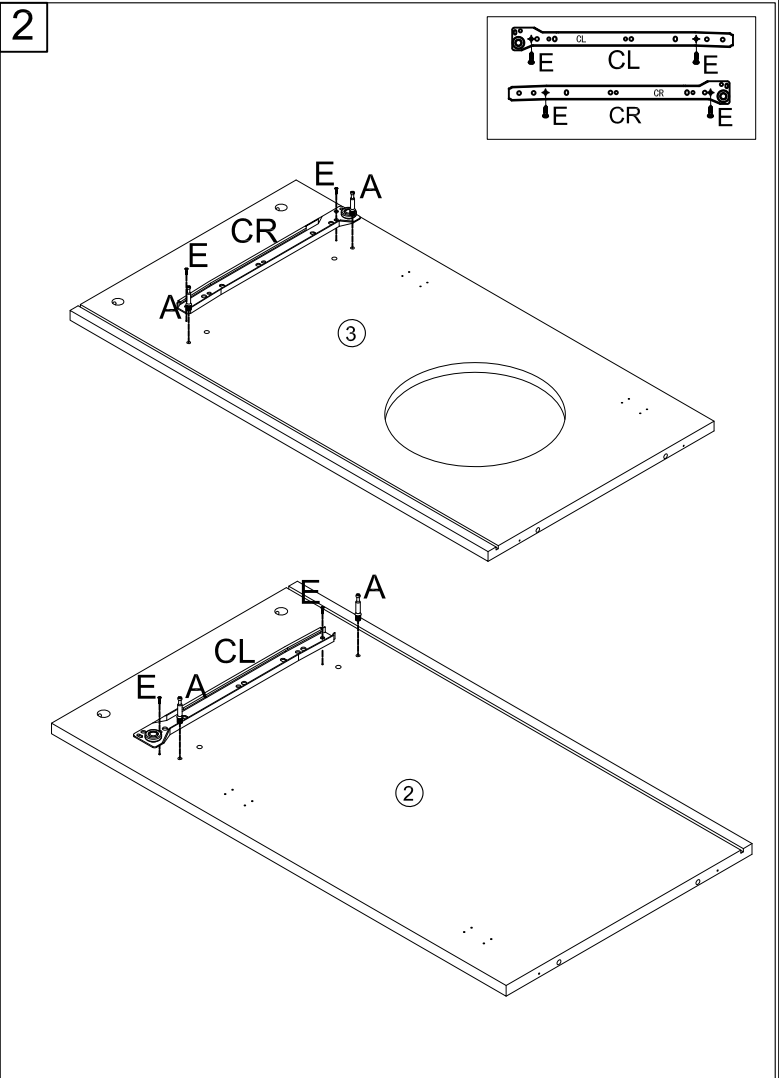
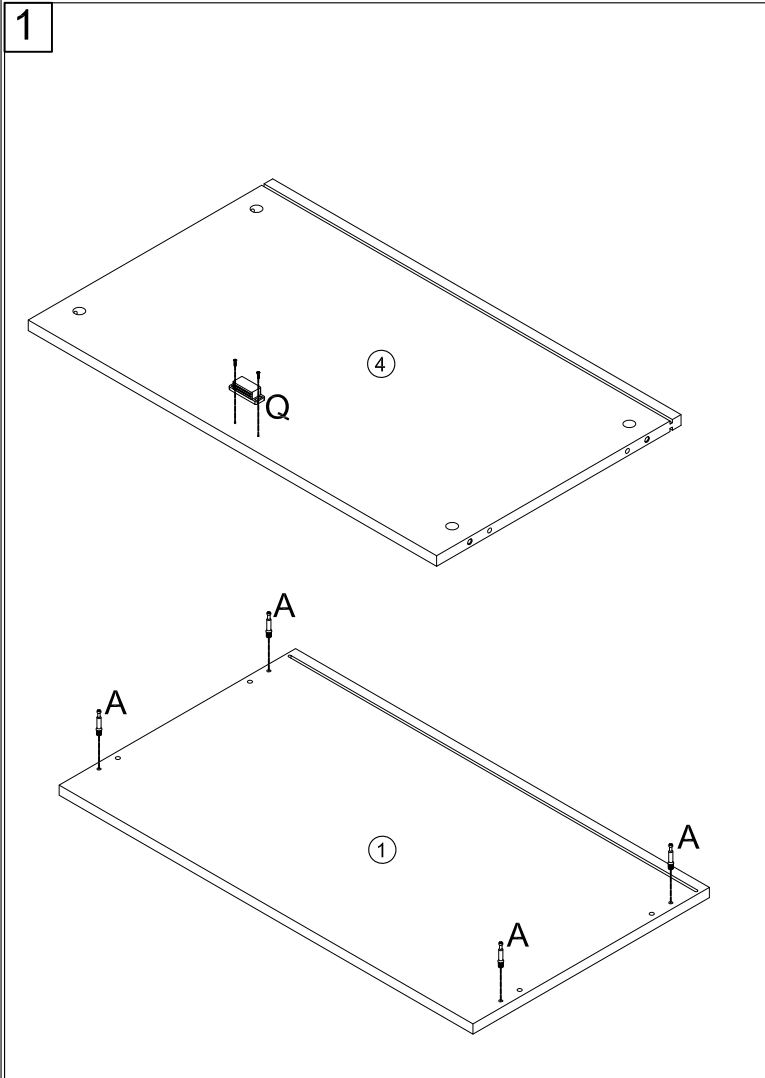

5

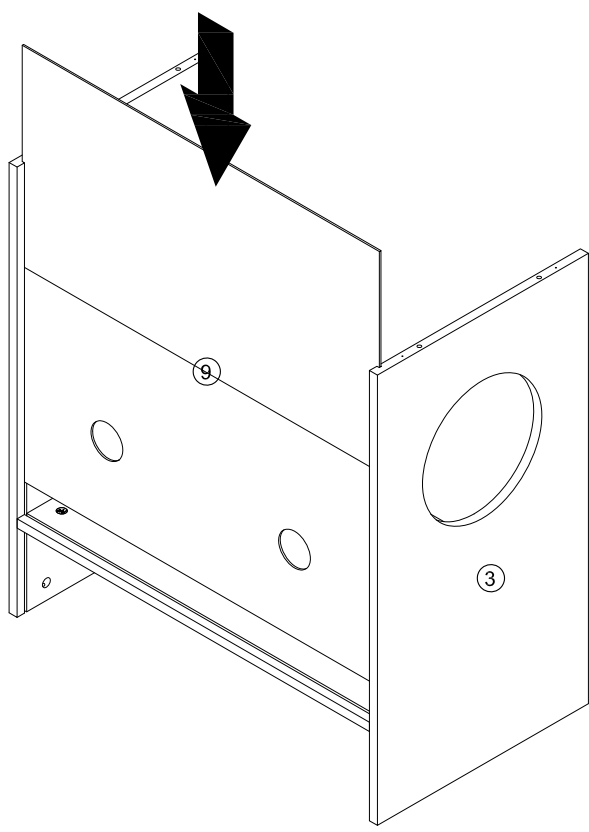

6

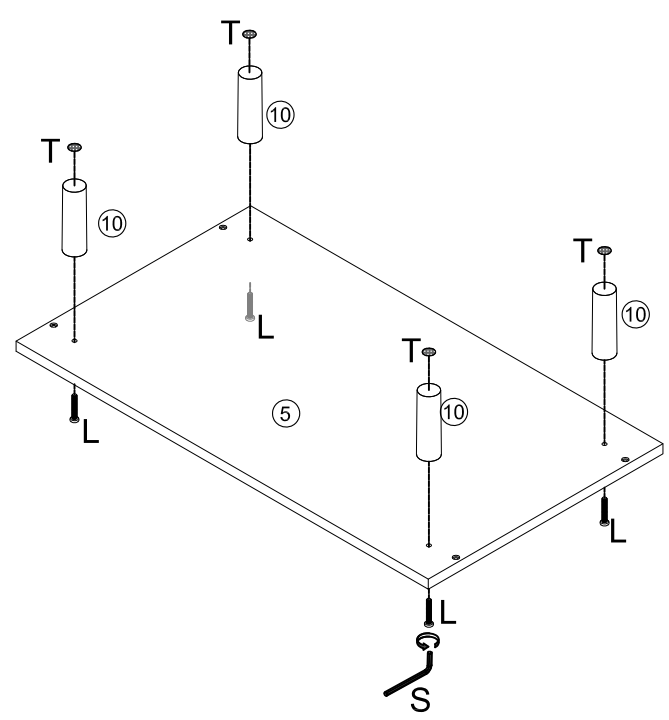

7

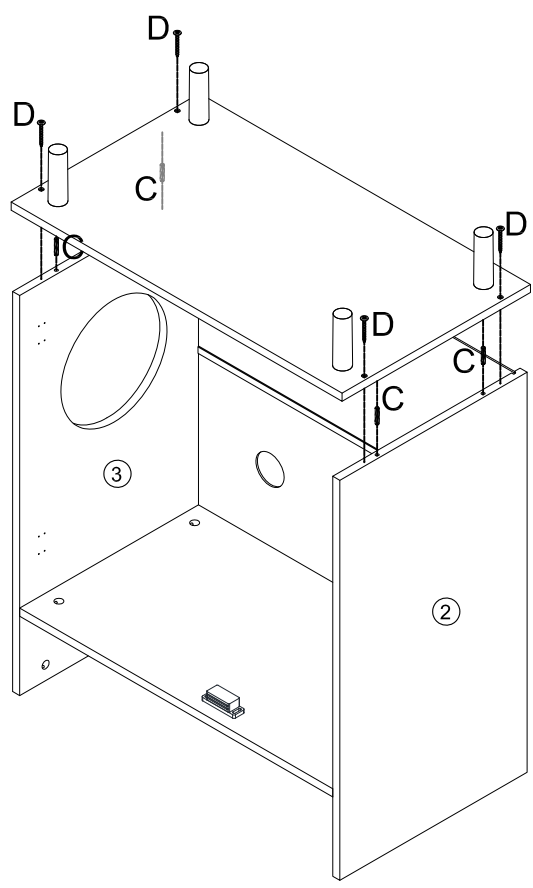

8

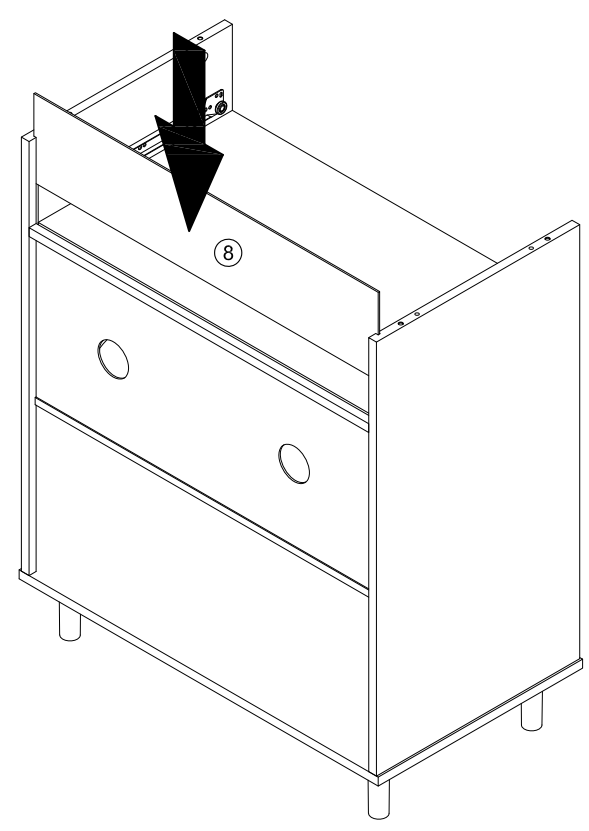

9

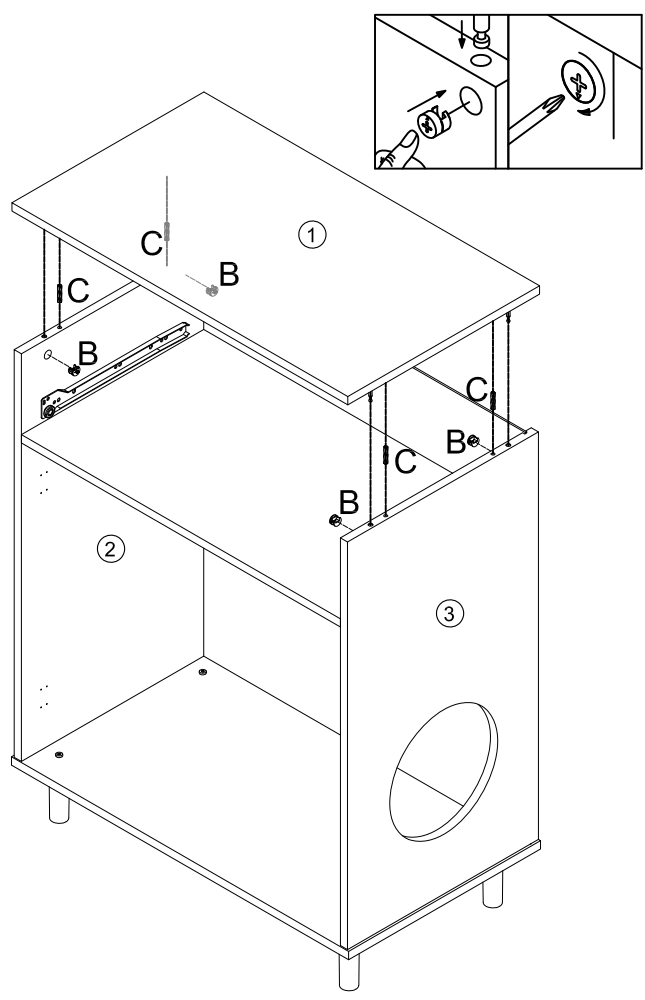

10

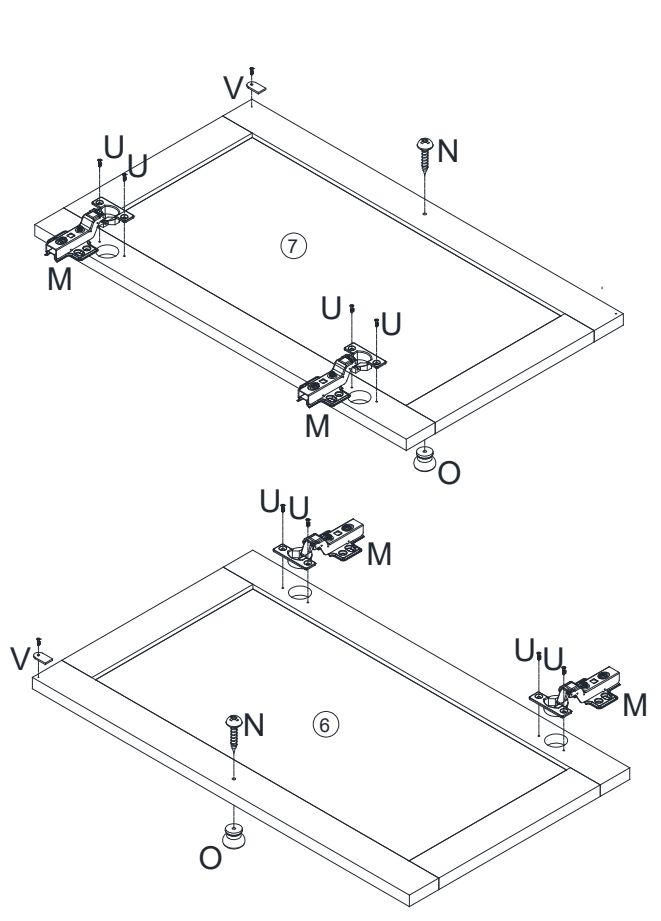

11

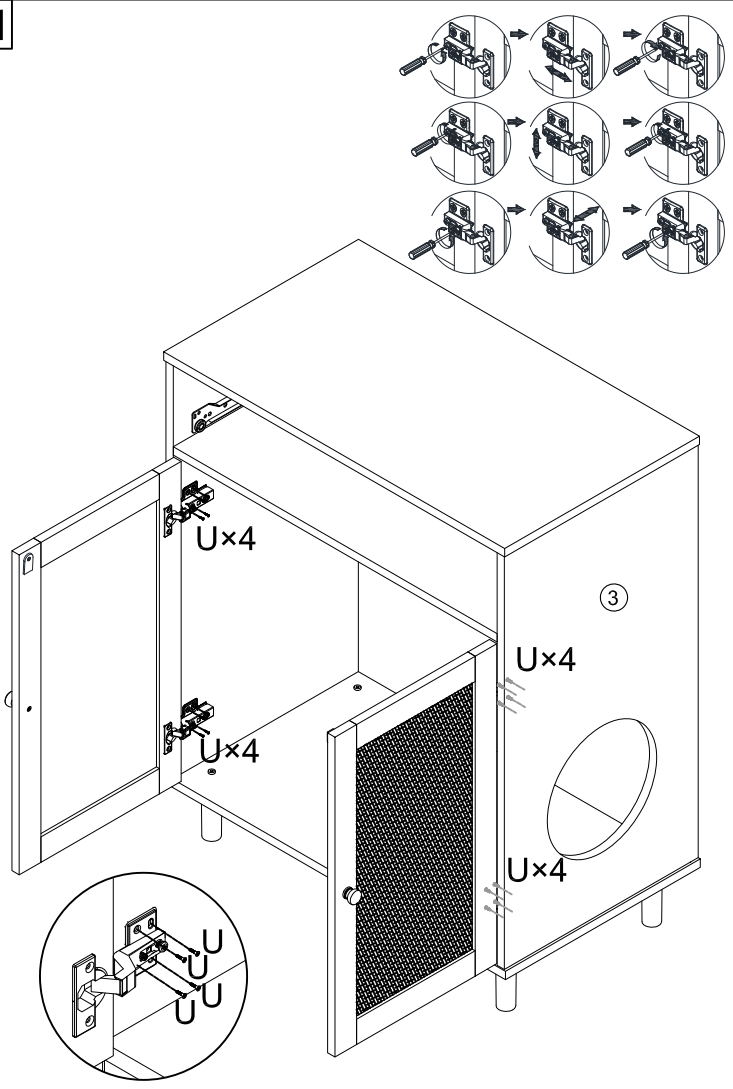

12

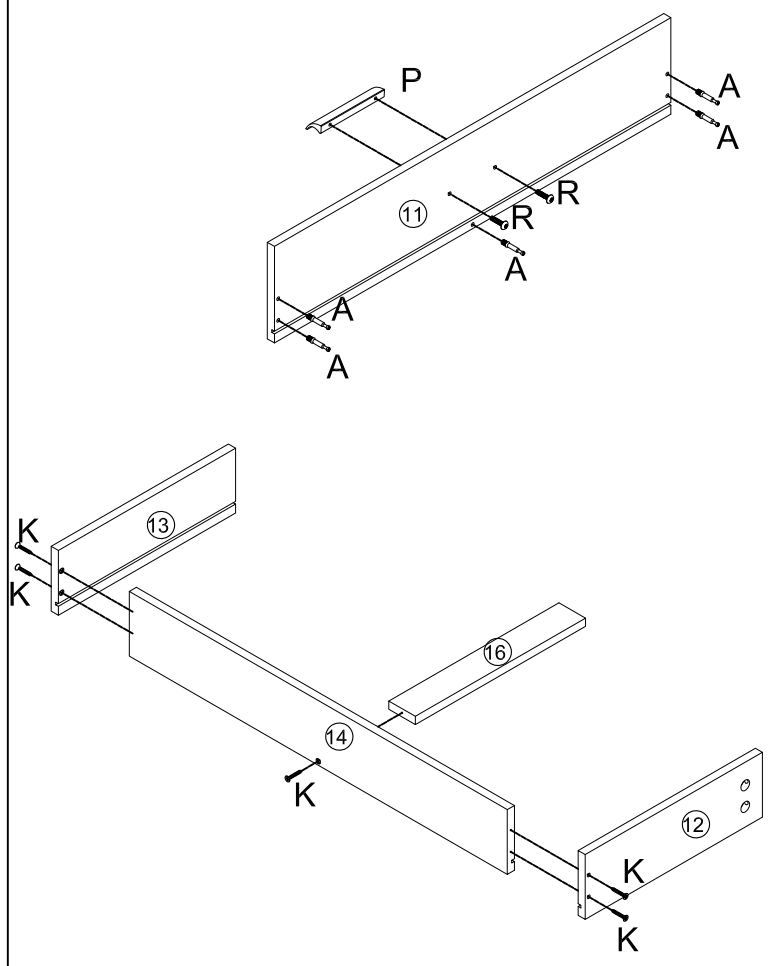

13

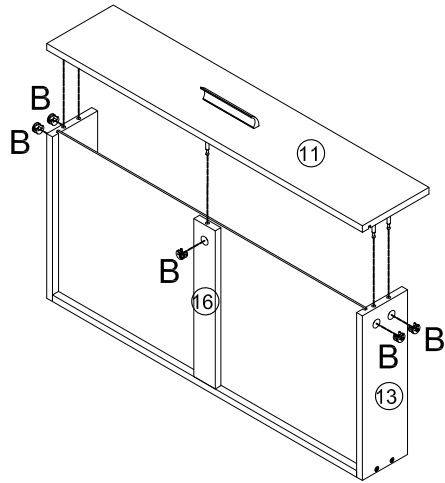
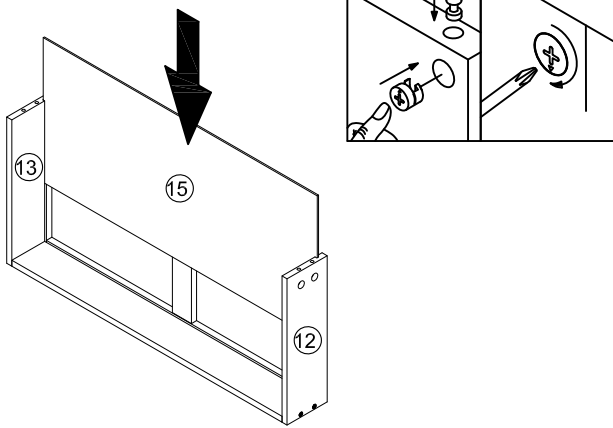

14

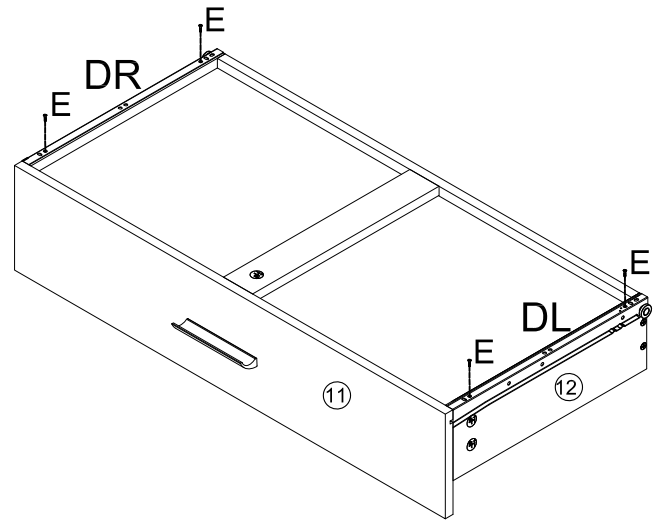
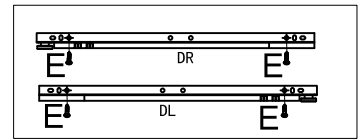

15

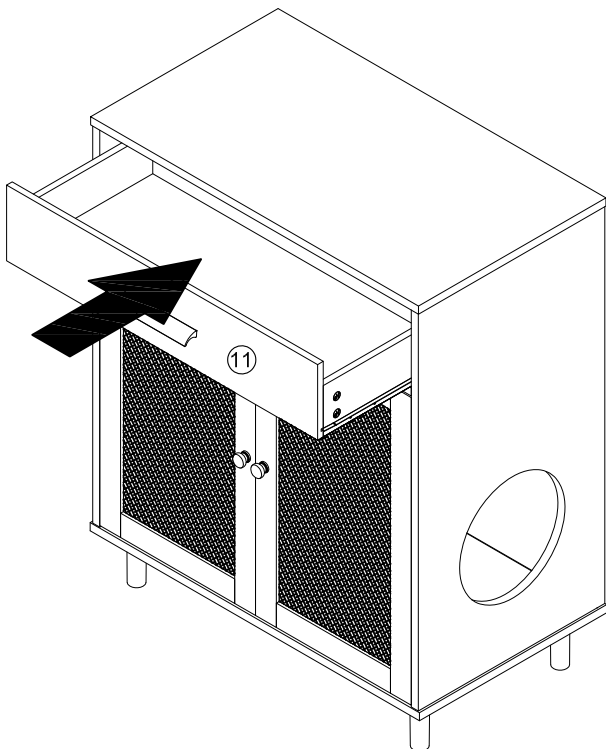

16

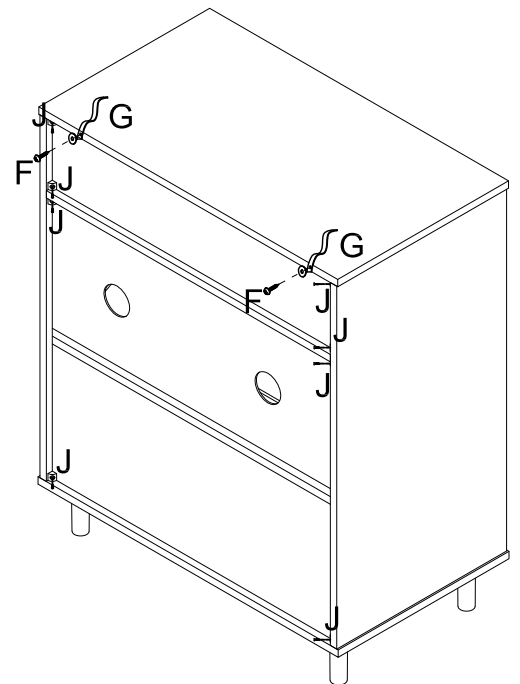
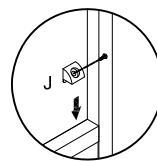
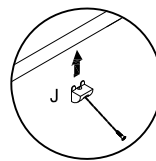

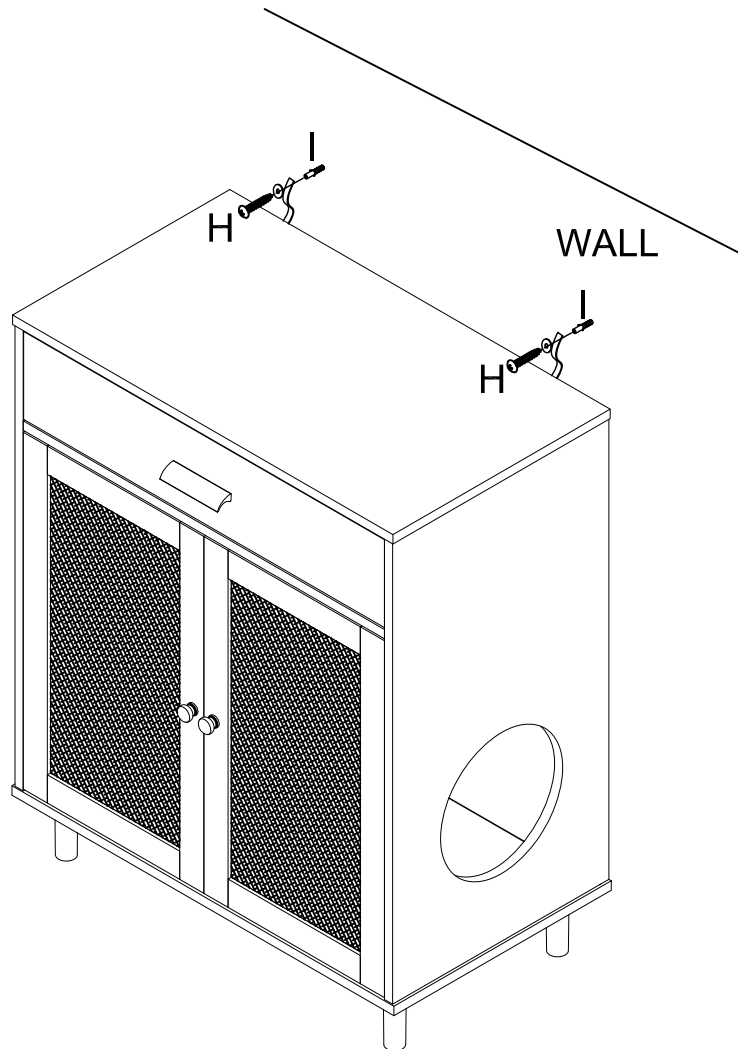



# Critter Sitters

## 1-Year Limited Warranty Program

For a period of one (1) year after purchase, Critter Sitters ("Manufacturer") will either repair or replace defective components in accordance with this Limited Warranty. This warranty is between Manufacturer and the original purchaser and is valid only when accompanied by the original purchaser's sales receipt showing original date of purchase and location of purchase. Replacements under this warranty revert back to the date of original purchase for future warranty.

Manufacturer or its authorized dealer can accept or reject warranty claims based on its findings. This warranty applies in normal residential use only and is not intended for commercial use. Manufacturer can make substitutions as required of materials, components, and sub-components of comparable value and utility. This warranty is limited to product repair or replacement (to be determined solely by Manufacturer). Warranty return is limited to only the single affected component.

This warranty covers only manufacturing defects and does not cover normal wear and tear, abuse or misuse, exposure to extreme heat or cold, abrasion or excessive weight. This product is intended to be used in standard installations only. This warranty is invalid if the product is not used for intended purpose. Manufacturer disclaims liability for any aspect of installation and any inconvenience caused by a defective part of a component.

Certain items are not covered by this warranty. These include, but are not limited to the following:

1. Components subjected to abuse, including abuse intended to simulate failure.
2. Damages caused by retailer, shipper or installation crew (such as scratches, dents, tears, chips, etc.).
3. Any part which merely exhibits normal wear yet functions essentially as new, including chips, scratches or stretching of materials and stitching.
4. Tears, punctures, scratches or any damage caused by improper installation or use.
5. Damage to frames/welds resulting from improper assembly is not covered. General frame rusting is not covered.
6. Fading and/or discoloration of fabrics resulting from exposure to the elements, chemicals, oils, fluids or any other cause are not covered.

To make a claim, call the toll-free number below. Please have available a copy of the original sales receipt along with a brief description of the problem. Please also provide your email address and daytime telephone or cell phone #. All items may be charged actual freight costs plus \$15 for handling. Repairs or replacement will be made at the Manufacturer's option. ***Sales and use taxes, plus shipping and handling charges are the responsibility of the consumer.***

**THIS IS THE ENTIRE EXCLUSIVE EXPRESS LIMITED LIABILITY. THE MANUFACTURER NEITHER MAKES NOR IS RESPONSIBLE FOR ANY OTHER WARRANTIES, EITHER EXPRESS OR IMPLIED, INCLUDING THOSE OF RETAILING DEALERS. THIS EXCLUSIVE REMEDY IS LIMITED TO RECEIPT OF A CREDIT IN CONNECTION WITH THE REPAIR OR REPLACEMENT OF ANY PRODUCT OR COMPONENT DEEMED TO BE DEFECTIVE UNDER THE TERMS AND CONDITIONS AS STATED IN THIS WARRANTY. NEITHER CRITTER SITTER PRODUCTS, THE PRODUCT MANUFACTURER NOR ITS AGENTS SHALL BE LIABLE IN ANY CASE FOR INCIDENTAL, INDIRECT, SPECIAL OR CONSEQUENTIAL DAMAGES RESULTING FROM THE USE OF THIS PRODUCT OR ARISING OUT OF ANY BREACH OF THIS WARRANTY OR NEGLIGENCE EVEN IF IT HAS BEEN ADVISED OF THE POSSIBILITY OF SUCH DAMAGES. EXCEPT AS OTHERWISE MAY BE REQUIRED BY LAW, THERE ARE NO OTHER EXPRESS OR IMPLIED WARRANTIES OTHER THAN THE WARRANTY DESCRIBED HEREIN, AND ALL OTHER WARRANTIES, INCLUDING ANY IMPLIED WARRANTY OF MERCHANTABILITY OR FITNESS FOR A PARTICULAR PURPOSE ARE EXPRESSLY DISCLAIMED.**

**Contact Warranty Services at  
1-888-840-4557 or  
Luv@MyCritterSitters.com**