

User Guide

SW800 TITAN WIRELESS

Battery Powered PA System



READ FIRST ABOUT BATTERY OPERATION!

BY OBSERVING A FEW SIMPLE RULES, YOU CAN EXTEND THE LIFESPAN OF THE SEALED LEAD ACID (SLA) BATTERIES THAT OPERATE YOUR AMPLIVOX BATTERY POWERED PORTABLE PA SYSTEM OR ACCESSORY:

- ALWAYS STORE SLA BATTERIES IN A CHARGED CONDITION WHEN REMOVED FROM SERVICE.
- FOR SLA BATTERIES IN STORAGE, APPLY A TOPPING CHARGE EVERY SIX MONTHS.
- AVOID REPEATED DEEP DISCHARGES. THIS PRACTICE WILL CUT THE LIFE OF THE BATTERY SIGNIFICANTLY.
- AVOID OPERATING SLA BATTERIES AT ELEVATED AMBIENT TEMPERATURES.
- BATTERY STATUS INDICATOR - RED = NO BATTERY POWER, YELLOW = ABOUT 3 HOURS LEFT. CHARGE BATTERY OVERNIGHT FOR BEST RESULTS.



Photo may appear different than your actual unit.

Thank you for choosing the **SW800 TITAN** from *AmpliVox Sound Systems*.

We are excited in introducing this truly unique system. Our system combines flexibility with functionality. Please refer to this user guide as you enjoy the unique capabilities of another quality product from *AmpliVox Sound Systems*.

We encourage you to visit our website **www.ampli.com** to register your product for its warranty coverage, sign up to receive our newsletter, download our catalog, and learn more about the complete line of *AmpliVox* audio visual products, including portable PA systems, and lecterns.

TABLE OF CONTENTS

GETTING STARTED/QUICK SETUP.....	3
CONTROL / BACK PANEL	4
OPERATION	4
FUSE.....	5
AUDIO FUNCTIONS	5
WIRELESS PANEL RECEIVER	6
WIRELESS BODYPACK TRANSMITTER.....	6
WIRELESS HANDHELD MICROPHONE.....	6
BLUETOOTH RECEIVER.....	7
WIRELESS SPEAKER TRANSMITTER.....	8
OPTIONAL ACCESSORIES	10
TROUBLESHOOTING	10
WARRANTY	11

IMPORTANT SAFETY INSTRUCTIONS

Before using this product, read the instruction manual for important safety information. Please retain this manual for future reference and warranty information.

Troubleshooting & Servicing

Do not attempt to service or repair the device yourself. Refer all servicing to qualified service personnel. Do not attempt to modify the device in anyway. Doing so could invalidate your warranty.

Cleaning

When cleaning the device, please use a soft, dry cloth. Never use benzene, paint-thinner, or other chemicals on the device.

Location

Place the device in stable location, so it will not fall causing damage to the device or bodily harm.

Intended use

The product may only be used with the original parts intended for it. The intended use includes adherence to the specified installation instructions. The manufacturer accepts no liability for damage arising due to improper use.

WARNING: Changes or modifications to this unit not expressly approved by the party responsible for compliance could void the user's authority to operate the equipment.

IMPORTANT

This device complies with Part 15 of the FCC Rules. Operation is subject to the following two conditions: (1) This device may not cause harmful interference, and (2) this device must accept any interference received, including interference that may cause undesired operation.

The unit's circuitry may cause interference to nearby radios. To prevent interference, either switch the unit off or move away from the affected radio.

NOTE: This equipment complies within the limits for a class B digital device, pursuant to Part 15 of the FCC Rules. These limits are designed to provide reasonable protection against harmful interference in a residential installation. This equipment generates, uses and can radiate radio frequency energy and, if not installed and used in accordance with the instructions, may cause harmful interference to radio communications. However, there is no guarantee that interference will not occur in a particular installation. If this equipment does cause harmful interference to radio or television reception, which can be determined by turning the equipment off and on, the user is encouraged to try to correct the interference by one or more of the following measures:

- Increase the separation between the equipment and receiver.
- Connect the equipment into an outlet on a circuit different from that to which the receiver is connected.
- Consult the dealer or an experienced radio / TV technician for help.

NOTE: Shielded cables may be required to be used with this unit to ensure compliance with the Class B FCC limits.

California Prop 65

WARNING: This product contains chemicals known to the State of California to cause cancer, birth defects, or other reproductive harm.

Getting Started/Quick Setup (Also Printed on Battery Cover)

- **POWER** - Push **POWER** switch (middle of panel) to **ON** . All accessories have separate **ON / OFF** power switches.
- **WIRELESS MIC** - Turn volume dial clockwise to turn on. Select channel using the up/down buttons. Turn Handheld Microphone or Bodypack on and set to same channel. Channel must match channel on microphone and receiver.
- **BLUETOOTH PLAYER** - Turn volume dial clockwise to turn on.
- **WIRED MICROPHONES**: Up to 2 wired XLR type microphones can be used. Separate Volume control for each microphone to adjust sound.
- **LINE IN**: (1/8" jack) Use for plugging other Audio Devices into PA.
- **LINE OUT**: (1/4" jack) Use for sending Audio out to external PA or recording devices.
- **EXT SPKR**: (1/4" jack) Use for connecting a non-powered passive speaker.
- **3 LED's** provides battery information. Charge 24 hours before first use.
GREEN – Fully charged, **YELLOW** – Half level, **RED** – Low charge.



Retractable Handle



AC/DC Adapter



Photo may appear different than your actual unit.

SW800 SPECIFICATIONS

Speakers:	8 inch Woofer, 1 inch Compression Horn Tweeter	Sensitivity for rated output:	
Rated Power Output:	100W (RMS) 150W (Peak)	Wired Microphone Input:	(2) XLR
Sensitivity:	110dB @ Full Volume	Equalization (tone):	Separate Bass and Treble
Frequency Response:	20Hz to 20Khz	Line output:	1/4" Unbalanced
Battery (SLA Type):	(2) 12 volt, 7 AH, rechargeable, User accessible and replaceable	Weight:	35 lbs.
Charging Time:	Full charge 10 hours	Dimensions (HWD):	23in.H x 11.5in. W x 11in. D
Operating Time:	Average 6-10 hours	Warranty:	3 Years 1 Year on Batteries, Transmitters, Microphones, and accessories.
AC/DC Power Adapter:	110-220 Auto sensing, 50/60 Hz. 24V Output, 5A		
Wireless Frequency:	584– 608 MHz		
Wireless Range:	Up to 250 Feet		

CONTROL / BACK PANEL



OPERATION

Photo may appear different than your actual unit.

CHARGING BATTERIES: To charge the batteries, connect the PA to 110-220VAC using the supplied AC/DC Adapter. The **GREEN LED** will be illuminated indicating battery is charging. The batteries will charge when unit is operating with AC power, **HOWEVER the unit will charge faster with the power switch in the "off" position.**



PLEASE NOTE: THE SW800 SHOULD BE STORED FULLY CHARGED WHEN NOT IN USE TO MAXIMIZE BATTERY LIFE. RE-CHARGING THE UNIT ONLY WHEN THE BATTERY STATUS LIGHT IS YELLOW OR RED WILL SHORTEN THE USEFUL LIFE OF THE BATTERIES.

POWER SWITCH: ① (SEE PAGE 5) When power switch is in the **ON** position, a **CHARGING / BATTERY STATUS LIGHT** ② will be illuminated. The color of the **LIGHT** indicates the condition of the battery.
Red – battery low, recharge immediately; **Yellow** – battery should be recharged before use. **Green** - fully charged.

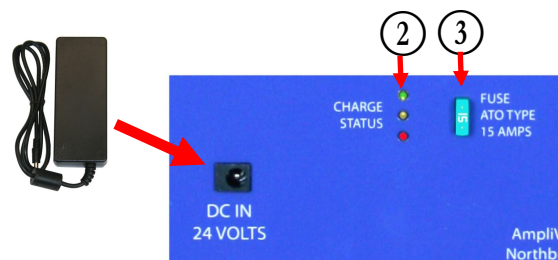

FUSE

FUSE: There is a fuse located in the Back Panel labeled **FUSE ③** (SEE PAGE 4).

Detach the AC adapter cord and battery connections before replacement.

This fuse protects the AC circuitry. Use finger tips, a fuse puller or flat nose pliers to pull the fuse out. Replace the fuse with an ATO Type (Blade Fuse—Automotive) **15 amp / 32VDC (Blue Color)** fuse if needed.

Again, detach the AC adapter cord and battery connections before replacement.

If after replacing the fuse, the SW800 does not “power on”, please call AmpliVox Customer Service at 800-267-5486.

AUDIO FUNCTIONS

- ④ **WIRED MICROPHONE INPUTS:** Two XLR type, MIC 1 and MIC 2. Each has its own volume control that allows you to adjust sound level of the plugged-in microphone.
- ⑤ **LINE IN INPUTS:** Add pre-recorded music or audio to your presentations from an external source. Connect using the 1/8" (3.5 mm) connector. A separate **LINE IN VOLUME CONTROL** is also provided for controlling sound level of the external source.
- ⑥ **AUDIO CONTROLS:** **BASS:** This control cuts or boosts the bass level. **TREBLE:** This control cuts or boosts the treble level.
- ⑦ **LINE OUTPUT:** A 1/4" connector is provided for connecting to other equipment. **LINE OUT** can be used to drive an external recording device or AmpliVox S1297 Powered Speaker. The advantage to this configuration is that the external system's own EQ & volume settings can be separately adjusted to suit its environment and the two systems do not interact with each other.
- ⑧ **EXTERNAL SPEAKER:** A 1/4" connector is provided for connecting to **PASSIVE SPEAKERS (NON-POWERED)**.
- ① **POWER ON / OFF SWITCH**

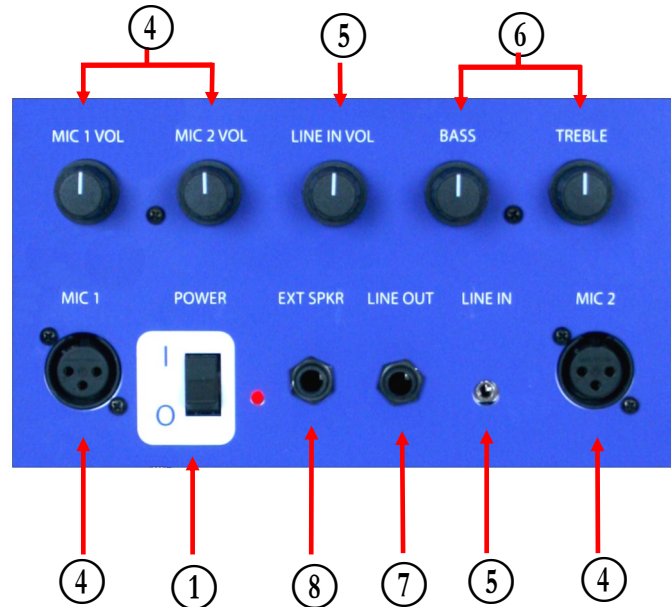

BLUETOOTH PLAYER

- Turn Volume/Power knob clockwise to turn on Bluetooth receiver. PWR and LINK LED's will illuminate. Will automatically enter into pairing mode.
- While in pairing mode turn on your Bluetooth device for pairing. On your Bluetooth menu look for “Portable PA”. May ask to use Pincode# 0000. Once paired the PWR and LINK LED's will remain on.



16 CHANNEL UHF WIRELESS

WIRELESS RECEIVER PANEL

- Channel Display (A)
- RF - Radio Frequency Indicator (B)
- AF - Audio Frequency Indicator (C)
- ASC / IR Auto Channel Select (Handheld Only) (D)
- Select Buttons - Manual Channel Selection (E)
- Mute Level Adjustment (F)
- Volume Control (G)

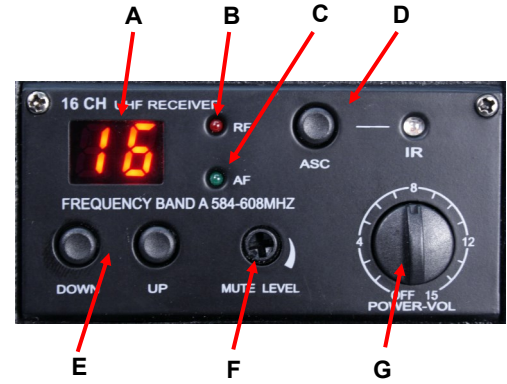

RECEIVER / TRANSMITTER SETUP:

- The receiver has its own **POWER / VOLUME** Control (G). First make sure that you have screwed on the UHF antenna. Turn Power On. A Frequency Channel will appear in the Channel Display (A). Press Select Buttons (E) to select a channel. Channel number must match channel number on wireless transmitter.
- The transmitter bodypack is operated by 1 - "AA" 1.5 Volt alkaline battery. Slide off battery cover (H) and install battery as shown. Make certain the battery is fully seated in its compartment so the cover slides in place easily. Battery life with alkaline batteries is approximately 8 hours of operating time.
- Select a channel (1-16) on side panel (I) using the supplied screw driver to select channel number. Channel selected should match channel on receiver. When transmitter and receiver are set to correct channel the RF indicator (B) will glow red when transmitter is turned on.
- Plug the Lapel / Headset microphone into the Mic Input Jack (K). The microphone can be clipped to a necktie or other clothing, using the supplied clip. The lapel mic should be placed under the chin, as close to the center of the body as possible.
- Slide the power **ON / MUTE / OFF** switch (J) to the **ON** position (the LED indicator light will illuminate green). Replace batteries when this LED turns red.
- **MUTE LEVEL (F)** is set to lowest threshold (fully counter-clockwise) when it leaves the factory. If speaker sound is experiencing loud white noise interference bursts due to environmental interference, and no other clear channel is available, slowly turn the **MUTE** level (F) clockwise with small screwdriver until white noise sound is muted. This operation is done with all wireless microphones and bodypack transmitters turned off until **MUTE** level adjustment is complete. This also effects transmitter distance.
- **GAIN SWITCH (L)**: If you are a soft spoken person then set the switch to the **10 dB** position. If you are a loud speaking person then set the switch to the **-10 dB** position. Adjust to prevent distortion while speaking.

Wireless Transmitter - Bodypack



WIRELESS HANDHELD MICROPHONE—MODEL S1695

If you are using the AmpliVox S1695 Wireless Handheld Microphone Transmitter, screw off the lower bottom section of microphone and insert 2 - "AA" 1.5 Volt alkaline batteries.

IMPORTANT: Because the microphone has an **AUTO SYNC** function, you first select channel you wish to use on the receiver. Then press the ASC button (D), the IR light will start to flash. Turn on microphone and point end (6) of microphone at the flashing IR light on receiver and the microphone will auto sync to the same channel as selected on the receiver.

BATTERIES

1. Hold the body of microphone in hand and twist off bottom section of microphone.
2. Insert two "AA" batteries.
3. Twist bottom section back on to microphone.

BATTERY STATUS

The life expectancy of the two batteries is about 10 hours. When the "BATTERY" symbol on the display screen keeps flashing the batteries should be replaced immediately.

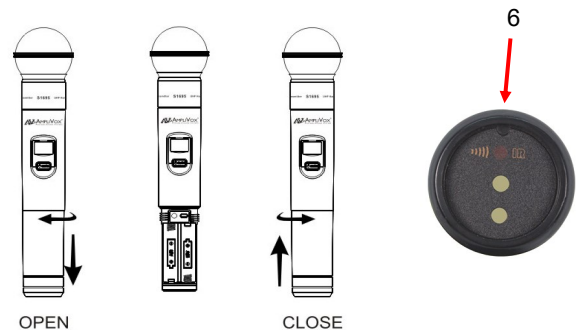

Microphone Operation and Status Display

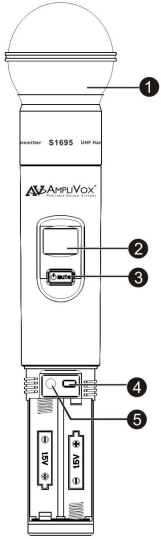

BATTERY COVER REMOVED

Functions

- 1) **Interchangeable Microphone Head**
- 2) **LCD Screen**
- 3) **Power / Mute Control Switch**
- 4) **Select Button**
- 5) **Microphone Input Sensitivity Adjustment**—is used to set the gain of microphone. If you are a soft talking speaker you will need to turn the control counter clockwise. Turn clockwise if you are a loud talker. Use plastic screwdriver that is supplied.



- **TURN ON MICROPHONE:** Press and hold the “POWER/MUTE” (3) button until LCD screen lights up.
 - **TO MUTE:** Press “POWER/MUTE” button twice to MUTE. Channel number will flash when muted. Press button again twice to remove “MUTE”.
 - **TURN OFF MICROPHONE:** Press and hold the “POWER/MUTE” (3) button for 2 seconds to turn microphone “OFF”.
-
- **SELECT CHANNEL (Manual):** Press and hold the “SELECT” (4) button for 2 seconds until you only see the word Channel and channel number. To change channel, when flashing, press the “SELECT” (4) button until you reach the desired channel. Flashing will stop after 10 seconds and channel is now set.
-
- **LOCK / UNLOCK CHANNEL:** Press the “POWER/MUTE” (3) button and “SELECT” button at the same time to lock or unlock channel. When locked, channel cannot be changed. “LOCKED” symbol appears in upper left-hand corner.

ACCESSORIES



S1995 Outdoor Protective Cover.

Protect your speaker from the elements with the **S1995 Outdoor Protective Cover**. Designed for temporary outdoor use, the S1995 Cover is perfect solution for keeping the PA speaker going no matter what the weather dishes out. This custom-fit cover is made from water-repellant nylon fabric and sound transparent mesh. Rear access panels let you hook up cables and access controls with ease while keeping your gear dry.

Two large pockets; 12" L x 8" W x 1 1/2" D with a hook and loop fastener flap for microphone and cable storage.

MSRP \$199.00

TROUBLESHOOTING GUIDE

PROBLEM & ITEMS TO CHECK UNIT WILL NOT TURN ON

- Is unit plugged in?
- Are batteries charged?
- Is fuse blown?

UNIT OPERATES ON AC BUT NOT BATTERY

- Check battery terminals.

SOUND IS DISTORTED

- Turn down input source (such as keyboards, etc.) since the output of some devices may be too high.

SOUND IS MUFFLED

- Bass too high
- Treble too low

FEEDBACK: A LOUD SQUEALING, SHRILL OR HOWLING SOUND THAT IS SELF GENERATED

- Feedback occurs when a microphone is too close to the speaker or the microphone volume is too high, or the microphone is pointed towards the speaker. It is also caused by sound reflecting off hard surfaces.
- Reduce or eliminate Feedback by
 - Pointing the microphone in a different direction.
 - Keeping the microphone BEHIND the speakers.
 - Turn down the volume levels.

MICROPHONE SIGNAL IS WEAK

- If microphone has batteries, check batteries.
- Turn on phantom power if applicable.
- Check cables/connectors.

POWER IS ON, BUT NO SOUND

- Check volume levels for each channel and main volume.
- If using wireless, be sure receiver(s) and/or transmitter battery is installed and/or is on.
- If using "line insert", loop must be completed.

WIRELESS MIC DOES NOT WORK

- Check transmitter battery is alkaline and ensure transmitter is on.
- Does yellow "signal" LED light when transmitter is turned on?
- Are the transmitter and receiver on the same channel?

WIRELESS MIC CUTS IN AND OUT

- Is unit visible (line of sight) from user? If not, move unit into view when using wireless microphone.
- Does the yellow "signal" LED go out when signal drops out? Check battery in transmitter.

SW800 MAKES BUZZING NOISE

- Check cables – a damaged cable will cause this. Unplug cables one at a time until buzzing stops.
- Check for Ground loops – use a ground loop isolator where needed. Will not operate unless plugged into AC).

BATTERIES WILL NOT HOLD CHARGE

- Replace Batteries every 1-2 years.
- A full charge is best obtained when the unit is off and plugged into the AC outlet for several hours. After a year or two the battery may need to be replaced. Batteries are available from Amplivox.
- To replace the batteries use a Phillips screwdriver and take out the 7 screws from the battery cover on the control panel. Remove the foam spacer, set aside. Pull out the batteries to access the terminals.
- Carefully hold the battery with one hand while you remove the mating connector. Replace with new battery and push mating connector of battery wire onto the corresponding color/polarity. RED = POSITIVE, BLACK = NEGATIVE.
- Place the batteries back in the compartment. Replace the foam and screw on the cover.

NEED HELP? Call 800-267-5486

DISCLAIMER

AmpliVox Sound Systems, operates a policy of continuous development. AmpliVox reserves the right to make changes and improvements to any of the products described in this document without prior notice.

Under no circumstances shall AmpliVox be responsible for any loss of data or income or any special, incidental, consequential or indirect damages howsoever caused.

In some countries there may be some restrictions in using this equipment. Please check with your local radio frequency authorities.

WARRANTY

Limited Three (3) -Year Warranty

AmpliVox warrants this product to be free from defects in materials and workmanship (subject to the terms set forth below) for a period of three (3) years from the date of purchase ("Warranty Period"). **All accessories and the batteries are warrantied for 1 year.** Accessories are; wireless and wired microphones, receivers and transmitters, CD players, cassette players, and digital players.

During the Warranty Period, AmpliVox will repair or replace (at AmpliVox's discretion) this product or any defective parts ("Warranty Service").

Repair or replacement under the terms of this warranty does not give right to any extension or a new beginning of the period of warranty.

CLAIMS UNDER THE WARRANTY

To obtain Warranty Service, **contact AmpliVox (800-267-5486)** to be assigned a **Return Authorization number (RA#)**. After receiving a RA#, the defective unit is to be returned to AmpliVox in either its original packaging or packaging affording an equal degree of protection. You will bear the cost of shipping the product to AmpliVox. If the product is covered by the warranty, AmpliVox will bear the cost of shipping product back to you after the completion of service under this warranty.

Return shipping will be charged to you for products not covered by the warranty or requiring no warranty repair.

The following information must be presented to obtain Warranty Service: **(a)** the RA# must be clearly and legibility marked on the outside of shipping carton, **(b)** proof of purchase, which clearly indicates the name and address of the seller, the date of purchase and the product type, which is evidence that this product is within the Warranty Period. Please further include **(c)** your return address, **(d)** daytime telephone number, and **(e)** reason for return.

LIMITATION OF WARRANTY

This warranty is only valid for the original purchaser and will automatically terminate prior to expiration if this product is sold or otherwise transferred to another party. The warranty provided by AmpliVox in this statement applies only to products purchased for use, and not for resale. It does not apply to open box purchases, which are sold "as is" and without any warranty. Specifically exempt from warranty are limited-life consumable components subject to normal wear and tear, such as microphone windscreens, ear cushions, modular plugs, ear tips, decorative finishes, batteries, and other accessories. This warranty is invalid if the factory-applied serial number, date code label, or product label has been altered or removed from this product. This Warranty does not cover cosmetic damage or damage due to misuse, abuse, negligence, Acts of Nature, accident, disassembling or modification of, or to any part of, the product. This Warranty does not cover damage due to improper operation, maintenance or installation, or attempted repair by anyone other than AmpliVox. Any unauthorized repairs will void this warranty.

REPAIRS OR REPLACEMENTS AS PROVIDED UNDER THIS WARRANTY ARE THE EXCLUSIVE REMEDY OF THE CONSUMER. AMPLIVOX SHALL NOT BE LIABLE FOR ANY INCIDENTAL OR CONSEQUENTIAL DAMAGES FOR BREACH OF ANY EXPRESS OR IMPLIED WARRANTY ON THIS PRODUCT. EXCEPT TO THE EXTENT PROHIBITED BY LAW, THIS WARRANTY IS EXCLUSIVE AND IN LIEU OF ALL OTHER EXPRESS AND IMPLIED WARRANTIES WHAT SO EVER, INCLUDING BUT NOT LIMITED TO THE WARRANTY OF MERCHANTABILITY AND FITNESS FOR A PRACTICAL PURPOSE.

NOTE! This warranty gives you specific legal rights. You may have other rights which vary from location to location. Some jurisdictions do not allow the exclusion or limitation of incidental or consequential damages or implied warranties, so the above exclusions may not apply to you. This warranty does not affect your legal (statutory) rights under your applicable national or local laws.

"The Bluetooth® word mark and logos are registered trademarks owned by Bluetooth SIG, Inc. and any use of such marks by Amplivox Portable Sound Systems is under license. Other trademarks and trade names are those of their respective owners.



Dispose of the product according to local standards and regulations

AmpliVox • 3453 Commercial Ave., Northbrook, IL 60062 • Phone: (800)267-5486 • Fax: (800)267-5489 www.ampli.com

UPDATED DEC, 2021