



COLOR : Stainless Steel

- **Over the Counter Microwave Ovens** enable easy and affordable installation, including applications in corner cabinets, above islands, over food preparation areas and in nearly any wall cabinet. The OTC™ design saves valuable counter space and moves a step beyond other "built-in solutions" that require special kits and tools.
- **Clean and uncluttered design** with Auto-Touch® Control Panel located on the oven door; the controls are easy to reach.
- **Stainless Steel** with smooth glass window—elegant and practical.
- **Large 14 1/8-inch diameter Carousel® turntable**—the largest turntable of any microwave oven in its class—for added capacity and versatility.
- **Sensor Cook® Center** includes 11 Smart & Easy™ sensor settings for the most popular microwaved foods. No need to set times or power levels—and no guesswork!
- **Interactive Cooking System** with Custom Help™ includes options for English, Spanish or French.
- **Defrost Center** quickly defrosts meats and poultry by weight. Specific program for each category assures excellent, even results.
- **Keep Warm Plus** lets you keep hot food hot up to 30 minutes after cooking is finished with no loss of food quality.
- **Instant Action™ Keys** save time and make microwaving easy! Touch once for each serving—up to eight. Oven starts automatically.

# specifications

## R-1214 Over the Counter Microwave Oven

TYPE OF OVEN	Over the Counter
OVEN CAPACITY	1.5 cu. ft
COOKING UNIFORMITY	Carousel Turntable System: 14 1/8" diameter glass turntable
DISPLAY	7-digit, 2-color, lighted LCD with interactive word prompts
CONTROLS	Auto-Touch Controls on lower face of door
SMART AND EASY SENSOR	11 Sensor Settings
SPECIAL FEATURES	Interactive Cooking with Custom Help (English, Spanish, or French); Sensor Cook—11 foods; Reheat Sensor; Popcorn Sensor; Instant Action keys (up to 8 servings); Defrost Center; Keep Warm Plus; Hot Water setting; Minute Plus; Kitchen Timer; Clock; Child Lock; Demo Mode; 11 Variable Power levels; 4-Stage programming; Audible Signal Elimination; Informative Cooking Guide; Task and Accent lighting
DESIGN	Durable Stainless Steel with smooth glass window
OVEN INTERIOR	Acrylic painted interior with oven light
OUTPUT POWER	1100 watts
OUTSIDE DIMENSIONS (WxHxD)	23 7/8" x 14 1/16" x 15 9/16"
OVEN DIMENSIONS (WxHxD)	17 1/2" x 9 7/8" x 14 15/16"
APPROXIMATE WEIGHT	Net: 46 lb Shipping: 50 lb
AC LINE VOLTAGE	120 Volts, single phase, 60 Hz, AC only
AC POWER REQUIRED	1.53 kW, 13.0 amps
SAFETY COMPLIANCE	FCC, DHHS, UL listed
UPC CODE	R-1214: 074000611696 RK-OTC: 074000610392
OPTIONAL ACCESSORIES	RK-OTC120: Two brushed stainless steel accessory bars with eight custom "s" hooks, mounting posts and screws ready to mount.

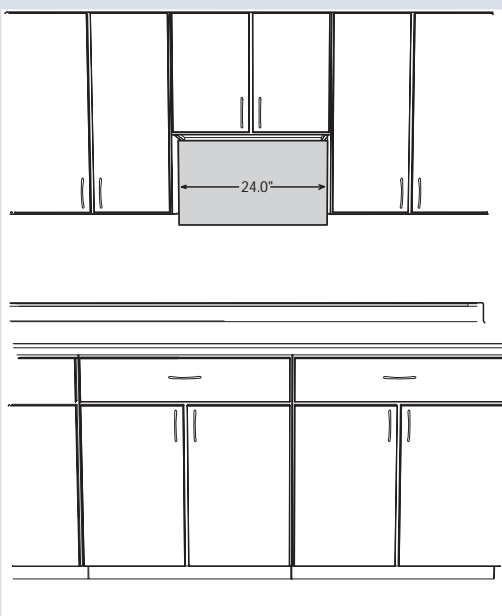

Each Sharp Over the Counter microwave oven can be used under standard 24-inch wide wall cabinets. A separate 15 amp. or greater electrical receptacle must be located in the cabinet directly above the microwave oven.

**Design and specifications subject to change without notification. Refer to operation manual for installation**

All Sharp Microwave Ovens require a minimum 15 amp circuit.

To receive the most current specifications, call Dimension Express at (702) 833-3600 from a fax machine. Enter code 9026 for a directory of Sharp microwave oven products.

Limited Warranty: 7 years on magnetron tube, 1 year on all other parts, 1 year on related labor with in-home service. See Operation Manual or your dealer for complete details.

Sharp Electronics Corporation  
Sharp Plaza, Mahwah, NJ 07430-2135  
For more information call: 1-800-BE-SHARP  
www.sharppusa.com

© 2003 Sharp Electronics Corporation

**SHARP®**