

# KVC30: 30" VENTILATION HOOD, CHIMNEY, 600 CFM

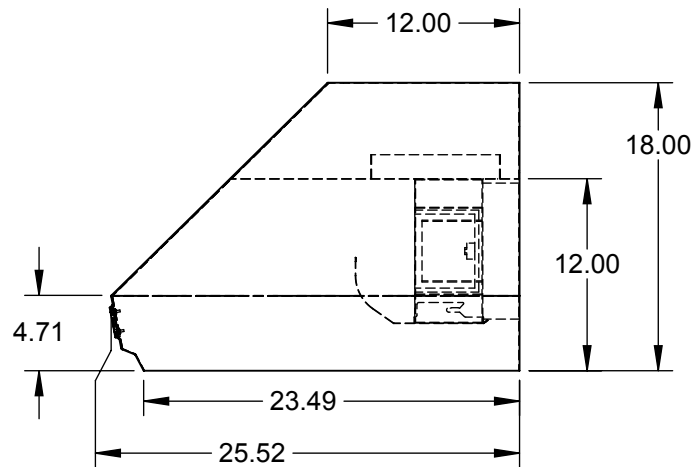
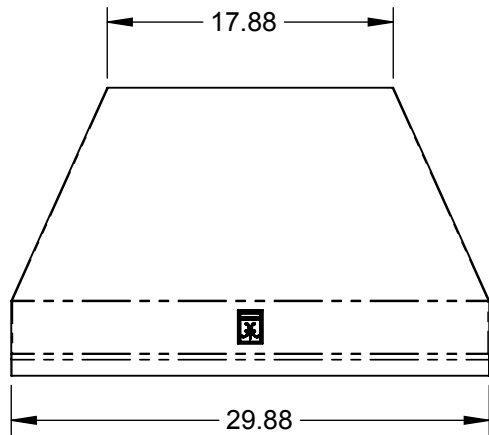
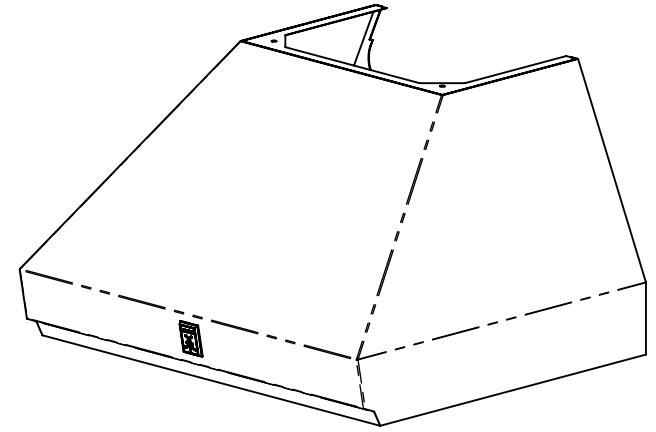
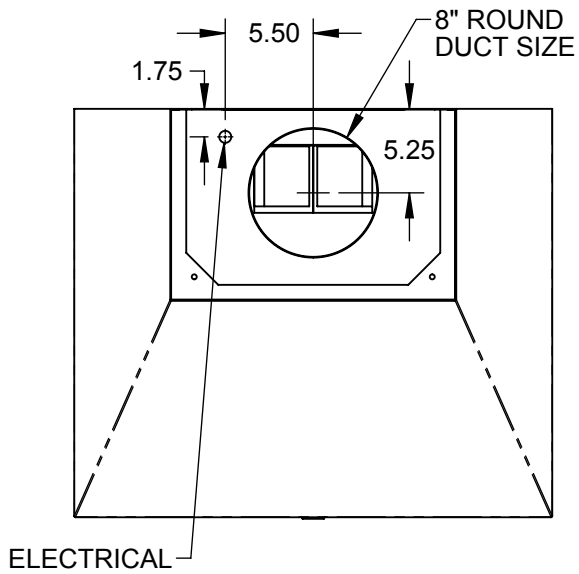

## SPECIFICATIONS:

WEIGHT: 40 LBS.  
VOLTAGE: 120V - 60Hz  
CURRENT: 4.0A  
CFM (EQUIV. CFM): 600 (900)  
NOISE: 6.5 Sones  
# OF LIGHTS: 2